

An aerial photograph of Belmont High School, showing its large, multi-winged building complex. The school is surrounded by a dense forest of trees. A parking lot with several cars is visible in the foreground. The entire image is overlaid with a semi-transparent blue filter.

01/ SITE STRATEGIES

BELMONT HIGH SCHOOL

2.1 MAJOR RENO / ADD.

- Keep pool & fieldhouse
- Maintains original building structure
- Same adjacency to pond

- High impact on students
- Longer construction schedule
- Footprint utilizes more land

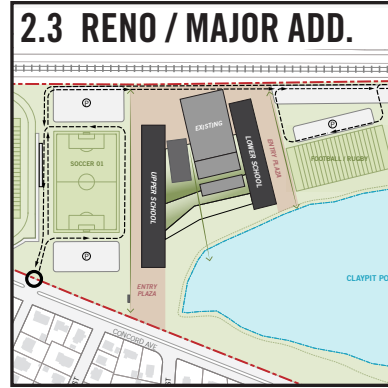

- Keep pool & fieldhouse
- Very compact
- Ideal site circulation
- Provides high amount of secure outdoor terraces
- Ideal solar orientation

- Separation of academic program
- Breaks up site / athletic field placement
- Too close to rail tracks

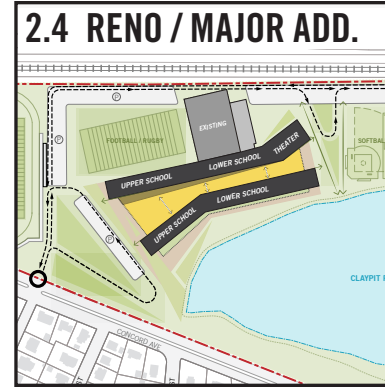

- Keep pool & fieldhouse
- Flexible Layout
- Ideal scale and separation from Concord Ave.
- Good adjacency to pond
- Ideal solar orientation
- Provides natural light

- Long circulation from East to West in building
- Limited presence on Concord Ave.

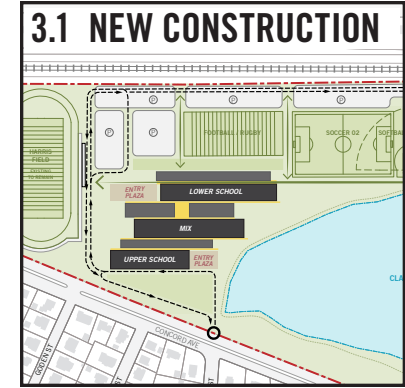

- Low Impact on students (new construction)
- Ideal athletic field / parking organization on site
- Short construction schedule (new construction)
- Ideal solar orientation
- Compact and Flexible

- Too close to Concord Ave. and residential area
- No pool included
- Traffic Loop is problematic

SITE STRATEGIES MATRIX

NOV. 30TH BHSBC COMMITTEE FEEDBACK

2.1 MAJOR RENO / ADD.

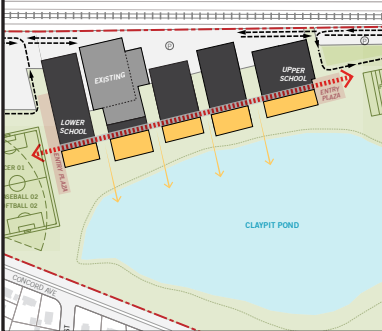

2.3 RENO / MAJOR ADD.



2.4 RENO / MAJOR ADD.



3.1 NEW CONSTRUCTION

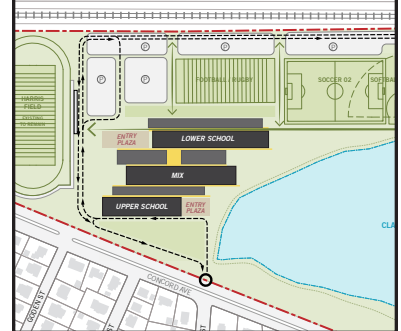

REVISED ALTERNATIVES / WHAT WE LEARNED

2.1 MAJOR RENO / ADD.

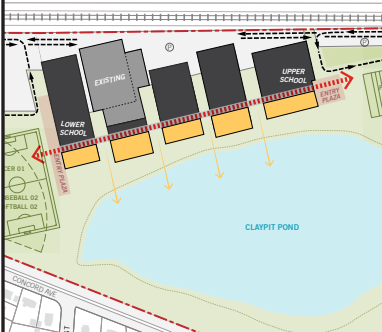

2.3A

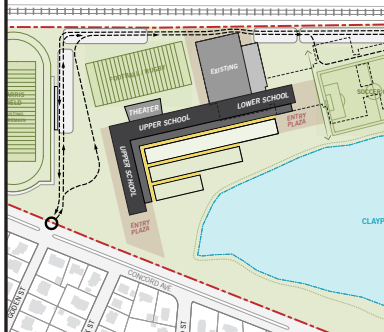

NEW

2.4A

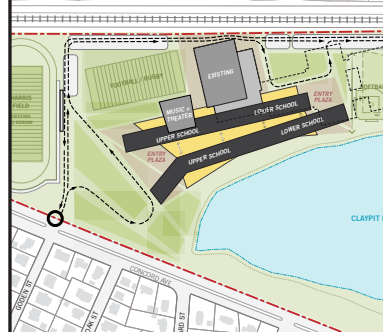

NEW

3.1A

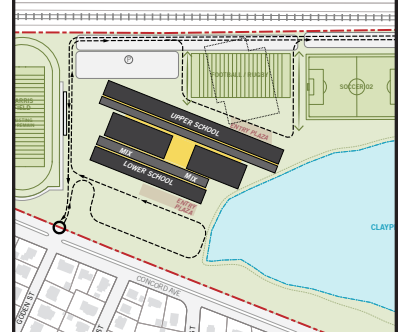

NEW

MAJOR RENOVATION-MINOR ADDITION / C.2.1



MAJOR RENOVATION-MINOR ADDITION / C.2.1



MAJOR RENOVATION-MINOR ADDITION / C.2.1



MAJOR RENOVATION-MINOR ADDITION / C.2.1



MAJOR RENOVATION-MINOR ADDITION / C.2.1

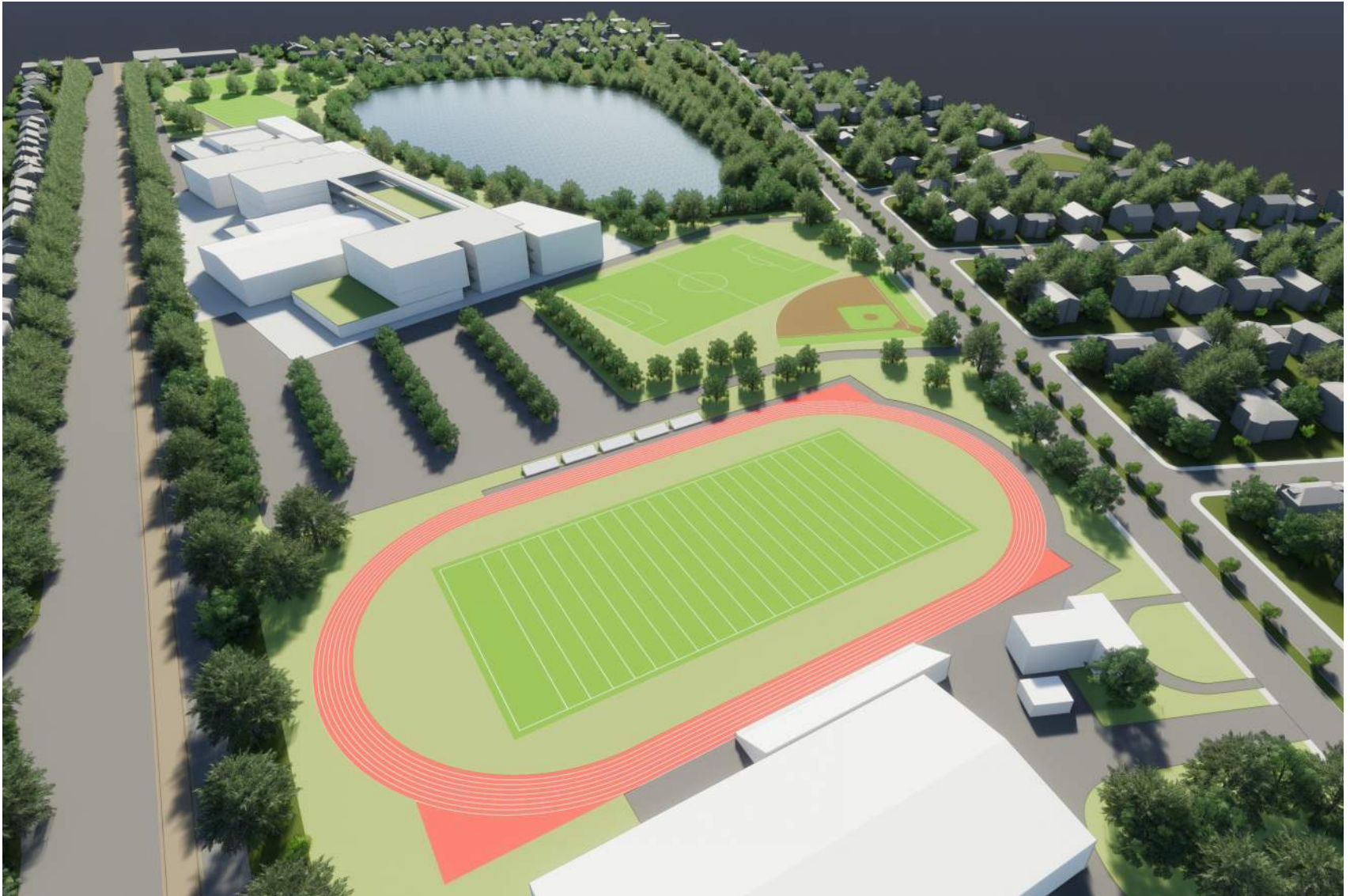

MAJOR RENOVATION-MINOR ADDITION / C.2.1

COMPOSITE CIRCULATION

SCHEME C2.1



MAJOR ADDITION-MINOR RENOVATION / C.2.3



MAJOR ADDITION-MINOR RENOVATION / C.2.3

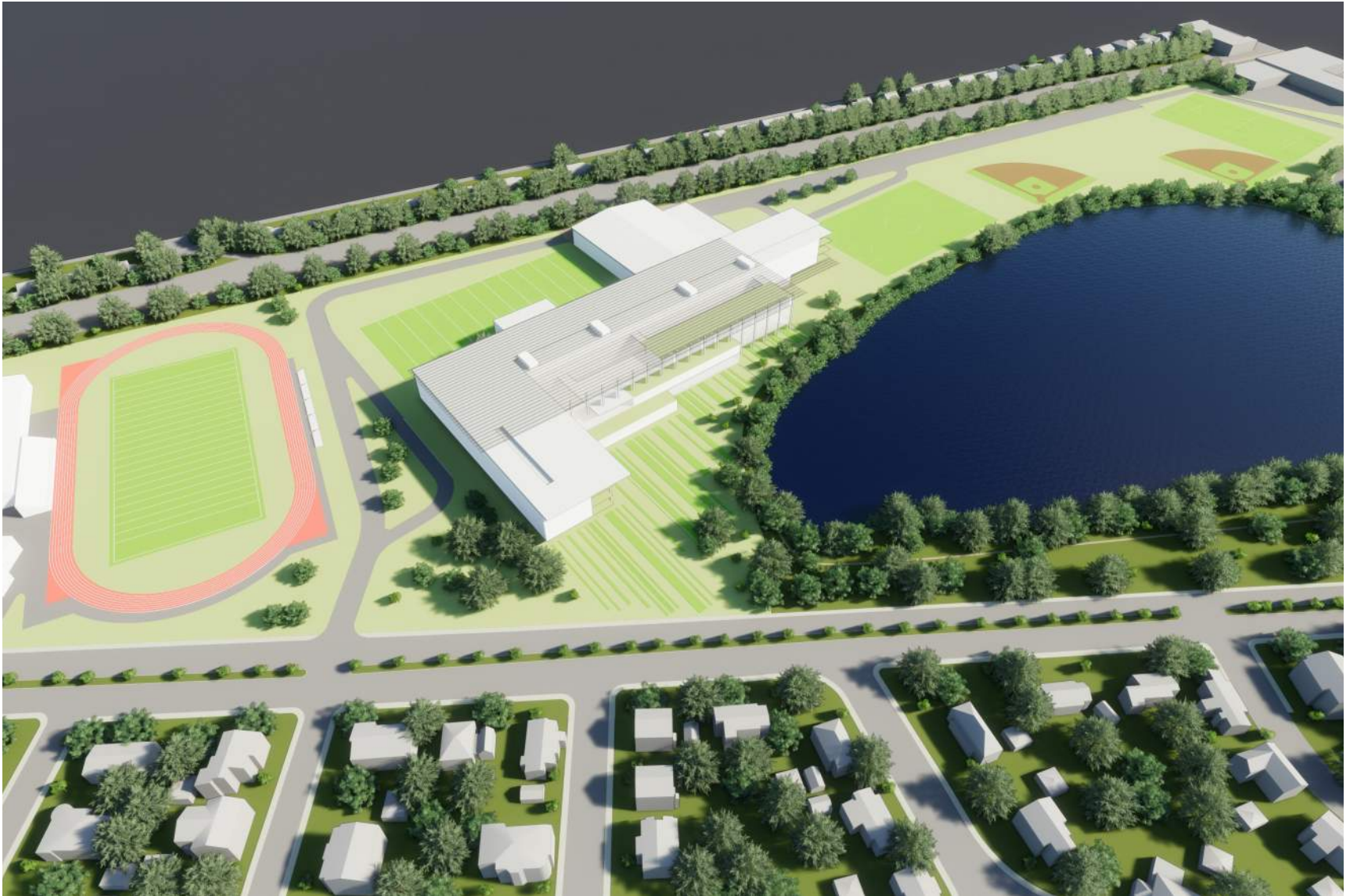

MAJOR ADDITION-MINOR RENOVATION / C.2.3



MAJOR ADDITION-MINOR RENOVATION / C.2.3



MAJOR ADDITION-MINOR RENOVATION / C.2.3

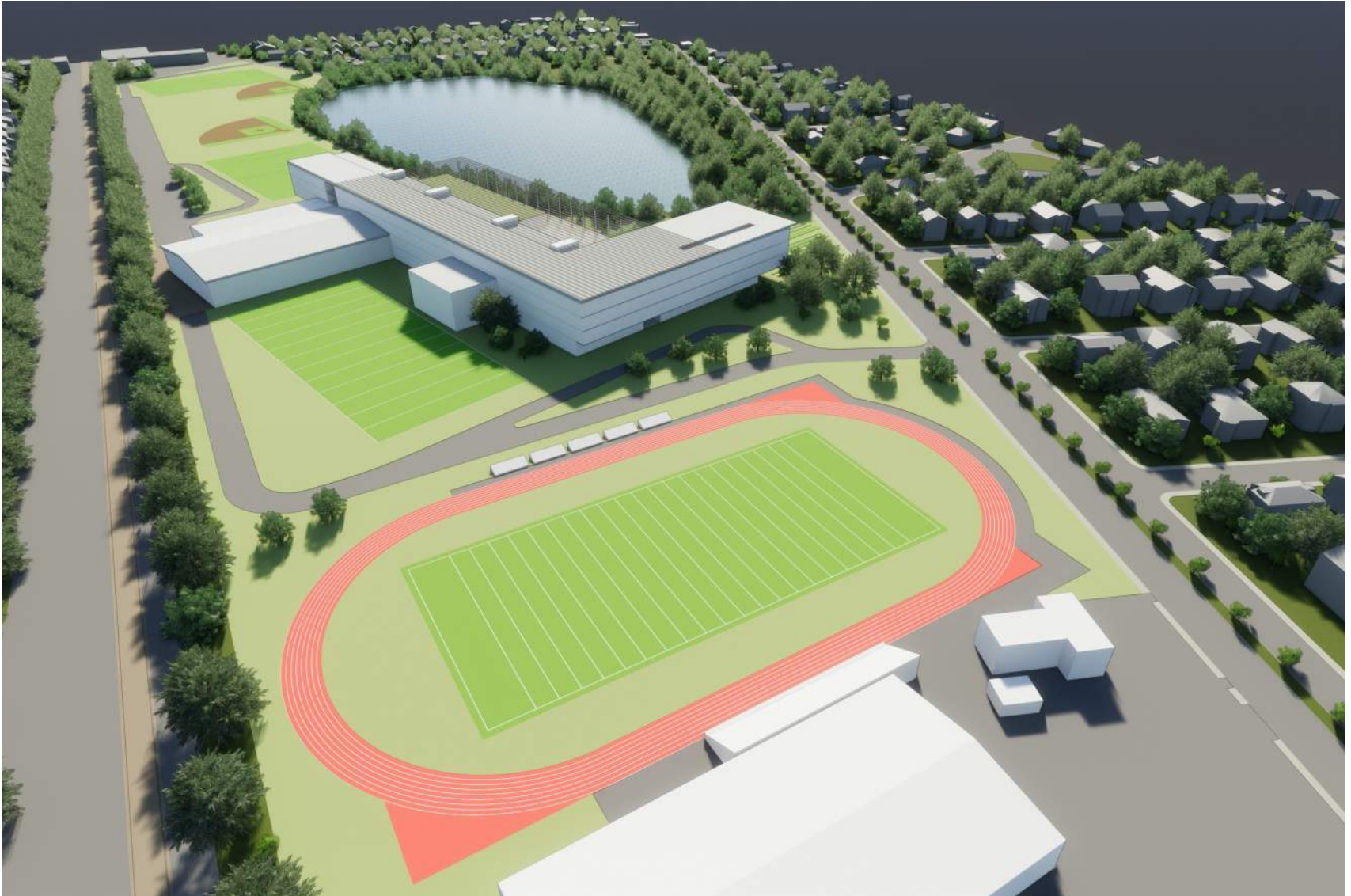

MAJOR ADDITION-MINOR RENOVATION / C.2.3

COMPOSITE CIRCULATION

SCHEME C2.3



MAJOR ADDITION-MINOR RENOVATION / C.2.4



MAJOR ADDITION-MINOR RENOVATION / C.2.4

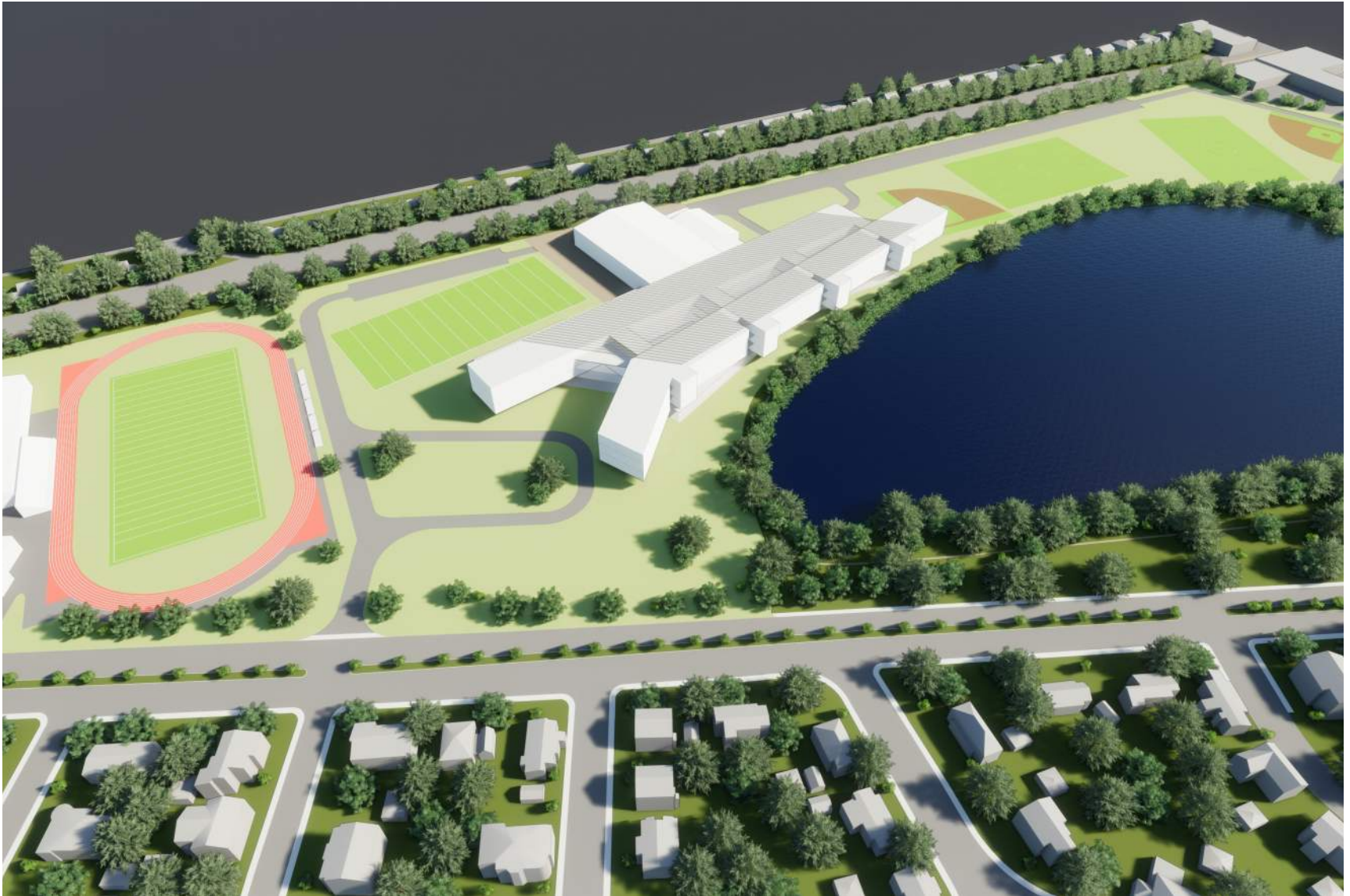

MAJOR ADDITION-MINOR RENOVATION / C.2.4

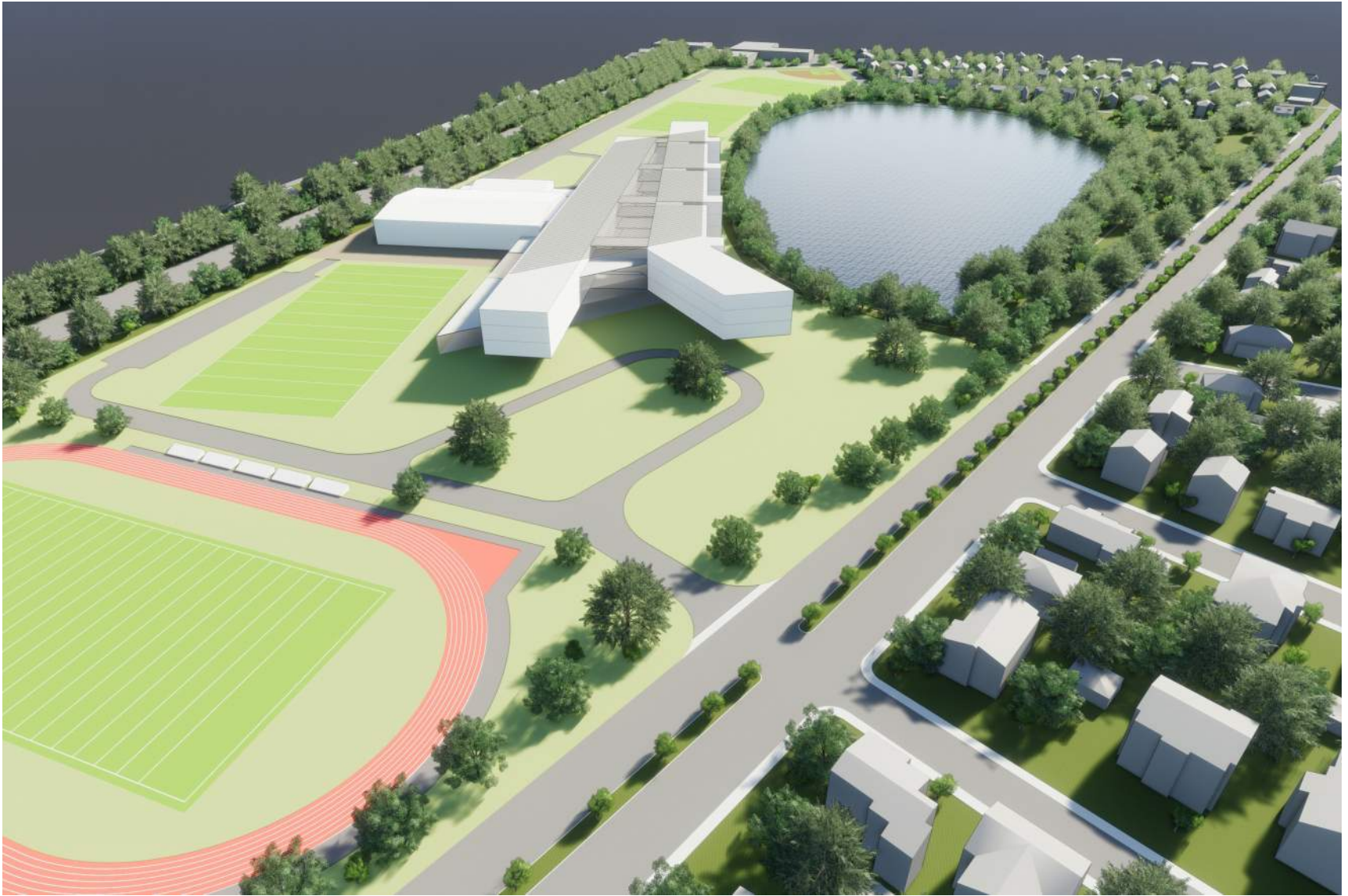

MAJOR ADDITION-MINOR RENOVATION / C.2.4



MAJOR ADDITION-MINOR RENOVATION / C.2.4

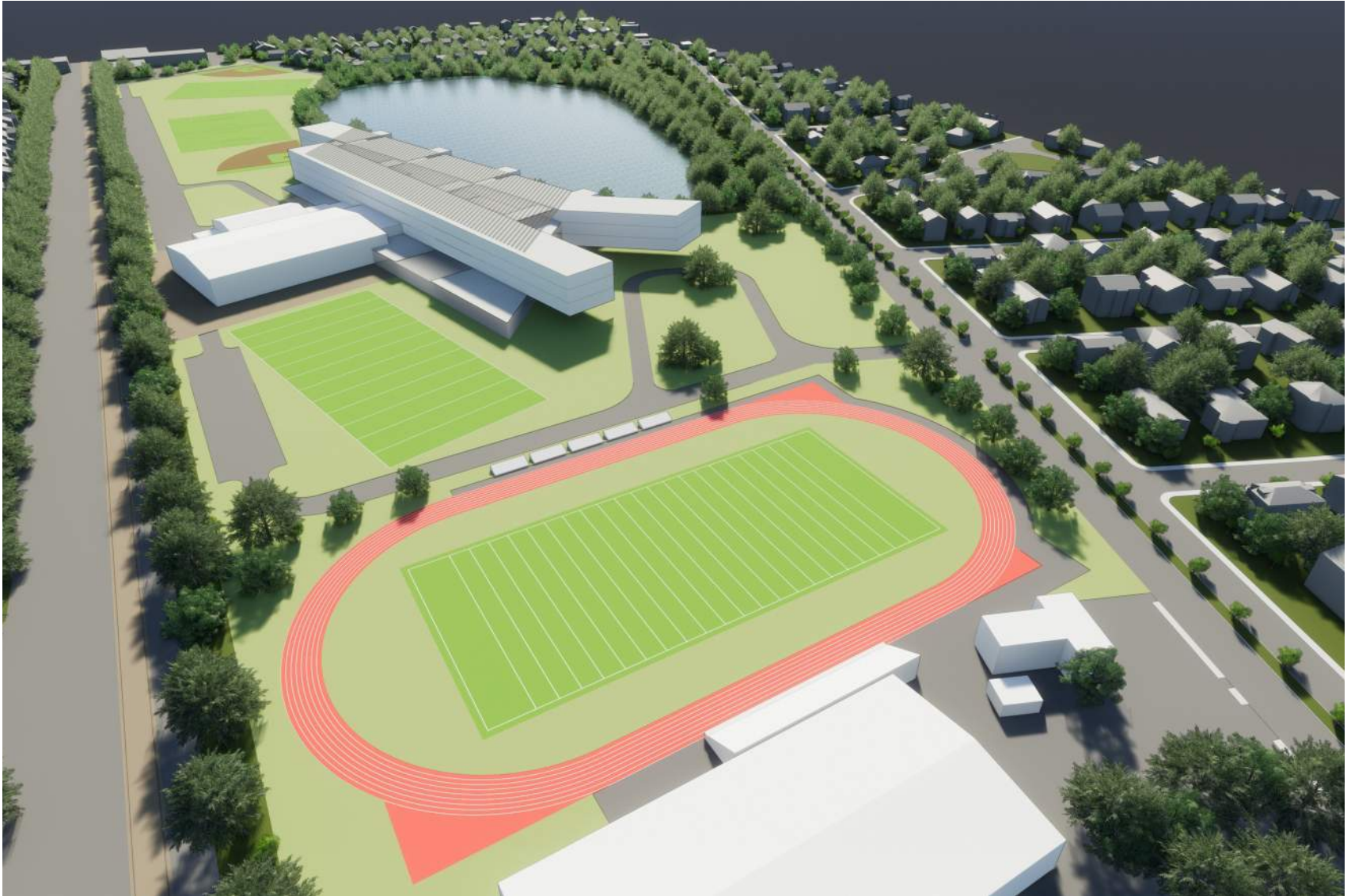

MAJOR ADDITION-MINOR RENOVATION / C.2.4

COMPOSITE CIRCULATION

SCHEME C2.4

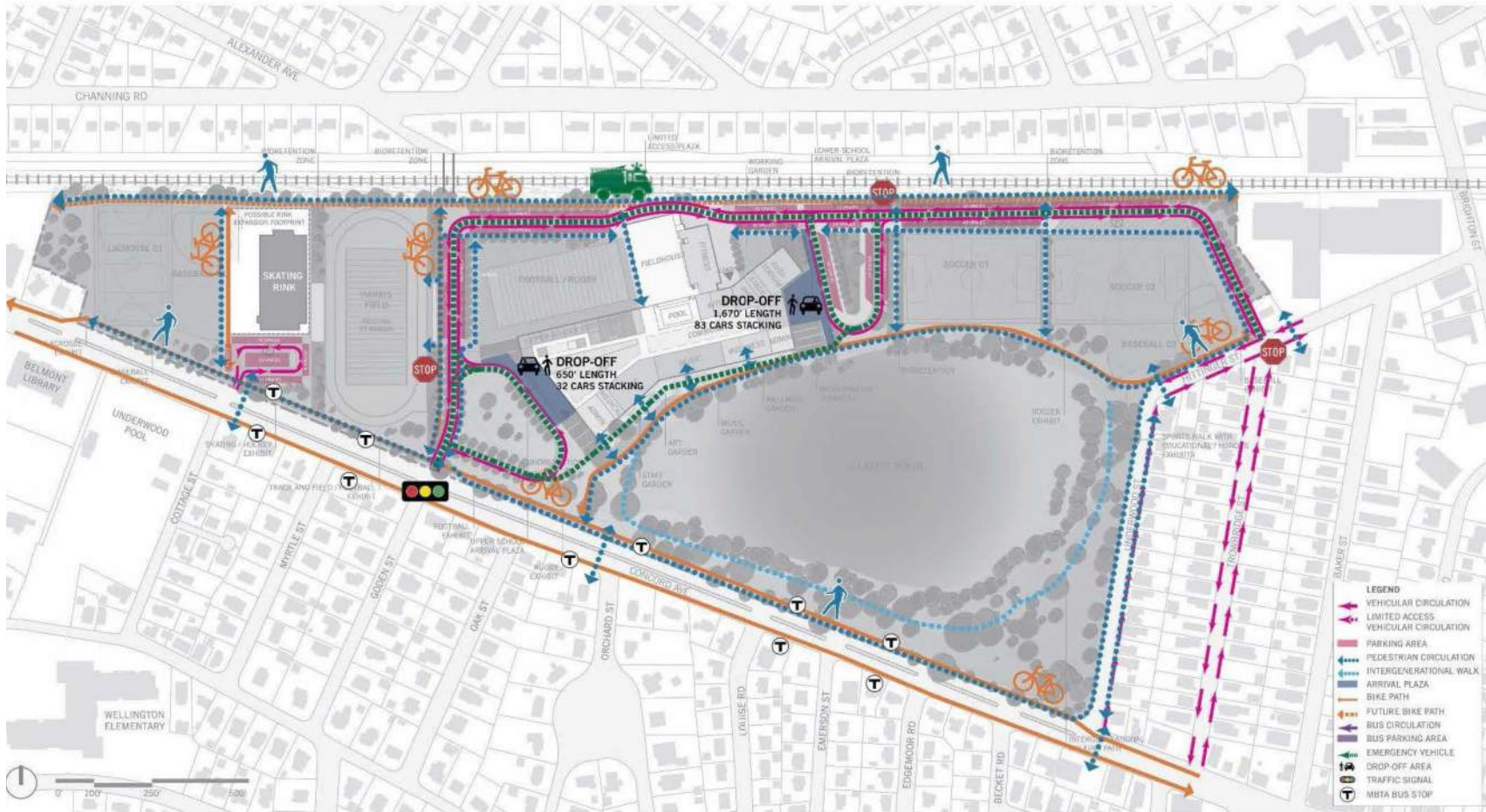

NEW CONSTRUCTION / C.3.1



NEW CONSTRUCTION / C.3.1

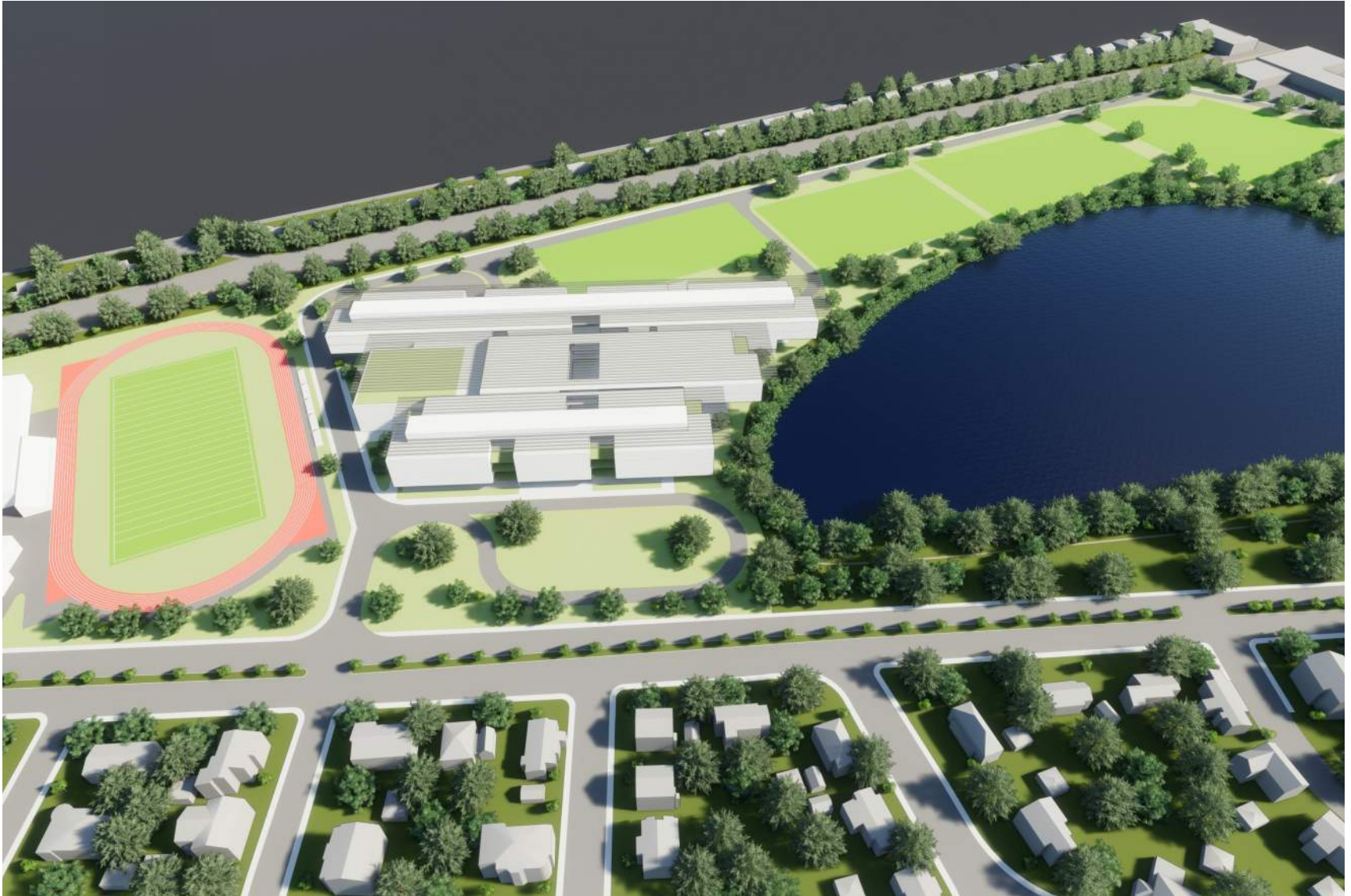

NEW CONSTRUCTION / C.3.1

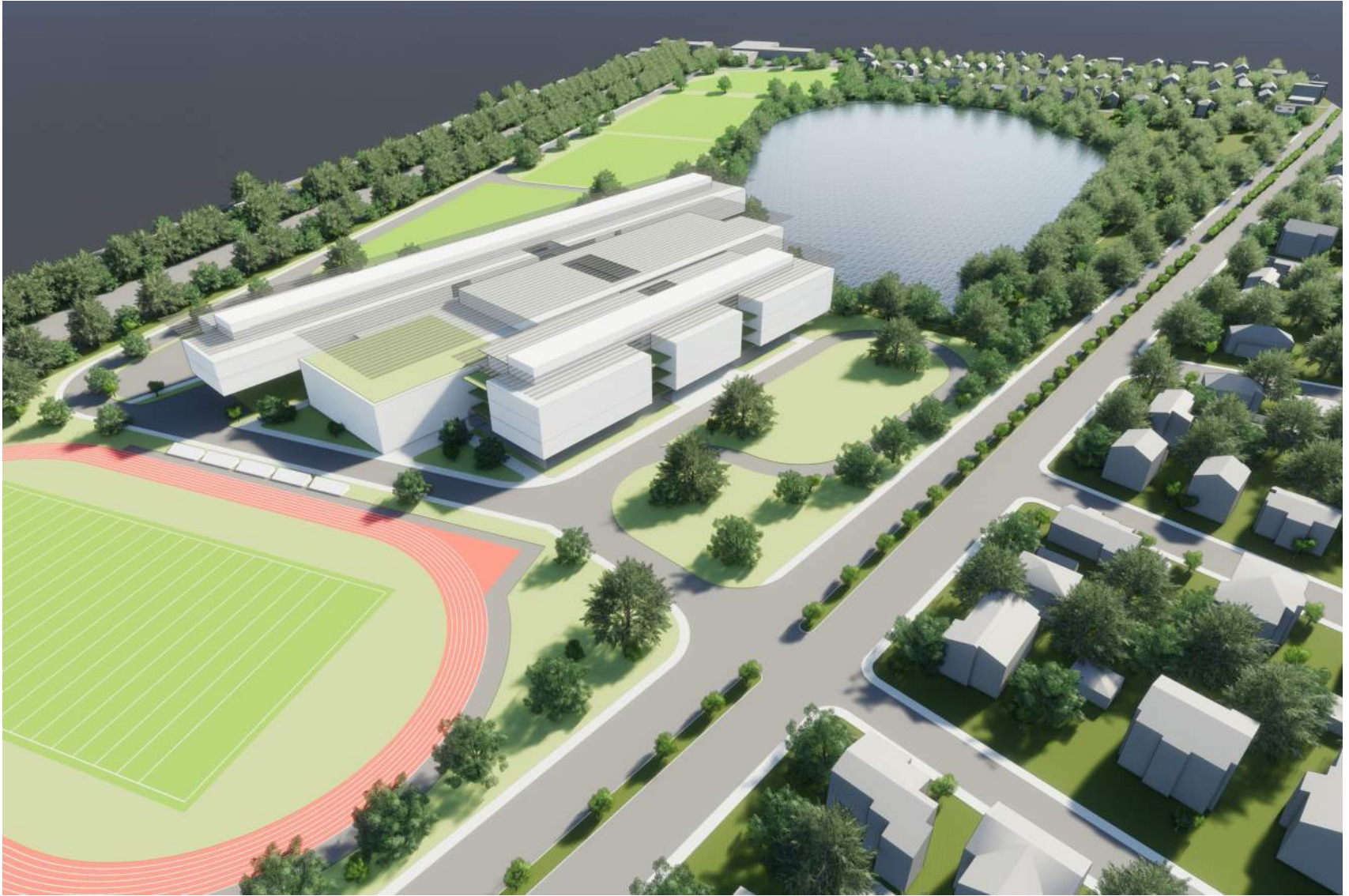

NEW CONSTRUCTION / C.3.1



NEW CONSTRUCTION / C.3.1



NEW CONSTRUCTION / C.3.1



NEW CONSTRUCTION / C.3.1

COMPOSITE CIRCULATION

SCHEME C3.1

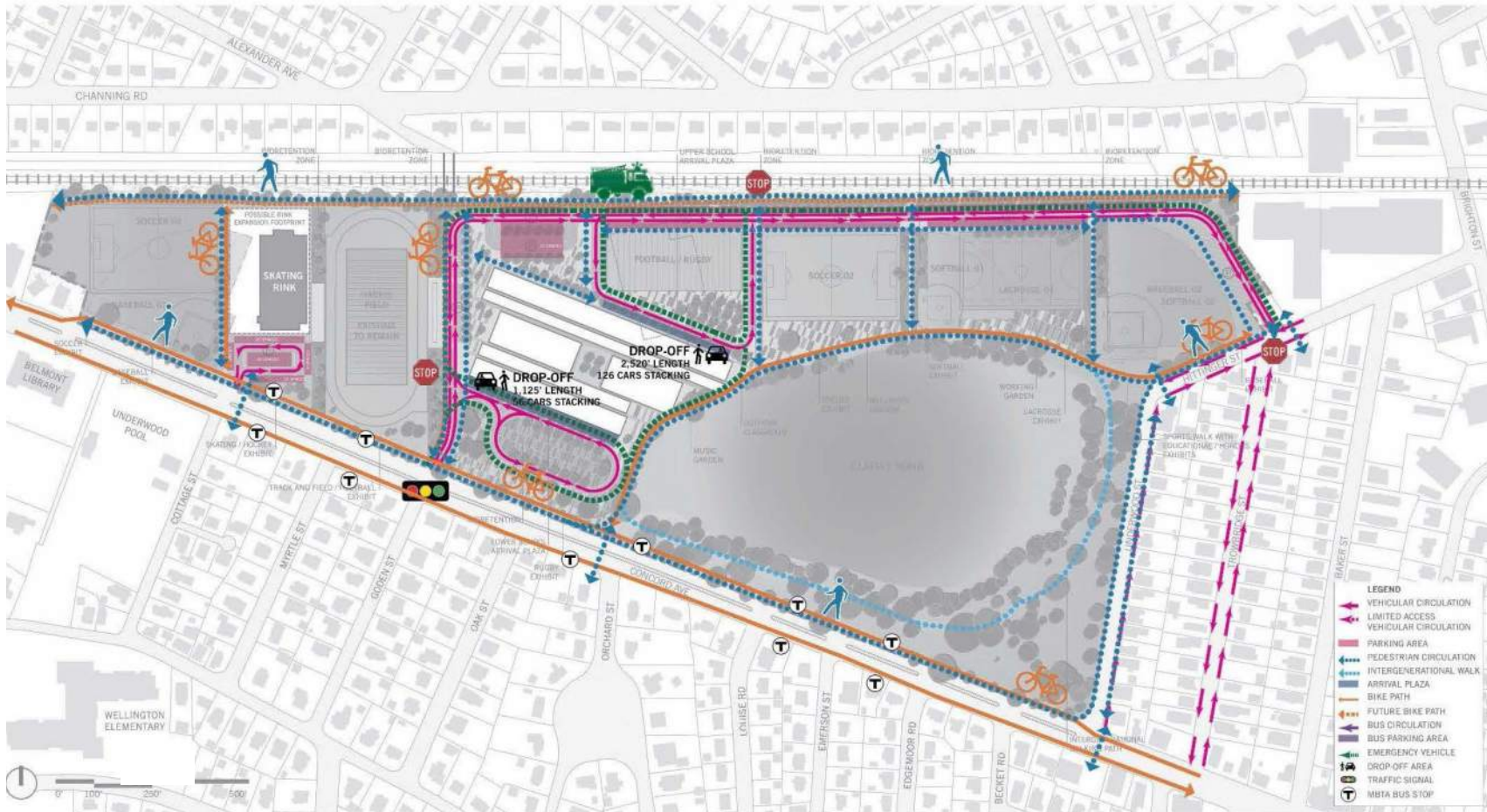

An aerial photograph of Belmont High School, a large, modern educational building with a complex, multi-winged structure. The school is surrounded by a dense forest of trees. In the foreground, there is a parking lot and a road with a crosswalk. The entire image is overlaid with a semi-transparent blue filter.

02/ INTERIOR STRATEGIES

BELMONT HIGH SCHOOL

MAJOR RENOVATION-MINOR ADDITION / C.2.1



MAJOR RENOVATION-MINOR ADDITION / C.2.1



LEVEL 01

MAJOR RENOVATION-MINOR ADDITION / C.2.1



LEVEL 02

MAJOR RENOVATION-MINOR ADDITION / C.2.1



LEVEL 03

MAJOR RENOVATION-MINOR ADDITION / C.2.1



LEVEL 04

MAJOR ADDITION-MINOR RENOVATION / C.2.3



MAJOR ADDITION-MINOR RENOVATION / C.2.3



LEVEL 01

The site plan illustrates the layout of Harris Field and the adjacent school building. The plan includes the following labeled areas and rooms:

- Harris Field:** Labeled "HARRIS FIELD" and "EXISTING TO REMAIN".
- Parking Lot:** A large rectangular area at the top of the plan.
- School Building:** A complex of rooms including:
 - UPPER SCHOOL TEAM
 - SCIENCE
 - MEDIA
 - ROBOT MAKER
 - VIDEO
 - ART
 - LOWER SCHOOL TEAM
 - AUDITORIUM
 - STAGE
 - BLACK BOX
 - PE MULTI-PURPOSE
 - GIRLS LOCKER
 - EXIST. POOL
- Fieldhouse:** A large green area on the right labeled "EXIST. FIELDHOUSE".
- Other Features:** A road and a fence line are shown at the bottom of the plan.

BUILDING COMMITTEE MEETING / JANUARY 16, 2018

MAJOR ADDITION-MINOR RENOVATION / C.2.3

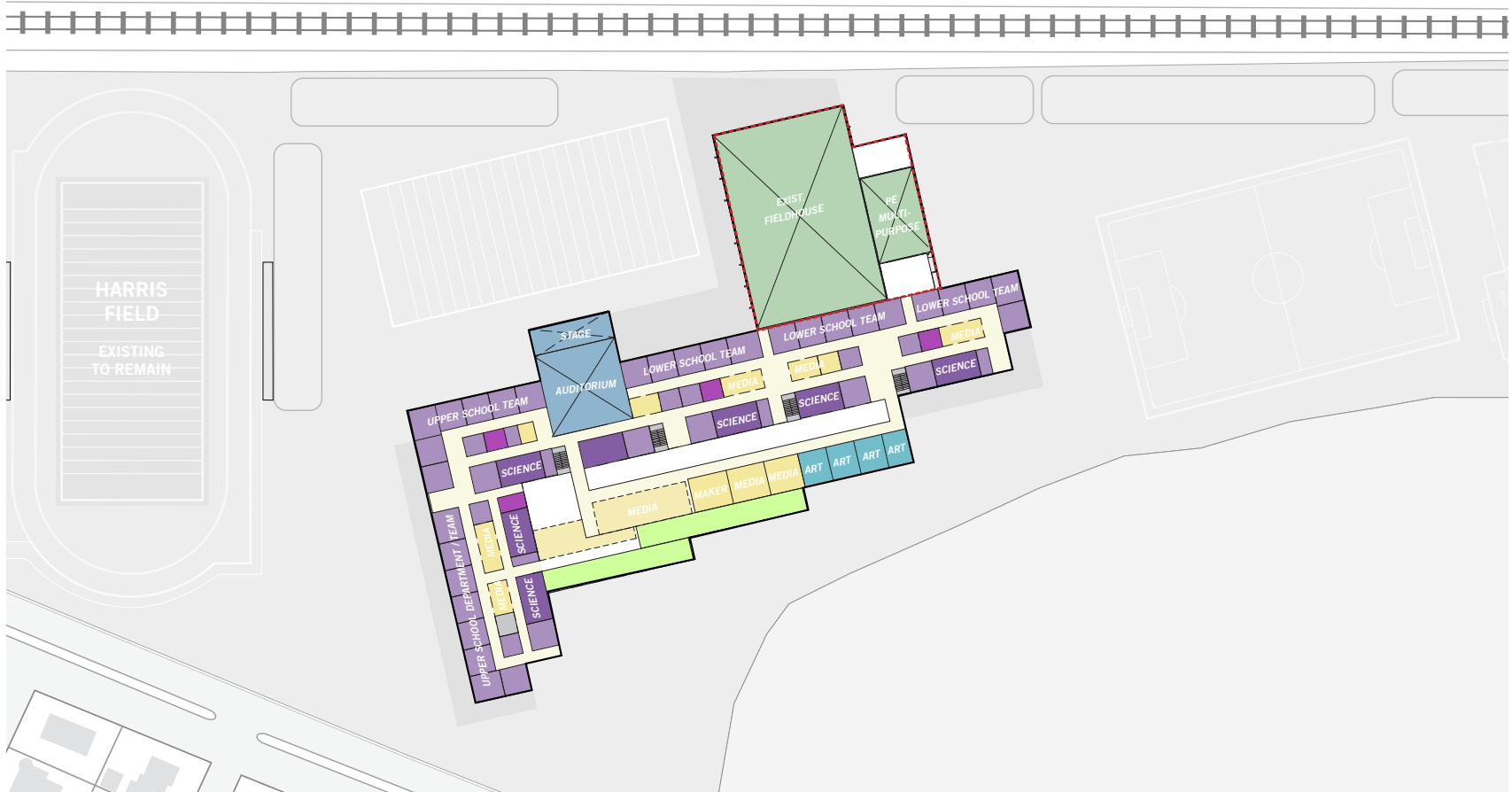

LEVEL 03

MAJOR ADDITION-MINOR RENOVATION / C.2.3

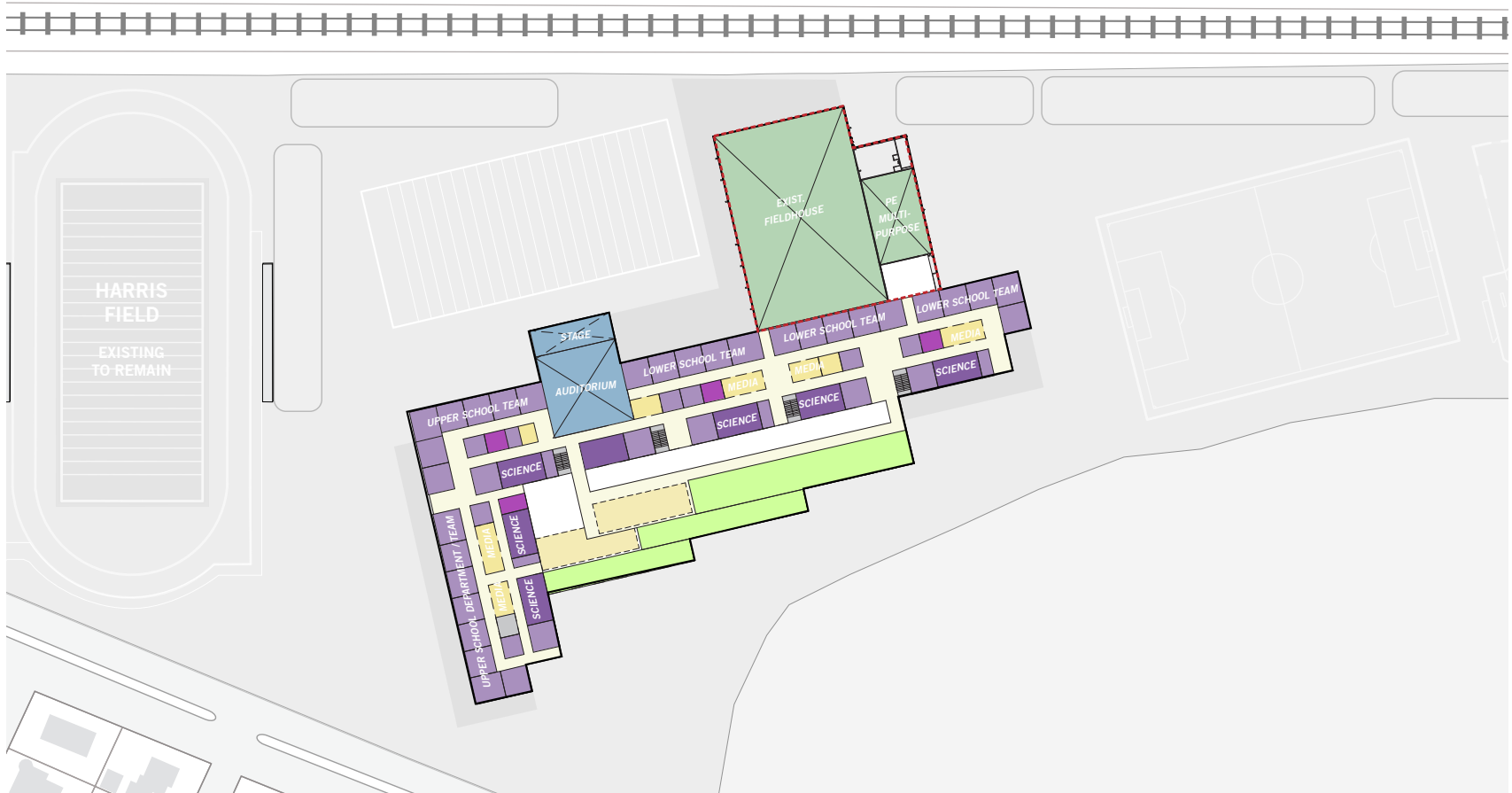

LEVEL 04

MAJOR ADDITION-MINOR RENOVATION / C.2.4



MAJOR ADDITION-MINOR RENOVATION / C.2.4



LEVEL 01

MAJOR ADDITION-MINOR RENOVATION / C.2.4

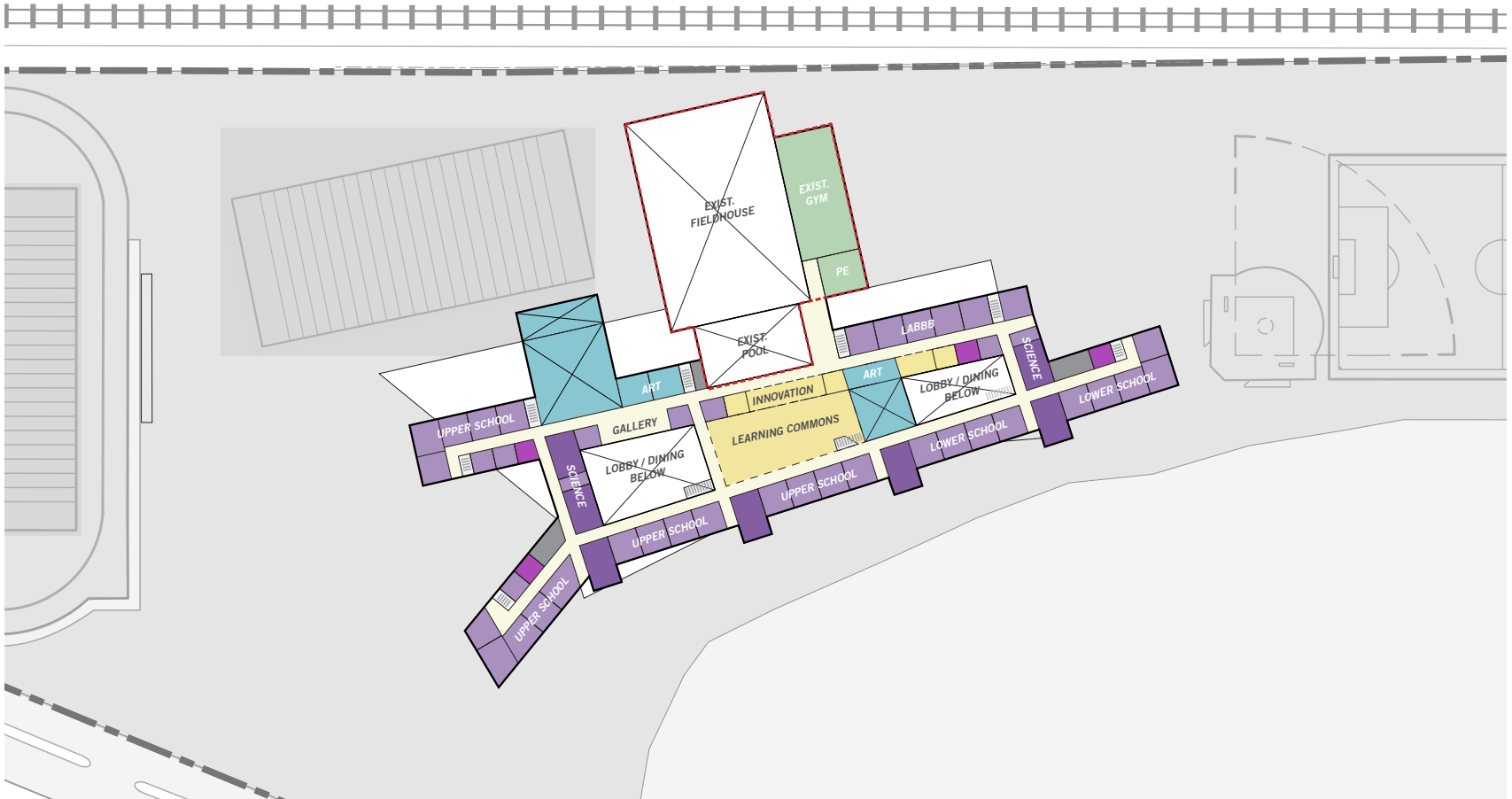

LEVEL 02

MAJOR ADDITION-MINOR RENOVATION / C.2.4

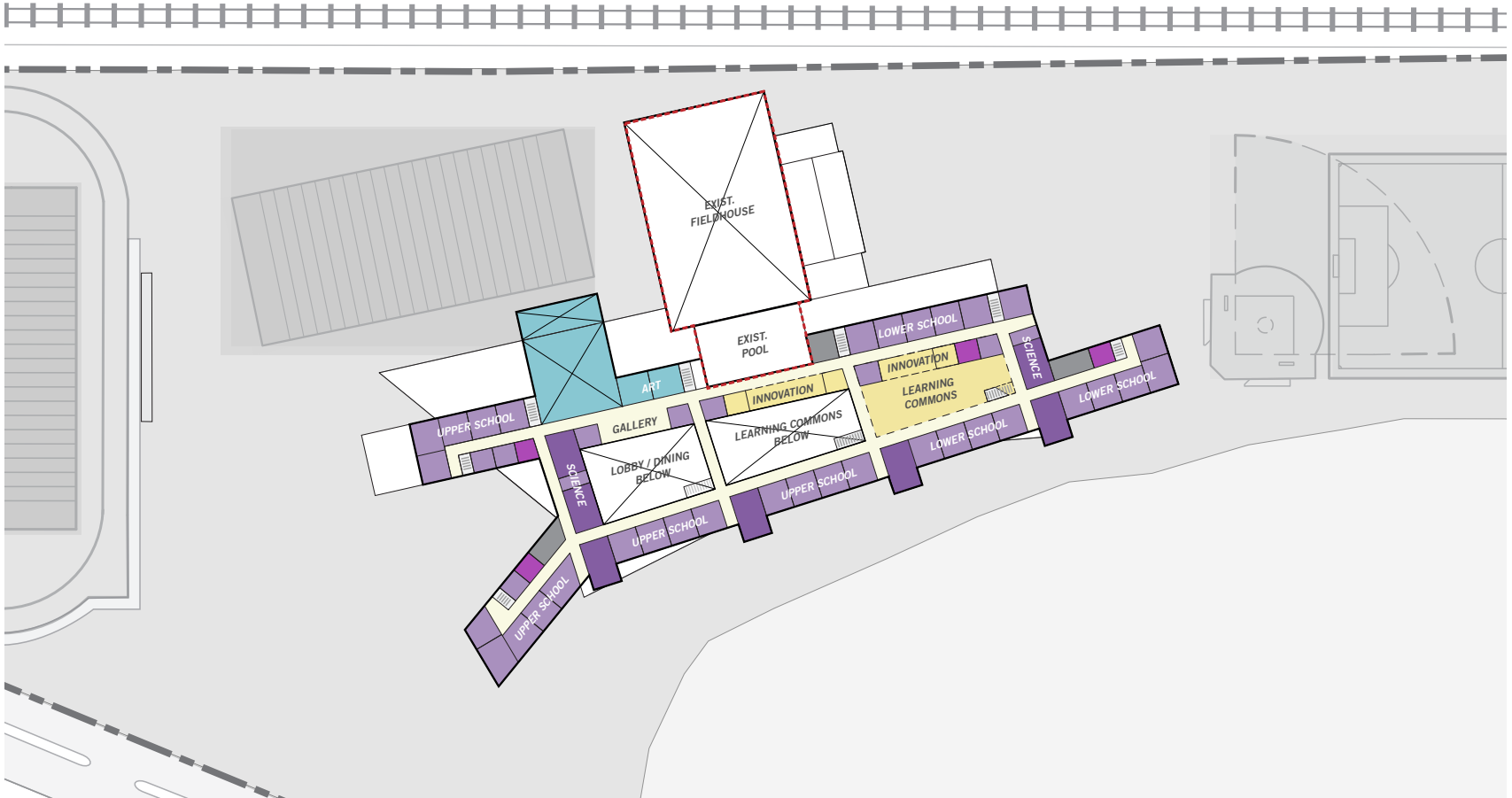

LEVEL 03

MAJOR ADDITION-MINOR RENOVATION / C.2.4

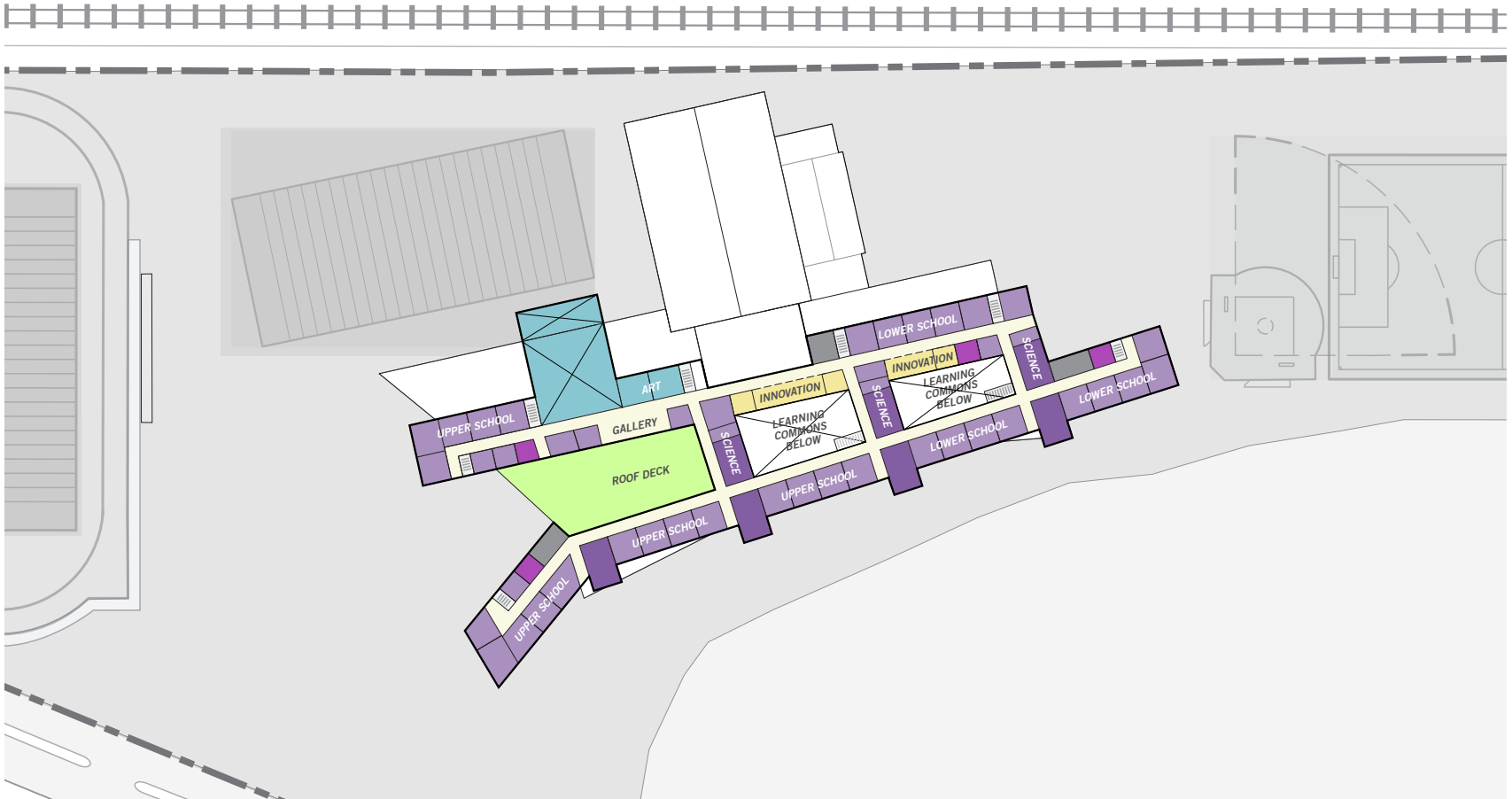

LEVEL 04

NEW CONSTRUCTION / C.3.1



NEW CONSTRUCTION / C.3.1



CLAYPIT P

LEVEL 01

NEW CONSTRUCTION / C.3.1



LEVEL 02

NEW CONSTRUCTION / C.3.1

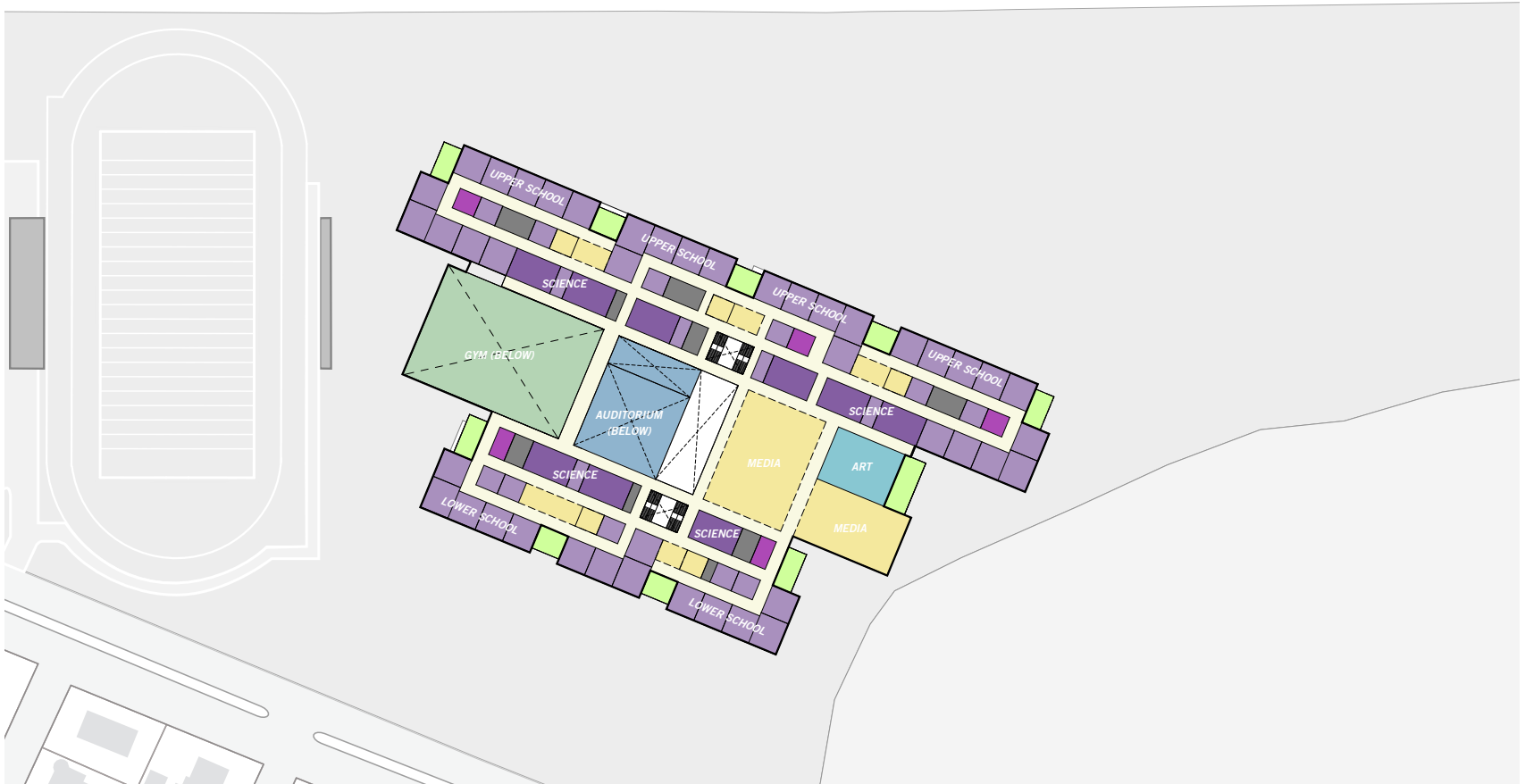

LEVEL 03

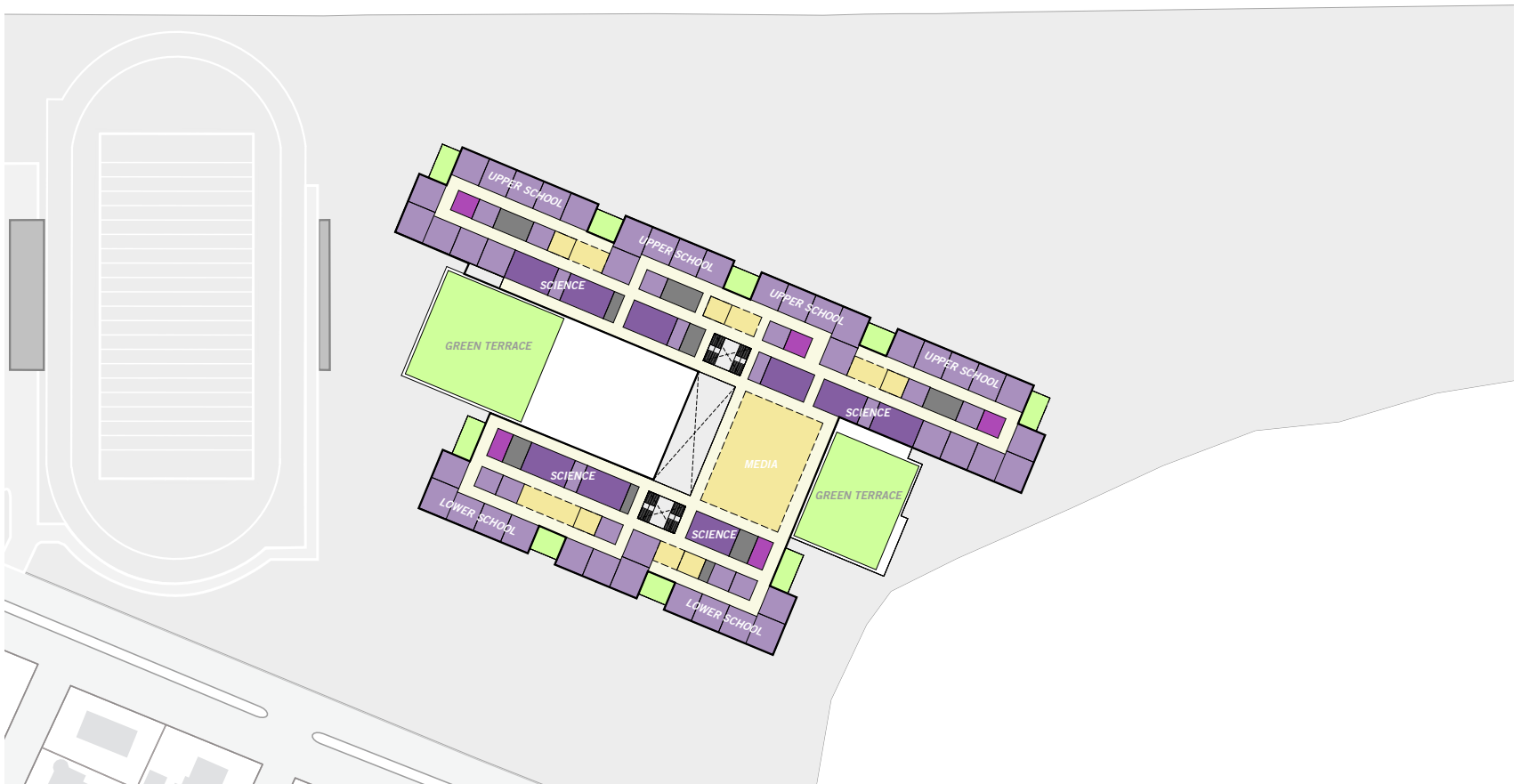

LEVEL 04

IMPLEMENTATION MEASURES FOR ALL OPTIONS

- 1. Site access at Concord & Goden with a signal will:**
 - a) Reduce queues on Goden
 - b) Eliminate u-turns on Concord
 - c) Improve overall traffic safety
 - d) Make walking to school safer
- 2. Two full-access site driveways will:**
 - a) Distribute traffic more evenly to reduce queues
 - b) Providing more circulation options
 - c) Improve fire/safety access
- 3. Providing drop-off loops internal to the site will prevent any queues from spilling onto neighboring streets**
- 4. Walking & transit access will be greatly enhanced with:**
 - a) A new walk/bike only gateway on Concord
 - b) The new signal at Goden
 - c) An improved walk/bike entry at Underwood & Hittinger
- 5. Biking access will be greatly enhanced with:**
 - a) Above improvements at Condord, Goden, and Underwood/Hittinger
 - b) New connections to the future multi-use path
 - c) Cross-campus bike path
- 6. Adding on-site parking near the skating rink/stadium will mitigate gameday spillover on residential streets**
- 7. Shorter delay and queues at key intersections:** Concord/Goden, Concord/Underwood, Underwood/Hittinger
- 8. Neutral impacts to Hittinger & Brighton**
- 9. Enhanced emergency vehicle circulation**

Summary

- Multiple access points for all travelers & needs disperses traffic & eliminates queue impacts
 - Traffic impacts on surrounding streets greatly reduced
 - New connections for walkers & bikers greatly improves safety
 - Distributed parking accommodates campus users better & minimizes spillover
-
1. Site access at Concord & Goden with a signal
 2. Two full-access site driveways
 3. Providing drop-off loops internal to the site
 4. Walking & transit access enhancements
 5. Biking access greatly enhanced
 6. Adding on-site parking near the skating rink/stadium

- PERKINS+WILL