

# FORM B – BUILDING

Assessor's Number USGS Quad Area(s) Form Number

MASSACHUSETTS HISTORICAL COMMISSION  
MASSACHUSETTS ARCHIVES BUILDING  
220 MORRISSEY BOULEVARD  
BOSTON, MASSACHUSETTS 02125

58-16	Boston North	BB	BLM. 150
-------	--------------	----	----------

**Town/City:** Belmont

**Place:** (*neighborhood or village*):  
Juniper Hill

**Address:** 259 Somerset Street

**Historic Name:** Greenough Gardener's House

**Uses:** Present: single family dwelling

Original: single family dwelling

**Date of Construction:** 1935

**Source:** building permit

**Style/Form:** Colonial Revival (Cape Cod)

**Architect/Builder:** McLaughlin & Burr, architects

**Exterior Material:**

Foundation: concrete block

Wall/Trim: wood shingles

Roof: asphalt shingle

**Outbuildings/Secondary Structures:**  
none

**Major Alterations** (*with dates*):

2012 – solar panels

**Condition:** good

**Moved:** no  yes  **Date:**

**Acreage:** 12,032 SF

**Setting:** rural setting, corner of Juniper Road and Somerset Street

## Photograph



## Locus Map (north at top)

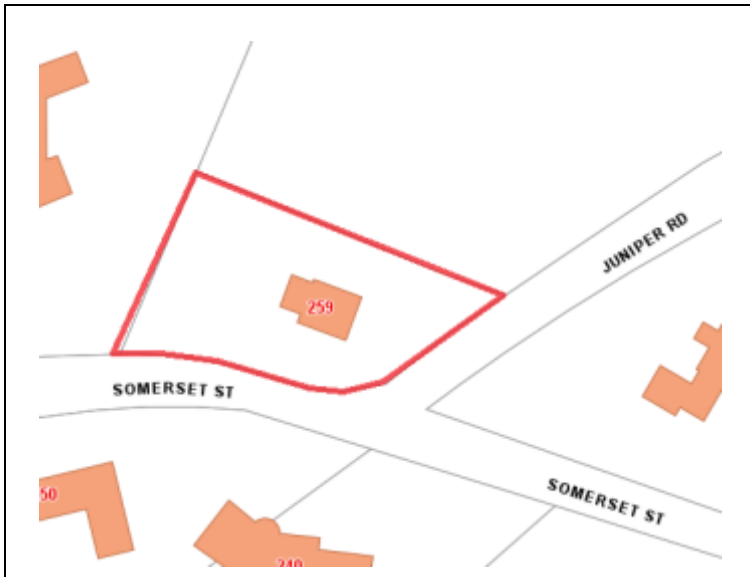

**Recorded by:** Lisa Mausolf

**Organization:** Belmont Historic District Commission

**Date** (*month / year*): July 2014

# INVENTORY FORM B CONTINUATION SHEET

BELMONT

259 SOMERSET ROAD

MASSACHUSETTS HISTORICAL COMMISSION

220 MORRISSEY BOULEVARD, BOSTON, MASSACHUSETTS 02125

Area(s) Form No.

BB

BLM.150

Recommended for listing in the National Register of Historic Places.

*If checked, you must attach a completed National Register Criteria Statement form.*

## ARCHITECTURAL DESCRIPTION:

*Describe architectural features. Evaluate the characteristics of this building in terms of other buildings within the community.*

The house at 259 Somerset Road is a 1 ½-story, three-quarter Cape Cod dwelling constructed in 1935 for the gardener of the estate at 10 Juniper Road. The house is set on a concrete foundation and is clad in wood shingles. The asphalt-shingled roof has a central brick chimney, shallow cornice returns and two gable dormers on the front slope. Solar panels were added in 2012. The off-center entrance is framed by simple pilasters and capped by an entablature lintel. Windows contain 6/6 sash and there is a high kneewall area above the windows. A lower, single-story wing extends to the west and includes a single car garage and an enclosed porch.

## HISTORICAL NARRATIVE

*Discuss the history of the building. Explain its associations with local (or state) history. Include uses of the building, and the role(s) the owners/occupants played within the community.*

According to town building records, this house was constructed in 1935 as an outbuilding on the property then owned by Mrs. Chester Greenough (Ruth Hornblower Atkins Greenough Churchill) who lived at 10 Juniper Road. The estimated cost of the house was \$7,000 and it was designed by architects McLaughlin & Burr. James McLaughlin and G. Houston Burr formed their partnership in 1920 and remained active into the 1950s. The MACRIS database includes over thirty schools built to their designs including Wellington High School (1917) and Chenery Middle School (1924) in Belmont. In 1941 they designed a Parish House addition for All Saints Episcopal Church. They also designed commercial and residential buildings.

The house appears to have been constructed as a dwelling for the estate gardener. William Picthall was living here in 1937 and 1940. He was born in England and lived here with his wife Edith. By 1944 Paul Merz (1897-1969) who was born in Germany was in residence. He also worked as a gardener on the Churchill Estate and was still living here in 1955.

The property was conveyed to the Massachusetts Audubon Society in 1990 and is part of the Habitat Education Center.

## BIBLIOGRAPHY and/or REFERENCES

Ancestry.com

Back Bay Houses [information on McLaughlin & Burr] <https://backbayhouses.org/mclaughlin-and-burr/>

Beers, F.W. and Co. *County Atlas of Middlesex, Massachusetts*. New York: Beers, Ellis, and Soule, 1875.

*Belmont, Massachusetts: The Architecture and Development of The Town of Homes*. Belmont: Historic District Commission, 1984.

Belmont Directories, various years.

Betts, Richard B. *The Streets of Belmont and How they Were Named* (2<sup>nd</sup> edition). Belmont: Belmont Historical Society, 2012.

Massachusetts Historical Commission. MACRIS database.

Middlesex County Registry of Deeds, Cambridge, MA

Sanborn Insurance Maps, 1915, 1922, 1931, 1949.

Stadley, George W. *Atlas of the Towns of Watertown, Belmont, Arlington, and Lexington*. 1898.

Town of Belmont, Building Department files.

U.S. Census, various years.

Walker, G.H. *Atlas of Middlesex County, Massachusetts*. Boston: G.H. Walker, 1889.