

FORM B – BUILDING

Assessor's Number USGS Quad Area(s) Form Number

MASSACHUSETTS HISTORICAL COMMISSION
MASSACHUSETTS ARCHIVES BUILDING
220 MORRISSEY BOULEVARD
BOSTON, MASSACHUSETTS 02125

| | | | |
|-------|--------------|----|---------|
| 45-19 | Boston North | BT | BLM.521 |
|-------|--------------|----|---------|

Town/City: Belmont

Place: (*neighborhood or village*):

Photograph



Address: 346 Lake Street

Historic Name: Edwin Tobey House

Uses: Present: single family dwelling

Original: single family dwelling

Date of Construction: 1910

Source: directories, maps

Style/Form: No Style

Architect/Builder: unknown

Exterior Material:

Foundation: concrete

Wall/Trim: wood clapboards

Roof: asphalt shingles

Outbuildings/Secondary Structures:

garage (1932)

Major Alterations (*with dates*):

Condition: good

Moved: no yes **Date:**

Acreage: 10,534 SF

Setting: area of single family homes ranging from 19th to 20th century

Locus Map (north at top)

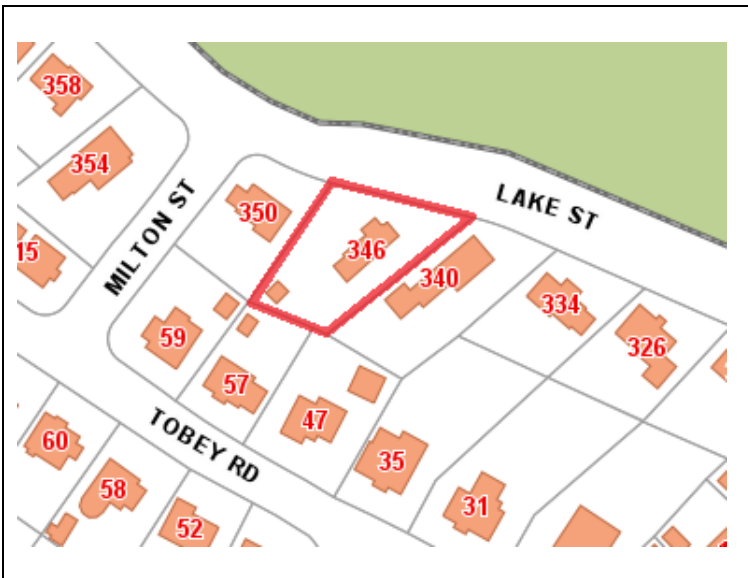

Recorded by: Lisa Mausolf

Organization: Belmont Historic District Commission

Date (*month / year*): May 2016

INVENTORY FORM B CONTINUATION SHEET

BELMONT

346 LAKE STREET

MASSACHUSETTS HISTORICAL COMMISSION

220 MORRISSEY BOULEVARD, BOSTON, MASSACHUSETTS 02125

Area(s) Form No.

BT

BLM.521

Recommended for listing in the National Register of Historic Places.

If checked, you must attach a completed National Register Criteria Statement form.

ARCHITECTURAL DESCRIPTION:

Describe architectural features. Evaluate the characteristics of this building in terms of other buildings within the community.

The house at 345 Lake Street is a modest 1 ½-story cottage constructed in the early 20th century. The clapboarded building presents its single-bay wide north gable end, which is just sixteen feet wide, to the street. The single-story section in front of the gable is original to the building. The overhanging eaves end in cornice returns. The main entrance is located on the west elevation and is sheltered by a shed roof supported by turned posts. The mix of windows includes 6/6 sash, picture windows and rows of lights tucked under the eaves. A single-story shed spans the rear elevation with a back porch.

A single car garage is located to the southwest of the house and was constructed in 1932 according to building permits.

HISTORICAL NARRATIVE

Discuss the history of the building. Explain its associations with local (or state) history. Include uses of the building, and the role(s) the owners/occupants played within the community.

The land that this house occupies was historically part of 354 Lake Street, owned by Varnum Frost in the mid to late 19th century. What is now 346 Lake Street does not appear on either the 1875 or 1898 maps. Assessors records claim that this cottage was constructed in 1850 but this appears to be erroneous. In the early 20th century the land was owned by George E. Tobey who married Gertrude A. Frost, the daughter of Sylvester Frost in 1900. Tobey was a market gardener who ran a florist business on the part of the former Frost property along Lake Street between Cross and Pleasant Streets and lived at 354 Lake Street.

On March 12, 1910 the *Belmont Tribune* reported that a new house was being erected on Lake Street for George Tobey. The house appears to have been built for George Tobey's parents and siblings. In 1922 Mr. and Mrs. Edwin Tobey were living here. In 1925 his father, Edwin Tobey, brother Albert and Albert's wife, Laura, and George's sister, Mary were all living in the small cottage. The 1930 Census indicates that Edwin Tobey, age 88, was living here with his daughter Mary, age 52, a public school teacher. In 1927 Milton Street was laid out by Charles and George Tobey and 346 Lake Street was separated from 354 Lake Street.

Sometime after 1940 the house was sold to Arthur and Myrtie Hicks. The Hicks sold the property to Evelyn Bryant in 1949 (Book 7508, Page 532). Members of the Bryant family continued to own it until 1994. It has been owned by Theresa Bonar since 1994.

INVENTORY FORM B CONTINUATION SHEET

BELMONT

346 LAKE STREET

MASSACHUSETTS HISTORICAL COMMISSION

220 MORRISSEY BOULEVARD, BOSTON, MASSACHUSETTS 02125

Area(s) Form No.

| | |
|----|---------|
| BT | BLM.521 |
|----|---------|

BIBLIOGRAPHY and/or REFERENCES

Ancestry.com

Beers, F.W. and Co. *County Atlas of Middlesex, Massachusetts*. New York: Beers, Ellis, and Soule, 1875.

Belmont: The Architecture and Development of the Town of Homes. Prepared for the Belmont Historic District Commission, 1984.

Belmont Directories, various years.

Belmont Historical Society Newsletter, Vol. XLVIII, no. 2, June 2012.

Belmont Tribune, March 12, 1910

Betts, Richard B. *The Streets of Belmont and How they Were Named* (2nd edition). Belmont: Belmont Historical Society, 2012.

Frost, C.J. Map of Belmont, 1853.

Massachusetts Historical Commission. MACRIS database.

Middlesex County Registry of Deeds, Cambridge, MA

Nash, Christopher Forbes. Area Form for Frost and Tobey Lands (Area BT), 1982.

Robbins, Samuel Dowse, ed. *Who's Who in Belmont*. Belmont: Belmont Historical Society, 1972.

Sanborn Insurance Maps, 1915, 1922, 1931, 1949.

Stadley, George W. *Atlas of the Towns of Watertown, Belmont, Arlington, and Lexington*. 1898.

Town of Belmont, Building Department files.

U.S. Census, various years.

Walker, G.H. *Atlas of Middlesex County, Massachusetts*. Boston: G.H. Walker, 1889.