

FORM B – BUILDING

Assessor's Number USGS Quad Area(s) Form Number

MASSACHUSETTS HISTORICAL COMMISSION
MASSACHUSETTS ARCHIVES BUILDING
220 MORRISSEY BOULEVARD
BOSTON, MASSACHUSETTS 02125

56-5	Boston North	BB	BLM.773
------	-----------------	----	---------

Town/City: Belmont

Place: (*neighborhood or village*):
Juniper Hill

Address: 56 Juniper Road

Historic Name: Alvin Hansen House

Uses: Present: single family dwelling

Original: single family dwelling

Date of Construction: 1939

Source: building permit

Style/Form: Colonial Revival

Architect/Builder: Derby, Barnes & Champney

Exterior Material:

Foundation: concrete

Wall/Trim: wood clapboards

Roof: asphalt shingles

Outbuildings/Secondary Structures:
none

Major Alterations (*with dates*):

1986 – new windows and doors

Condition: good

Moved: no yes **Date:**

Acreage: 20,599 SF

Setting: neighborhood of mixed 20th century dwellings
in wooded setting near Belmont Hill School

Photograph



Locus Map (north at top)

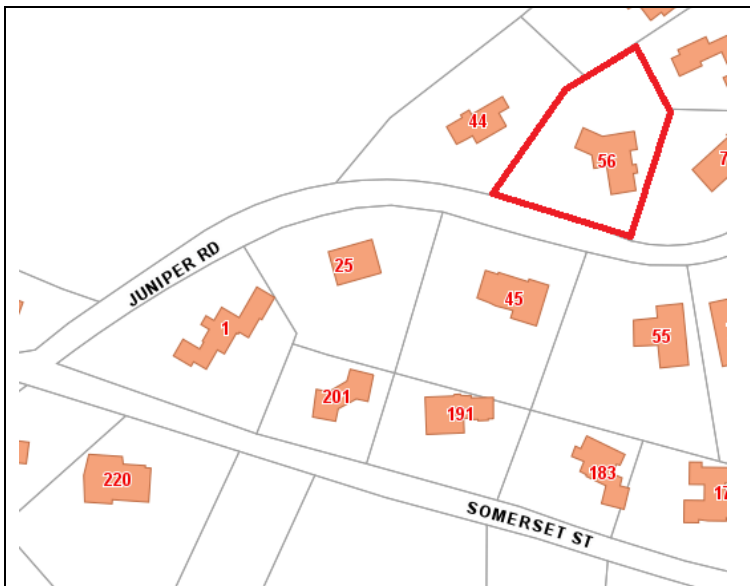

Recorded by: Lisa Mausolf

Organization: Belmont Historic District Commission

Date (*month / year*): April 2016

INVENTORY FORM B CONTINUATION SHEET

BELMONT

56 JUNIPER ROAD

MASSACHUSETTS HISTORICAL COMMISSION

220 MORRISSEY BOULEVARD, BOSTON, MASSACHUSETTS 02125

Area(s) Form No.

BB

BLM.773

Recommended for listing in the National Register of Historic Places.

If checked, you must attach a completed National Register Criteria Statement form.

ARCHITECTURAL DESCRIPTION:

Describe architectural features. Evaluate the characteristics of this building in terms of other buildings within the community.

Constructed in the 1930s, the house at 56 Juniper Road is an unusual 2 ½-story Colonial Revival dwelling. It is based loosely on historic precedents and is capped by a gambrel roof sheathed in asphalt shingles (originally wood shingles) with a prominent central brick chimney. The walls are sheathed in graduated width wood clapboards with exposure that decreases near the bottom of the wall. The façade lacks the typical five bay division typical of the Colonial Revival and displays an irregular arrangement of windows including two second floor windows tucked under the eaves and two windows that are between floors. The off-center entrance is topped by transom lights and sheltered by a cantilevered gable hood. Most of the windows contain double-hung 12/12 sash and there are two gable dormers on the front roof slope. The offset wing is capped by an asymmetrical gable roof and connects the main house to an attached angled two-car garage which was original to the house.

The house itself is angled to the street and screened from the street by its wooded setting. A stone mortared wall runs along the road.

HISTORICAL NARRATIVE

Discuss the history of the building. Explain its associations with local (or state) history. Include uses of the building, and the role(s) the owners/occupants played within the community.

Juniper Road was the last area of large homes to be developed on Belmont Hill. In 1928 the Trustees of the Belmont Hill Company sold a large parcel of land to Henry Hornblower. A series of large (20,000 to 50,000 square foot) lots were laid out on the east side of Juniper Road and the Brookline firm of Olmsted, Olmsted and Eliot was retained to plan the site. Most of the original houses were traditional English and American Revival styles but later International Style and Contemporary dwellings were also constructed on the street.

The house on Lot 18B and part of Lot 18C was constructed for Alvin and Mabel Hansen who previously lived at 176 Watson Road. Alvin Hansen (1887-1975) was appointed professor of political economy at Harvard in 1937 and was recognized as the foremost American follower of Keynes. He was a member of the President's Advisory Council on Social Security (1937-8), president of the American Economic Association in 1939, president of the US-Canadian Joint Economic Commission (1941-3) and economic advisor to the Federal Reserve Board. He retired in 1956 and traveled widely as a visiting professor. The Hansens moved to Virginia in 1972.

The 1938 building permit lists the architects of the house as Derby, Barnes & Champney, who also designed the house at 94 Juniper Road during the same time period and 89 Fletcher Road (BLM.237) in 1935. The builder was C.R. Burns of Brookline. Richard Derby (1878-1936) grew up in Concord and graduated from MIT. He practiced for a number of years with Thomas P. Robinson (Derby & Robinson) and specialized in domestic architecture (see 41 Tyler Road). By the time this house was constructed Derby was deceased. No other information was found on the works of the other members of the firm of Derby, Barnes and Champney (David D. Barnes and George M. Champney).

INVENTORY FORM B CONTINUATION SHEET

BELMONT

56 JUNIPER ROAD

MASSACHUSETTS HISTORICAL COMMISSION

220 MORRISSEY BOULEVARD, BOSTON, MASSACHUSETTS 02125

Area(s) Form No.

BB

BLM.773

BIBLIOGRAPHY and/or REFERENCES

Belmont: The Architecture and Development of the Town of Homes. Prepared for the Belmont Historic District Commission, 1984.

Betts, Richard B. *The Streets of Belmont and How they Were Named* (2nd edition). Belmont: Belmont Historical Society, 2012.

Flynn, Kay. Area Form for Juniper Hill (BLM.BB), October 1982.

Middlesex County Registry of Deeds, Cambridge, MA

Robbins, Samuel Dowse, ed. *Who's Who in Belmont.* Belmont: Belmont Historical Society, 1972.

Town of Belmont, Building Permits.

U.S. Census, various dates.

