

# FORM B – BUILDING

Assessor's Number USGS Quad Area(s) Form Number

MASSACHUSETTS HISTORICAL COMMISSION  
MASSACHUSETTS ARCHIVES BUILDING  
220 MORRISSEY BOULEVARD  
BOSTON, MASSACHUSETTS 02125

18-14	Boston North	P	BLM.767
-------	--------------	---	---------

**Town/City:** Belmont

**Place:** (*neighborhood or village*):

## Photograph



**Address:** 14 Glendale Road

**Historic Name:** H. Thaxter Underwood House

**Uses:** Present: single family dwelling

Original: single family dwelling

**Date of Construction:** 1921

**Source:** building permit

**Style/Form:** Colonial Revival (Cape)

**Architect/Builder:** H. Thaxter Underwood, architect

## Exterior Material:

Foundation: stone

Wall/Trim: wood clapboard

Roof: asphalt shingles

## Outbuildings/Secondary Structures:

garage (1997)

## Major Alterations (*with dates*):

date unknown – enclosed porches on front, new windows

## Locus Map

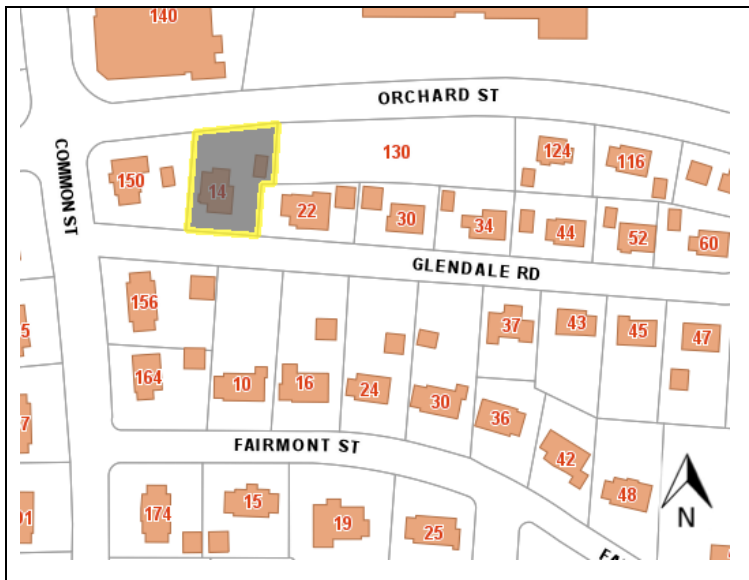

**Condition:** good

**Moved:** no  yes  **Date:**

**Acreage:** 8,759 SF

**Setting:** neighborhood of early 20<sup>th</sup> century residences on small lots

**Recorded by:** Lisa Mausolf

**Organization:** Belmont Historic District Commission

**Date** (*month / year*): November 2014

# INVENTORY FORM B CONTINUATION SHEET

BELMONT

14 GLENDALE ROAD

MASSACHUSETTS HISTORICAL COMMISSION

220 MORRISSEY BOULEVARD, BOSTON, MASSACHUSETTS 02125

Area(s) Form No.

P

BLM.767

Recommended for listing in the National Register of Historic Places.

*If checked, you must attach a completed National Register Criteria Statement form.*

## ARCHITECTURAL DESCRIPTION:

*Describe architectural features. Evaluate the characteristics of this building in terms of other buildings within the community.*

The house at 14 Glendale Road is a modest 1 ½-story Cape constructed in the early 1920s. It is sheathed in wood clapboards and is capped by a steeply-pitched gable roof with long shed dormers on both slopes. The house is oriented with its gable end to the street; centered on the gable end is an exterior brick chimney. The main house block and the attached wing are the original parts of the house. An open front porch originally extended across the façade of the main house. This was later either rebuilt or enclosed. An additional enclosed porch was added to the north in 1971. Most of the windows contain double-hung sash in an 8/1 configuration with blinds. An oriel window is located on the gable facing the street and there is an arched dormer on the rear wing.

## HISTORICAL NARRATIVE

*Discuss the history of the building. Explain its associations with local (or state) history. Include uses of the building, and the role(s) the owners/occupants played within the community.*

Glendale Road was subdivided in 1914 by the Orchard Street Associates. At the time it was last bit of farmland in the neighborhood. The property consists of Lot 2B and part of Lot 2A on a Plan of Orchard Street Associates dated June 1919 (MCRD Plan Book 274, Plan 20). In October 1921 a building permit was issued to H.T. Underwood. H.H. Hawkins & Son served as contractors. A detached garage was built in 1928 facing Orchard Street (later rebuilt).

This house is of interest as the long-time residence of local architect, H. Thaxter Underwood. Herbert Thaxter Underwood (1872-1950) was the son of Dr. George Underwood and grandson of William Underwood, founder of the food concern. He was born in Boston and was a graduate of Boston English High School. He came to Belmont as a young man. It is not known where Thaxter Underwood received his architectural training but he was in practice by 1904. He married Mabel Ricker in Somerville on May 9, 1922 and this house was built at about that time. Underwood lived here until his death in 1950. Several months later his widow Mabel sold the house to John and Eleanor Daniels. It was conveyed by Eleanor Daniels to Linda Daniels in 1981 and she sold the house to Richard Kelsey and Mary Otiato in 2009 (Book 52083, Page 111).

H. Thaxter Underwood maintained an office in Boston but designed a number of buildings in Belmont. Working with his uncle, landscape architect Loring Underwood, Thaxter designed the locker rooms/bathhouse for the Underwood Pool (1911). Other municipal commissions included the Roger Wellington School (1917), Butler School (1930), and Belmont Police Station (1930). He was also architect for the S.S. Pierce Commercial Block in Cushing Square and a number of local residences including 26-28 Cedar Road, 65 Clark Street, 1 Clover Street, 65 Common Street, 36 Hillcrest Road, and 91 Kilburn Road. Out-of-town commissions included the Sacred Heart Rectory and Convent in Malden and Woodlawn Cemetery Chapel in Acton. Outside of his architectural practice, Underwood served on the Belmont Board of Assessors for twenty-eight years.

## BIBLIOGRAPHY and/or REFERENCES

*Ancestry.com.*

*Belmont Citizen*, January 13, 1950 [obituary of H. Thaxter Underwood].

Betts, Richard B. *The Streets of Belmont and How they Were Named* (2<sup>nd</sup> edition). Belmont: Belmont Historical Society, 2012.

Lucas, Nora. Area form for Glendale Road, November 1982.

Massachusetts Historical Commission. MACRIS database.

Middlesex County Registry of Deeds, Cambridge, MA

Sanborn Insurance Maps, 1915, 1922, 1931, 1949.

Town of Belmont, Building Department Records.