

FORM B - BUILDING

AREA <u>X 2</u>	FORM NO. <u>57-7</u>
--------------------	-------------------------

MASSACHUSETTS HISTORICAL COMMISSION
294 WASHINGTON STREET, BOSTON, MA 02108



Belmont

Address 531 Concord Avenue

Historic Name Atkins/Claflin House

Present Private residence

Original Private residence

DESCRIPTION:
1926

Source Belmont engineering records

SKETCH MAP

Show property's location in relation to cross streets and/or landmarks

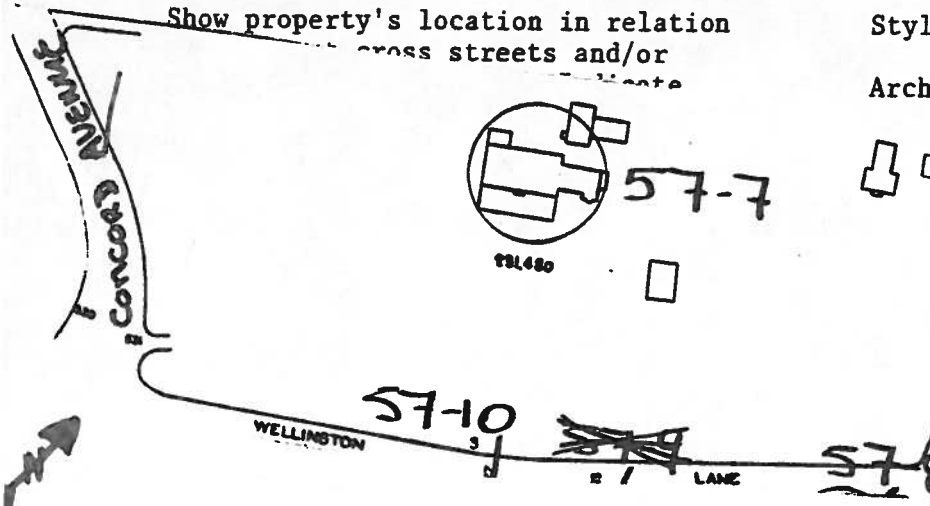

Style Colonial Revival

Architect Clipston Sturgis

Material Brick

Notes Attached Indian Museum

Attached garage.

Alterations (with dates) _____

Moved _____ Date _____

Approx. acreage 1 1/2 acres

Setting On the brow of Belmont Hill with vista of all Boston in an estate landscaped setting.

Recorded by Kay Flynn

Organization Boston University

Date October, 1982

(Staple additional sheets here)

ARCHITECTURAL SIGNIFICANCE (Describe important architectural features and evaluate in terms of other buildings within the community.)

Clipston Sturgis designed this 2½-story hipped gable brick house in 1926 for the Claflins - a prominent Belmont Hill family. A Colonial Revival House in the Georgian Colonial tradition that adheres to the symmetry, proportion and restraint of its 17th century prototypes.

Large in massing, with seven bays and 2-story setback wings, this solid house compliments its outstanding setting on the brow of Belmont Hill.
(Continued)

HISTORICAL SIGNIFICANCE (Explain the role owners played in local or state history and how the building relates to the development of the community.)

The historical significance lies in the fact that this is the most recent house (1926) in the "Holiday Farm" area and is an intact example of a large architect-designed Colonial Revival of the 1920's in an estate setting. It is also the extant family house of the Atkins/Claflin families significant to the history of Belmont.

(See Holiday Farm Area Form Inventory # X²)

BIBLIOGRAPHY and/or REFERENCES (name of publication, author, date and publisher)

French, Camilla, Talk given at the Annual Meeting of the Belmont Garden Club, May 18, 1978.

Interview upon the retirement of William Claflin by Mike Ziskind and Jack Baughman, September 16, 19 .

MASSACHUSETTS HISTORICAL COMMISSION
Office of the Secretary, Boston

Community: BELMONT	Form No: 57-7
Property Name: 531 Concord Avenue	

Indicate each item on inventory form which is being continued below.

ARCHITECTURAL SIGNIFICANCE (Continued):

The central door has Doric pilasters and fanlight and is surmounted by a tripartite window on the second floor and a triple dormer with arch. The cornice - with slight overhand - has classical dentil detailing. The fenestrations are 12 over 12 on the first floor, 8 over 12 on the second floor, while the dormers decrease to 6 over 6.

This house is a good example of a large, architect-designed Colonial Revival of the 1920's in an estate setting.

Staple to Inventory form at bottom