

FORM B - BUILDING

MASSACHUSETTS HISTORICAL COMMISSION
294 Washington Street, Boston, MA 02108

Area <u>E</u>	Form no. <u>6-6</u>
------------------	------------------------



Belmont
s 418 Common Street
 ic Name NA
 iginal Single family dwelling
 resent Same
 hip: Private individual
 Private organization
 Public
 iginal owner R.C. Stevens

cross streets and other buildings
 or geographical features.
Indicate north.

PTION:

Date 1924

Source Building permit

Style Dutch Colonial

Architect R.C. Stevens

Exterior wall fabric Brick with wood shingles, trim

Outbuildings _____

Major alterations (with dates) _____

Moved No Date _____

Approx. acreage 10,287 sq. ft.

Setting Nicely set back on large Common Street lot at major inter-section with Payson Road

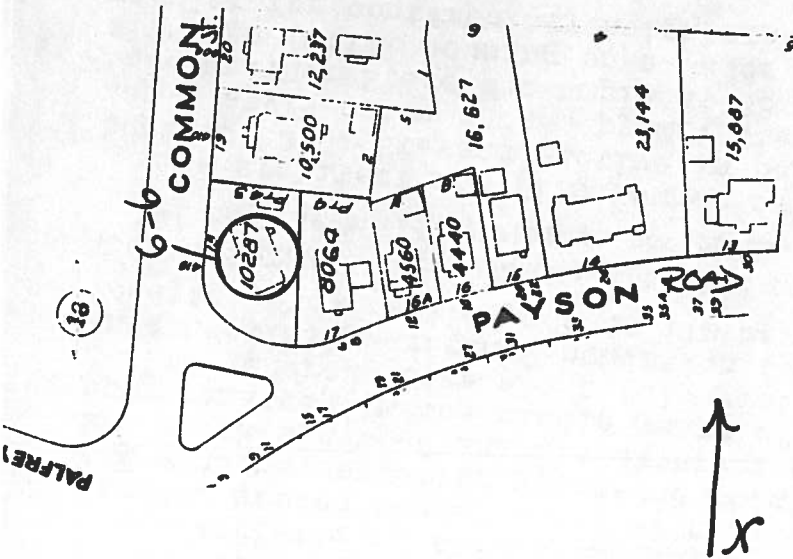

Recorded by Marcia M. Cini

Organization Boston University

Date September 1982

(Staple additional sheets here)

ARCHITECTURAL SIGNIFICANCE (describe important architectural features and evaluate in terms of other buildings within community)

418 Common Street is one of the handsomest Dutch Colonial examples in the Cushing Square-Payson Park area. It exhibits features characteristic of the style (gambrel roof with large shed dormer, 3 bay facade, hooded center entry with sidelights and columns flanked by bay windows, exterior gable-end chimney, symmetrical one-story wings and brick and wood shingle exterior wall cladding) and can be placed approximately in the middle years of its popularity.

Its generous size and highly visible location as well as its survival in essentially original condition (balustrades on wings, original leaders, etc. remain) add to its merit.

HISTORICAL SIGNIFICANCE (explain the role owners played in local or state history and how the building relates to the development of the community)

The architect and first owner of 418 Common Street was a local builder, R.C. Stevens, active in Belmont in the 1920s. Dutch Colonial was a style often chosen by Mr. Stevens as well as local home buyers. (See another Stevens example at 38 Hillside Terrace.) 418 Common Street, although infill housing on a major thoroughfare, reflects a style popular for contemporary neighborhood building as well.

BIBLIOGRAPHY and/or REFERENCES