

FORM B - BUILDING

MASSACHUSETTS HISTORICAL COMMISSION
294 WASHINGTON STREET, BOSTON, MA 02108

AREA	FORM NO.
0	18-3



Belmont
 Address 35 Cedar Road
 Historic Name NA
 Present residence
 Original same
 DESCRIPTION:
1888

Source Belmont Building Department

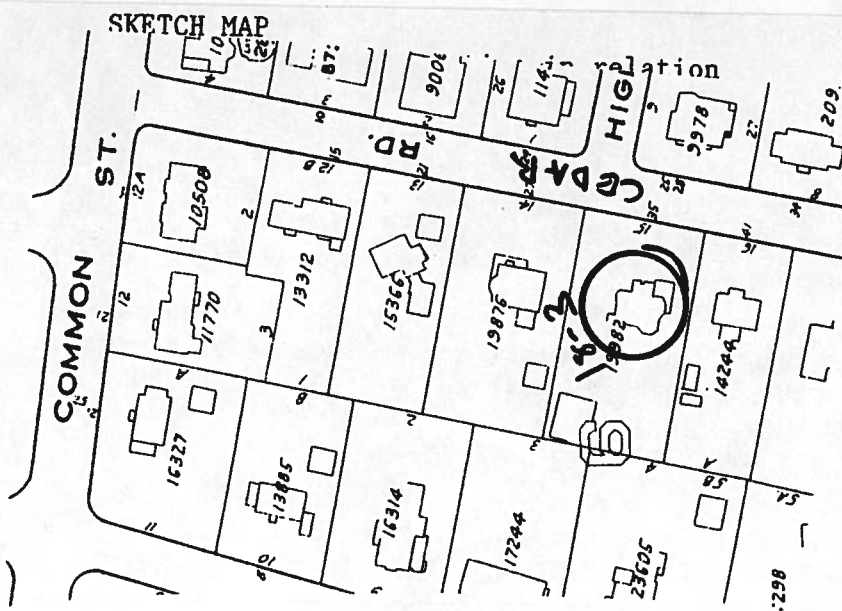

Style Queen Anne/Shingle Style

Architect NA

Exterior wall fabric wood shingle

Outbuildings NA

Major alterations (with dates) _____

NA

Moved NA Date _____

Approx. acreage less than 1/2 acre

Setting On a large lot in a residential street in a neighborhood of substantial suburban homes.

Recorded by Nora Lucas

Organization Boston University

Date November 1982

(Staple additional sheets here)

ARCHITECTURAL SIGNIFICANCE (Describe important architectural features and evaluate in terms of other buildings within the community.)

35 Cedar Road (BEL-82-15-#9) is significant as an excellent illustration of the overlap between the Queen Anne and Shingle Styles in Belmont, meeting Criterion C of the National Register. Irregularly massed with typical Queen Anne features of a complicated roof plan with turret protruding above the main roof line, the house is sheathed in a unifying shingled surface. The house is restrained in its execution, characteristic of Belmont's late 19th-century suburban development.

HISTORICAL SIGNIFICANCE (Explain the role owners played in local or state history and how the building relates to the development of the community.)

The house is significant primarily for its illustration of late 19th-century suburban growth. It is a building type prototypical of most of Belmont's 20th-century development - the modest single family house. As such, 35 Cedar Road merits inclusion in the National Register under Criterion A.

BIBLIOGRAPHY and/or REFERENCES (name of publication, author, date and publisher)

Building Department Records
1898 Atlas
Belmont Town Directories 1898, 1900