

FORM B - BUILDING

MASSACHUSETTS HISTORICAL COMMISSION
294 WASHINGTON STREET, BOSTON, MA 02108

AREA	FORM NO.
	24-4



Director _____
 Show property's location in relation to nearest cross streets and/or geographical features. Indicate all buildings between inventoried property and nearest intersection. Indicate north.

See attached

Recorded by Nora Lucas
 Organization Boston University
 Date November 1982

City Belmont
 Address 346 Concord Avenue
 Historic Name none
 Use: Present residence
 Original residence
 DESCRIPTION:
 Date 1836
 Source building department records
 Style Greek Revival
 Architect NA
 Exterior wall fabric wood clapboard
 Outbuildings barn - Italianate Style
 Major alterations (with dates) _____
NA
 Moved NA Date _____
 Approx. acreage just under 6 acres
 Setting Accessed by right-of-way at
end of long drive, it is set on wooded
lot which does not front street

(Staple additional sheets here)

ARCHITECTURAL SIGNIFICANCE (Describe important architectural features and evaluate in terms of other buildings within the community.)

This 1836 Greek Revival house is the best example of a temple-front Greek Revival house in Belmont. It was built by Samuel O. Mead, son-in-law of Jeduthan Wellington, and has housed descendants of the Wellington, Mead, and Underwood families since its construction. Mead was one of the three member committee charged with organizing the incorporation of the town of Belmont.

The house is built on a grand scale. A two story front porch, with four fluted ionic columns supports a pedimented gable. A center front door on the porch is protected by a five sided glass and wood enclosure. (BEL-82-15-27A)

HISTORICAL SIGNIFICANCE (Explain the role owners played in local or state history and how the building relates to the development of the community.)

This house represents the earliest surviving building located on what is known as the Underwood Estate. Builder Samuel O. Mead married Maria Wellington and in 1826 built a Federal Style house on Wellington Hill, now 504 Concord Avenue (Form 57-17). By 1829 Mead owned the 14 acres now known as the Underwood Estate, and, as he prospered, he built this imposing Greek Revival house in 1836.

While living here Mead was one of four men who worked diligently to insure the town of Belmont's incorporation. His daughter Esther married William Underwood, son of the founder of the Underwood Canning Co. Their son H.O. Underwood's granddaughter, Margaret Hasse Wellington and her husband still own the house.

See Wellington Station (Form 24-1), for information on another building on the property, built by Mead in 1840.

As a symbol of Belmont's 19th-century history as a community filled with large estates, and as an exhuberant and the best example of the Greek Revival Style in Belmont, 346 Concord Avenue is significant under Criteria A and C of the National Register.

BIBLIOGRAPHY and/or REFERENCES (name of publication, author, date and publisher)

French, Mrs. Frank, "The Samuel O. Mead House:504 Concord Avenue," Belmont Citizen, August 30, 1973
Underwood File, Belmont Memorial Library, Belmont Room.

346 CONCORD AVENUE INVENTORY CONTINUATION SHEET

Architectural Significance Continued

An Italianate barn of later date (BEL-82-19-6) is extant to the rear of the house. The gable-roofed wood-framed structure has brackets at eaves and a flat-roofed cupola.



31

35

24-1

24-2

24-3

CONCORD

29440

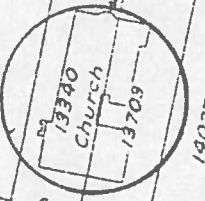

14027



6731

13169

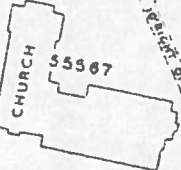

55567

LIBRARY

82575

BARR

24-13

378A



24126

14223

527

18020

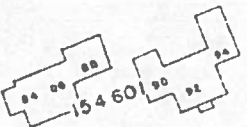

15460

24-12

24-11

31

4

24-14



84763

24-8



17943

24-7

72863



11369

24-9



100

CLARK

ST.

SCHOOL

ST.

24-10

ST.

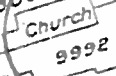

9992

13556

16364

ORCHARD

25

25

WAVERLEY

