

FORM B - BUILDING

MASSACHUSETTS HISTORICAL COMMISSION
294 WASHINGTON STREET, BOSTON, MA 02108

AREA Q2	FORM NO. 17-4
------------	------------------



Belmont
 Address 223-25 Slade Street
 Historic Name _____

Present 2-family residence
 Original 2-family residence

DESCRIPTION:
 Date 1923

Source Building Department Records

Style Colonial Revival

Builder: Bates and Wigglesworth

Exterior wall fabric clapboarding

Outbuildings -

Major alterations (with dates) _____

Moved _____ Date _____

Approx. acreage less than 1 acre

Setting Residential neighborhood of upper middle class single family homes

SKETCH MAP

Show property's location in relation

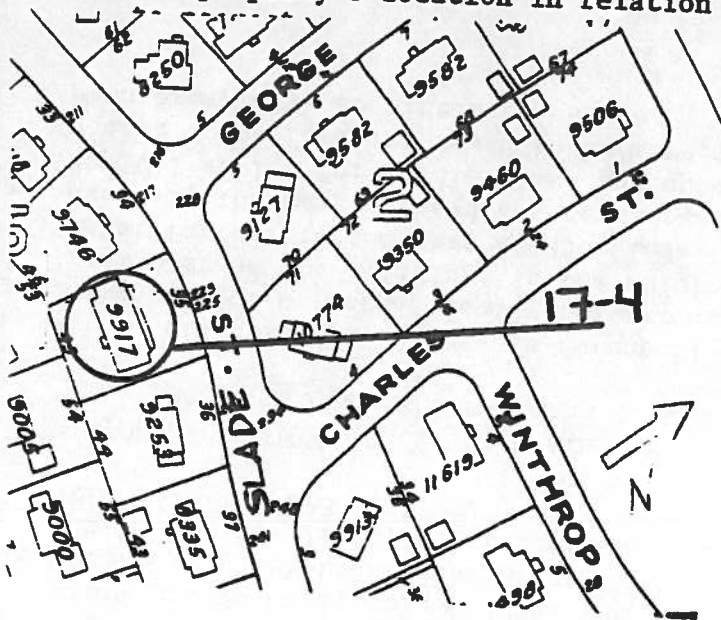

Recorded by Judy Williams

Organization Boston University

Date November, 1982

(Staple additional sheets here)

ARCHITECTURAL SIGNIFICANCE (Describe important architectural features and evaluate in terms of other buildings within the community.)

An unusual double house built in 1923, 223-25 Slade Street has elements of a monumental Colonial Revival style. Its two halves are mirror images, each containing three bays with a sidehall entry and a garage wing at the basement level. Seven two-story square Doric columns span the width of the facade, creating a large portico. The facade is flush-boarded as in the Greek Revival period; doors have full-length sidelights and are flanked by pilasters. Above the classical entablature is a parapet roof with two end chimneys.

HISTORICAL SIGNIFICANCE (Explain the role owners played in local or state history and how the building relates to the development of the community.)

This building is notable as one of only two double houses constructed in a neighborhood of single-family homes. Its monumental scale and style set is apart from most of the buildings in the neighborhood, although two other unusual houses exist further to the east at 256 Slade (see Inventory Form #17-3) and 217 Common. Overall, the neighborhood was developed between 1921 and 1928 in a variety of Colonial Revival styles for middle class and upper middle class residents. Undoubtedly, the double house form was found to be more acceptable if dressed in a compatible, and even exemplary, architectural style.

BIBLIOGRAPHY and/or REFERENCES (name of publication, author, date and publisher)

Building Permit, 1923.

Betts, Richard B. The Streets of Belmont and How They Were Named. 1974.