

FORM B - BUILDING

MASSACHUSETTS HISTORICAL COMMISSION
294 WASHINGTON STREET, BOSTON, MA 02108

AREA F ²	FORM NO. 27-11
------------------------	-------------------



Belmont
 Address 17 Sycamore Street
 Historic Name C.W. Kilpatrick House
 Present 2-family residence
 Original single family residence
 DESCRIPTION:
1911

SKETCH MAP

Show property's location in relation to nearest cross streets and/or geographical features. Indicate

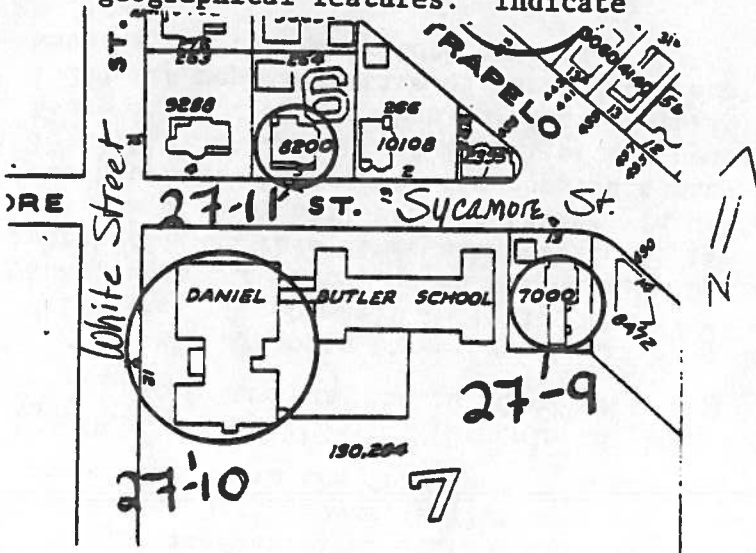

Source Building Department Records
 Style Colonial Revival
~~Architect~~ Builder: Charles W. Kilpatrick
 Exterior wall fabric Shingles
 Outbuildings Carriage-house
 Major alterations (with dates) 1923 converted to two-family
 Moved - Date -
 Approx. acreage less than 1 acre
 Setting Opposite Daniel Butler School, near Trapelo Road--an of mostly two-family residences.

Recorded by Judy Williams
 Organization Boston University
 Date November, 1982

(Staple additional sheets here)

ARCHITECTURAL SIGNIFICANCE (Describe important architectural features and evaluate in terms of other buildings within the community.)

No. 17 Sycamore Street is representative of the large-scale symmetry of the Colonial Revival as adapted to the residences of a central middle class section of Belmont in the early 20th century. This house is also noteworthy because its quality is unusually high and because it was built by a local builder for himself.

The house features a steeply-pitched hipped roof, a central gabled dormer over a projecting pavilion, and a long front porch occupying the width of the building and containing Doric posts, a flat roof and a balustrade. Original details are well preserved, as in the front door, in the tri-partite casement windows with diamond

HISTORICAL SIGNIFICANCE (Explain the role owners played in local or state history and how the building relates to the development of the community.)

No. 17 Sycamore Street was built by a local Waverley contractor, Charles W. Kilpatrick, for himself in 1911. The house is ideally located near the Trapelo Road streetcar route, which was developing into a commercial center of some importance. At this time, subdivision of the Waverley area was rapid, and Kilpatrick was one of many builders who arrived in search of contracts to build some of the new housing. Kilpatrick did construct many houses in the Waverley area during 1911-1915, including nearly all of the houses on Ridge Road to the south. The house at No. 17, although built as a single family (converted to two-family in 1923), is representative of the builder and the streetcar suburb as both came to Waverley in the early 20th century.

BIBLIOGRAPHY and/or REFERENCES (name of publication, author, date and publisher)

Betts, Richard B., The Streets of Belmont and How They Were Named, 1974

Belmont Town Directory, 1912, 1918

Building Permits, 1911

INVENTORY FORM CONTINUATION SHEET

MASSACHUSETTS HISTORICAL COMMISSION
Office of the Secretary, Boston

Community: <i>Belmont</i>	Form No: <i>27-11</i>
Property Name: <i>Lilpatrick House</i>	

Indicate each item on inventory form which is being continued below.

Architectural Significance:

panes, and in the finials of the posts on the second story balustrade. The building also features modillions under wide eaves, a hipped roof dormer on the west, and a bay window on the east side of the front facade. The property is in excellent condition, including the two-story shingled garage at the rear.