

BELMONT HIGH SCHOOL

I. MAJOR RENOVATION / MINOR ADDITION / C.2.1

SITE PLAN ESTIMATED CONSTRUCTION DURATION : 48 MONTHS



PLAN DIAGRAMS



PROPOSED BUILDING CONFIGURATION

•

9-12 HIGH SCHOOL FOR 1,470 STUDENTS

→

343,494 GSF

•

8-12 HIGH SCHOOL FOR 1,845 STUDENTS

→

393,561 GSF

•

7-12 HIGH SCHOOL FOR 2,215 STUDENTS

→

451,575 GSF

KEY ATTRIBUTES

•

COMMON SPACES ALONG POND EDGE

•

NEW INTERIOR COURTYARD SPACES

•

MAINTAINS EXISTING BUILDING SITING

•

PRESERVES MANY EXISTING SPACES

•

VARIETY OF BUILDING HEIGHTS

II. MINOR RENOVATION / MAJOR ADDITION / C.2.3

SITE PLAN ESTIMATED CONSTRUCTION DURATION : 42 MONTHS



PLAN DIAGRAMS



PROPOSED BUILDING CONFIGURATION

•

9-12 HIGH SCHOOL FOR 1,470 STUDENTS

→

343,494 GSF

•

8-12 HIGH SCHOOL FOR 1,845 STUDENTS

→

393,561 GSF

•

7-12 HIGH SCHOOL FOR 2,215 STUDENTS

→

451,575 GSF

KEY ATTRIBUTES

•

LANDSCAPE WEAVING INTO CENTER

•

TERRACED MASSING/ ROOF TOP GARDENS

•

CENTRALIZED SHARED SPACES BETWEEN NEIGHBORHOODS

•

ACADEMIC WINGS WITH FIELD VIEWS

II. MINOR RENOVATION / MAJOR ADDITION / C.2.4

SITE PLAN ESTIMATED CONSTRUCTION DURATION : 42 MONTHS



PLAN DIAGRAMS

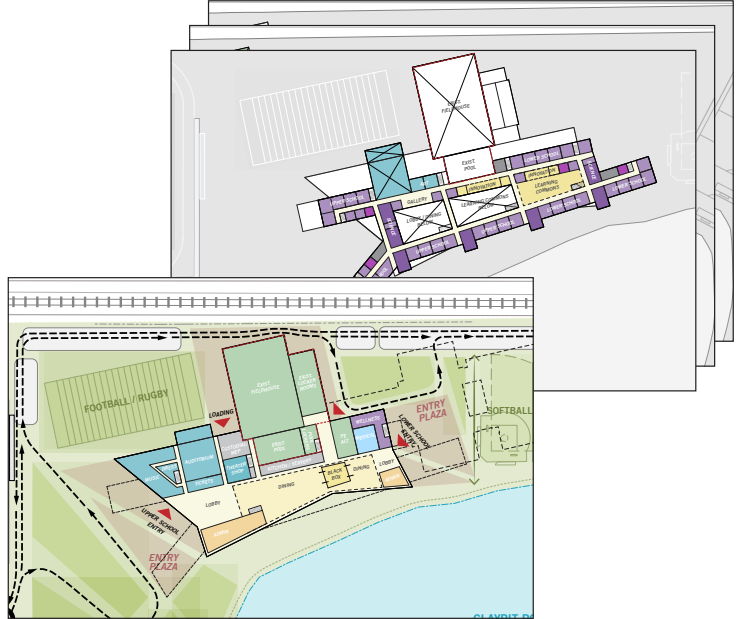

PROPOSED BUILDING CONFIGURATION

•

9-12 HIGH SCHOOL FOR 1,470 STUDENTS

→

343,494 GSF

•

8-12 HIGH SCHOOL FOR 1,845 STUDENTS

→

393,561 GSF

•

7-12 HIGH SCHOOL FOR 2,215 STUDENTS

→

451,575 GSF

KEY ATTRIBUTES

•

LINEAR CONSTRUCTION ALONG POND

•

ACADEMIC VIEWS TO GREEN SPACE/ POND

•

OPPOSING ENTRIES AT ENDS

•

CENTRALIZED BUILDING SITING

•

FIRST FLOOR SHARED CORE SPACE

III. NEW CONSTRUCTION / C.3.1

SITE PLAN ESTIMATED CONSTRUCTION DURATION : 36 MONTHS



PLAN DIAGRAMS



PROPOSED BUILDING CONFIGURATION

•

9-12 HIGH SCHOOL FOR 1,470 STUDENTS

→

311,619 GSF

•

8-12 HIGH SCHOOL FOR 1,845 STUDENTS

→

363,186 GSF

•

7-12 HIGH SCHOOL FOR 2,215 STUDENTS

→

422,700 GSF

KEY ATTRIBUTES

•

COMPACT ALL NEW CONSTRUCTION

•

FOCUS ON VIEWS/ ACCESSIBILITY TO POND AND ATHLETIC FIELDS

•

DOES NOT SAVE EXISTING FIELDHOUSE AND POOL

•

CONTINUOUS FIELDS/ GREEN SPACE ALONG NORTH

NEIGHBORHOOD CONFIGURATIONS FOR 7-9 AND 10-12

I. MAJOR RENOVATION / MINOR ADDITION / C.2.1

II. MINOR RENOVATION / MAJOR ADDITION / C.2.3

II. MINOR RENOVATION / MAJOR ADDITION / C.2.4

III. NEW CONSTRUCTION / C.3.1

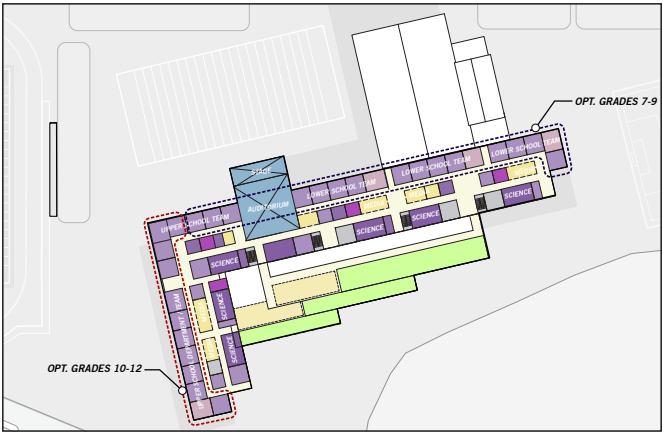
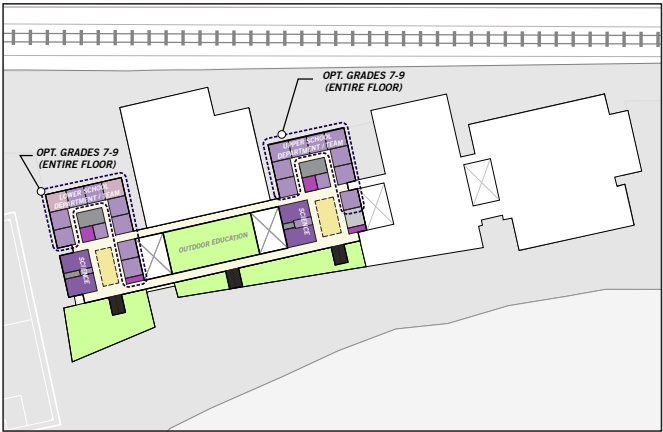
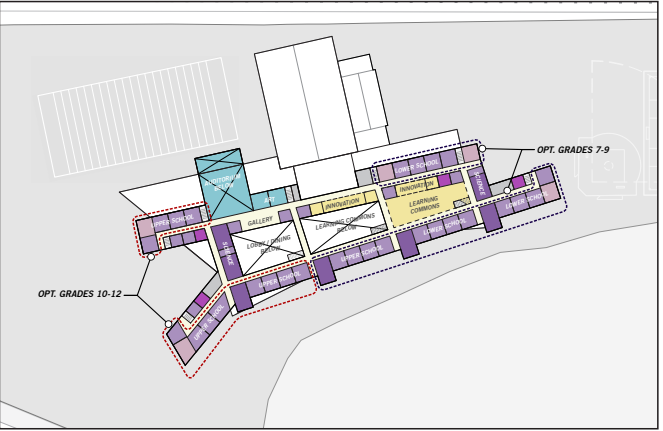
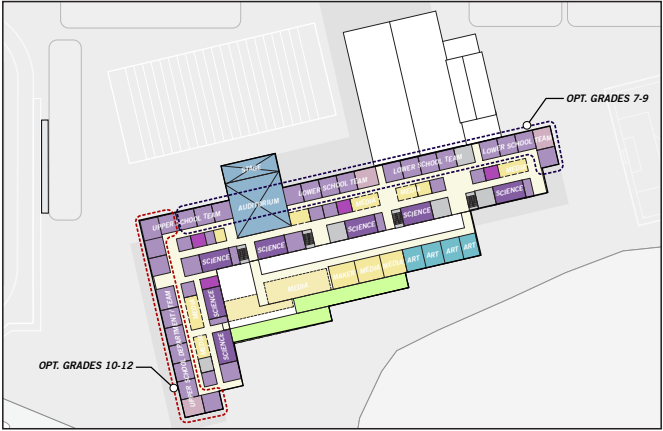
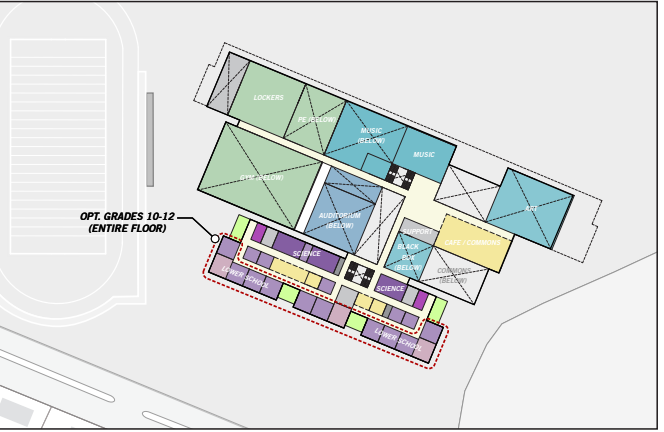
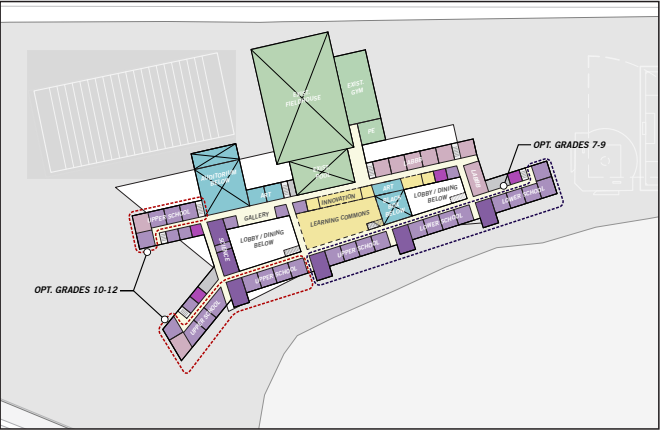
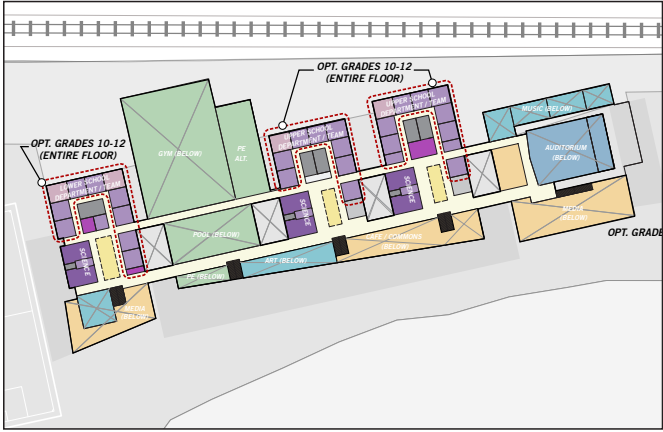
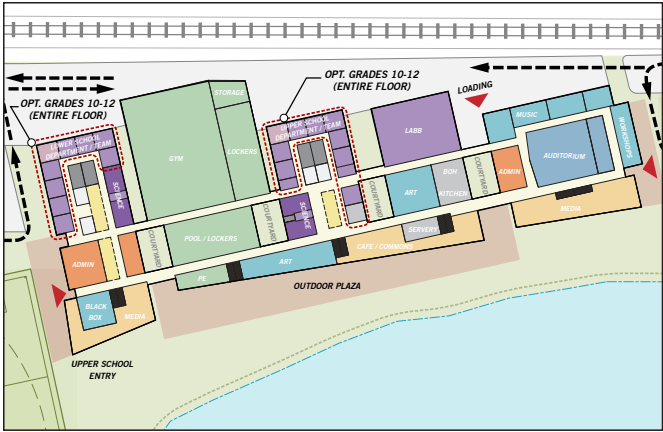

BELMONT HS - CONCEPT COST SUMMARY - PDP
 DAEDALUS PROJECTS INC.
 Updated 01/23/18 Rev. 2

		Scheme A		Scheme B		Scheme C	
Grade Configuration		9-12		8-12		7-12	
Enrollment		1,470		1,845		2,215	
existing SF		257,120		257,120		257,120	
proposed SF Add/Reno		343,494		393,561		451,575	
proposed SF New		311,619		363,186		422,700	
		Construction Cost	Project Cost	Construction Cost	Project Cost	Construction Cost	Project Cost
1	Renovation of existing only	\$101,192,523	\$124,740,654	N/A	N/A	N/A	N/A
	Belmont Cost		\$92,308,084				
	Per Sq Ft.	\$393.56					
2.1	Major Renovation/Minor Addition Maintains existing Fieldhouse/Pool & Auditorium	\$189,169,735	\$235,962,169	\$204,901,307	\$255,626,634	\$237,611,855	\$296,514,819
	Belmont Cost		\$174,612,005		\$189,163,709		\$219,420,966
	Per Sq Ft.	\$550.72		\$520.63		\$526.18	
2.3	Minor Renovation/Major Addition Maintains existing Fieldhouse/Pool	\$199,105,693	\$248,382,116	\$221,456,334	\$276,320,418	\$250,992,630	\$313,240,788
	Belmont Cost		\$183,802,766		\$204,477,109		\$231,798,183
	Per Sq Ft.	\$579.65		\$562.70		\$555.82	
2.4	Minor Renovation/Major Addition Maintains existing Fieldhouse/Pool	\$194,625,389	\$242,781,736	\$218,874,896	\$273,093,620	\$248,368,872	\$309,961,090
	Belmont Cost		\$179,658,485		\$202,089,279		\$229,371,207
	Per Sq Ft.	\$566.60		\$556.14		\$550.01	
3.1	New Construction West Side of BHS Demo BHS, New Gym & Auditorium. No Pool	\$188,311,282	\$233,639,103	\$211,361,213	\$262,451,516	\$237,856,311	\$295,570,389
	Belmont Cost		\$172,892,936		\$194,214,122		\$218,722,088
	Per Sq Ft.	\$604.30		\$581.96		\$562.71	