



MASSACHUSETTS DEPARTMENT OF TRANSPORTATION HIGHWAY DIVISION

BELMONT / WATERTOWN
TRAPELO RD & BELMONT ST

STATE	FED. PROJ. AID NO.	SHEET NO.	TOTAL SHEETS
MASS.	xxxxx	1	77
PROJ. FILE NO. 604688			

FINAL RIGHT OF WAY
TITLE SHEET & INDEX

ALL WORK DONE UNDER THIS CONTRACT SHALL BE IN CONFORMANCE WITH THE MASSACHUSETTS HIGHWAY DEPARTMENT STANDARD SPECIFICATIONS FOR HIGHWAYS AND BRIDGES DATED 1988 AND THE ENGLISH SUPPLEMENTAL SPECIFICATIONS DATED FEBRUARY 25, 2010; THE STANDARD SPECIAL PROVISIONS, THE 2010 CONSTRUCTION STANDARDS AND THE SUPPLEMENTAL DRAWINGS DATED APRIL 2003; THE 2009 MANUAL ON UNIFORM TRAFFIC CONTROL DEVICES WITH MASSACHUSETTS AMENDMENTS; THE 1995 CONSTRUCTION AND TRAFFIC STANDARD DETAILS; THE 1968 STANDARD DRAWINGS FOR TRAFFIC SIGNALS AND HIGHWAY LIGHTING; THE LATEST EDITION OF AMERICAN STANDARD FOR NURSERY STOCK; THE PLANS AND SPECIAL PROVISIONS.

DESIGN DESIGNATION - TRAPELO ROAD (RTE. 60)

DESIGN SPEED	=	35 M.P.H.
ADT (2012)	=	30,055
ADT (2032)	=	32,550
K	=	7.9%
D	=	55%
T (PEAK HOUR)	=	5.6%
T (AVERAGE DAY)	=	4.7%
DHV	=	2,571
DDHV	=	1,414
FUNC. CLASS	=	URBAN PRINCIPAL ARTERIAL

DESIGN DESIGNATION - TRAPELO ROAD

DESIGN SPEED	=	35 M.P.H.
ADT (2012)	=	15,950
ADT (2032)	=	17,275
K	=	7.6%
D	=	62%
T (PEAK HOUR)	=	6.3%
T (AVERAGE DAY)	=	5.6%
DHV	=	1,313
DDHV	=	814
FUNC. CLASS	=	URBAN PRINCIPAL ARTERIAL

DESIGN DESIGNATION - BELMONT STREET

DESIGN SPEED	=	35 M.P.H.
ADT (2012)	=	23,700
ADT (2032)	=	25,670
K	=	7.1%
D	=	68%
T (PEAK HOUR)	=	5.3%
T (AVERAGE DAY)	=	5.4%
DHV	=	1,823
DDHV	=	1,239
FUNC. CLASS	=	URBAN PRINCIPAL ARTERIAL

DESIGN DESIGNATION - SIDE STREETS

DESIGN SPEED	=	30 M.P.H.
FUNC. CLASS	=	LOCAL

END PROJECT
STATION 147+30.18
N 2961926.5323
E 749560.5137

BEGIN PROJECT
STATION 17+40.00
N 2967460.7350
E 738144.8003

FEDERAL AID PROJECT NO. XXX-XXXX

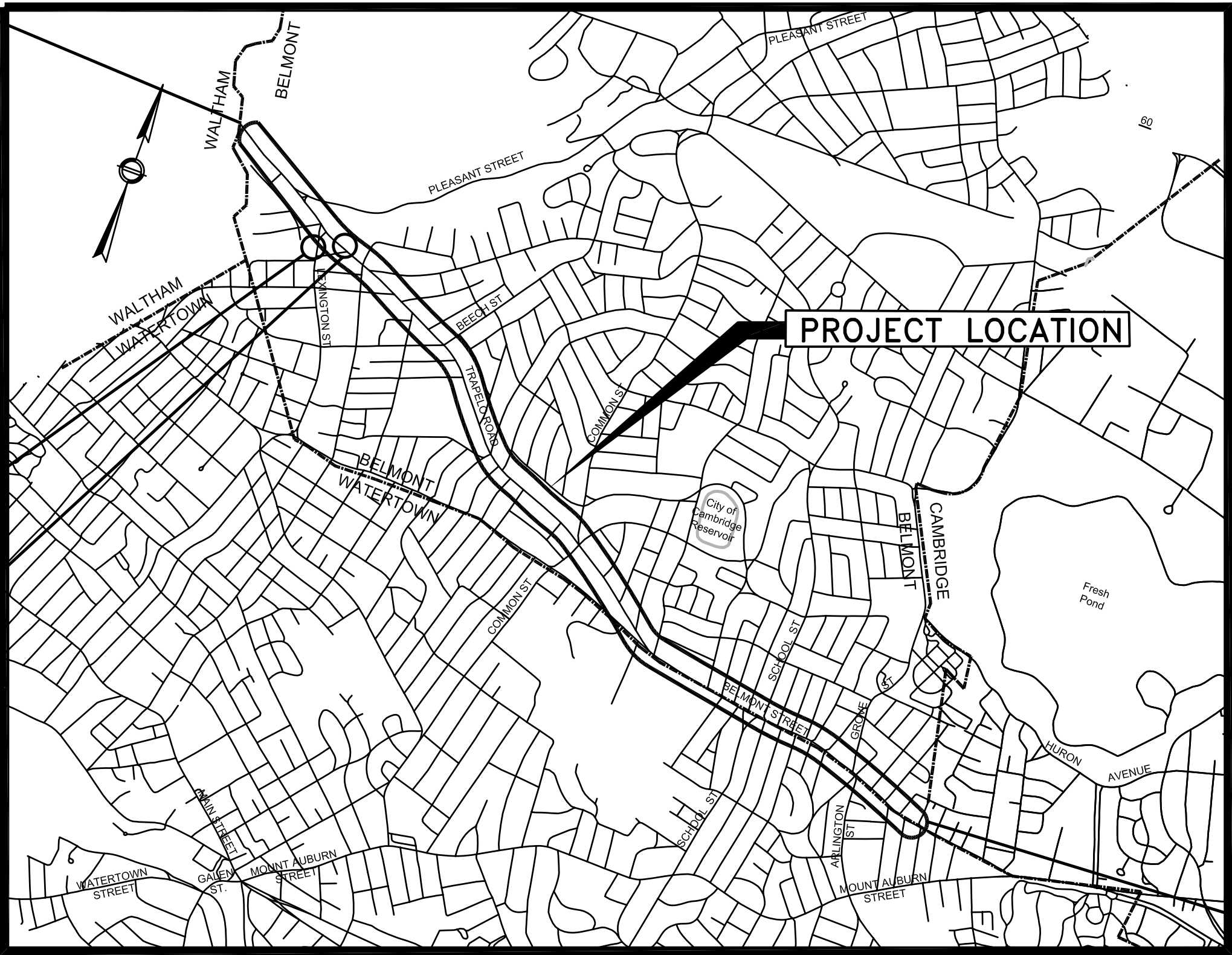

INDEX

SHEET NO.	DESCRIPTION
1	TITLE SHEET & INDEX
2-4	KEY PLAN & BORING LOCATIONS
5-25	TYPICAL SECTIONS
26-52	PROPERTY PLANS
53-63	LOCATION PLANS
64	PROFILE PLANS
65-77	PARCEL SUMMARY SHEETS

MHD BRIDGE B-7-6

MHD BRIDGE B-7-4

CONVENTIONAL SIGNS

COUNTY, CITY, OR TOWN BOUNDARY	-----
COUNTY, CITY, OR TOWN SIDE LINE	-----
FENCE LINE	-x-x-x-x-x-
BASE LINE OR SURVEY LINE	N57°-18'-41"E 74 59.57
RIGHT OF WAY LINE	=====
CULVERT	=====

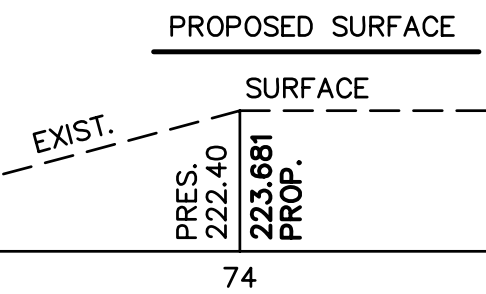

ELEVATIONS

UTILITY POLE

LOCATION MAP

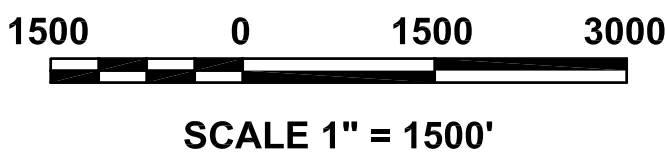

LENGTH OF PROJECT = 12,990.18 FEET = 2.460 MILES

100% SUBMISSION

MARCH 1, 2012

NO.	REVISION	DATE
4	MASSDOT COMMENTS-REVISIONS	11/11/2011
3	REMOVE SW ON MILL STREET	09/01/2011
2	ELIM. EASEMENTS FOR DCR	07/22/2011
1	MASSDOT COMMENTS-REVISIONS	03/15/2011

SUBCONSULTANT:
BSC GROUP
15 ELKINS STREET
BOSTON, MASSACHUSETTS 02127
(617) 896-4300
www.bscgroup.com

DEPARTMENT OF TRANSPORTATION
FEDERAL HIGHWAY ADMINISTRATION

APPROVED:

DIVISION ADMINISTRATOR DATE



RECOMMENDED FOR APPROVAL

CHIEF ENGINEER DATE

APPROVED

DIVISION ADMINISTRATOR DATE