

# CUSHING VILLAGE

BELMONT, MASSACHUSETTS



CUSHING VILLAGE  
BELMONT, MA

PLANNING BOARD PRESENTATION OF THE HYLAND

05 December 2012



# Cushing Village Site Plan

- Three buildings
- Tonight we present the Hyland

The WINSLOW

The POMONA

The HYLAND

- Approximately 8,000-SF commercial space
- Approximately 50,000-SF residential space
- Estimated 45 to 47 units





# Site Plan – The Hyland



View from Horne Road



View from Common Street

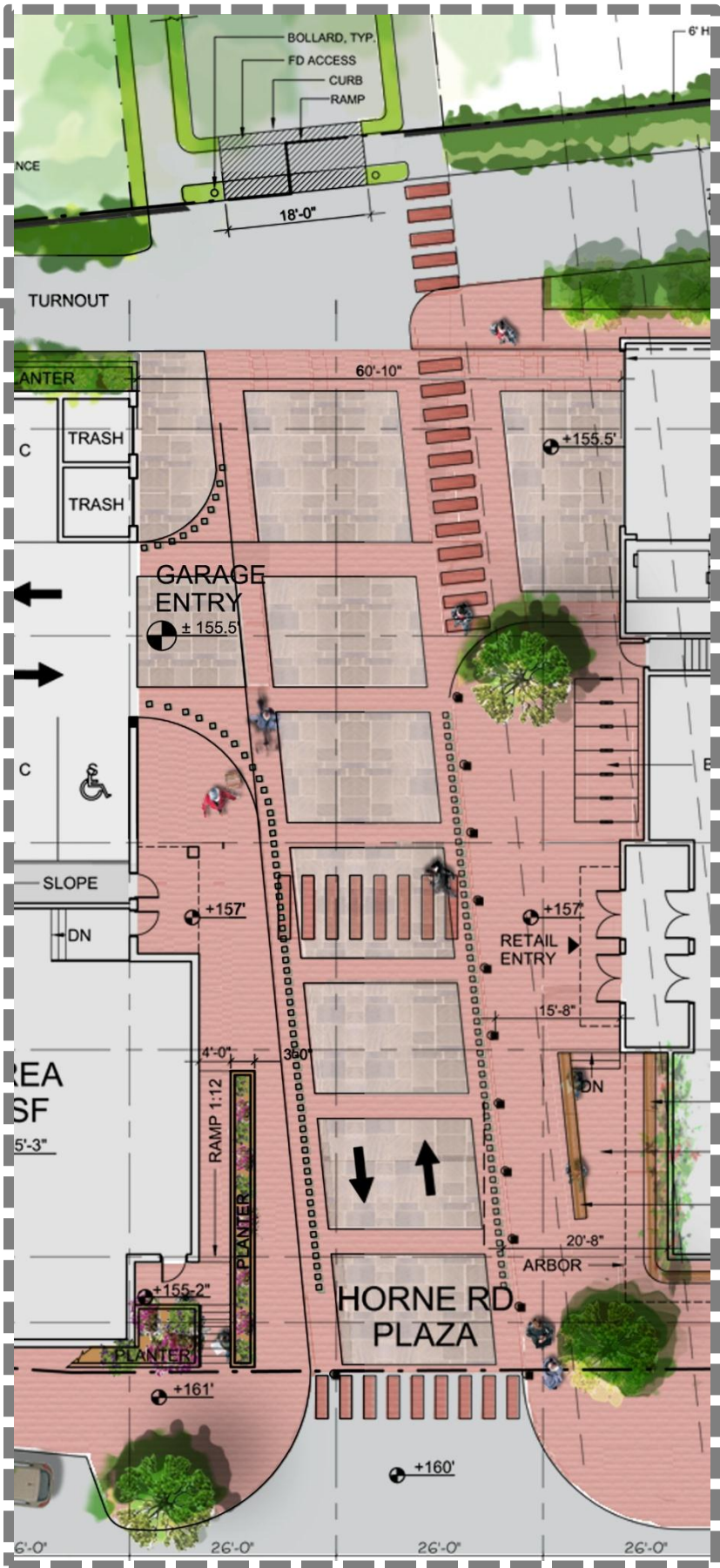

HYLAND – Horne Road Plaza



# Site Plan – The Hyland

Belmont Corner



View from Belmont Corner

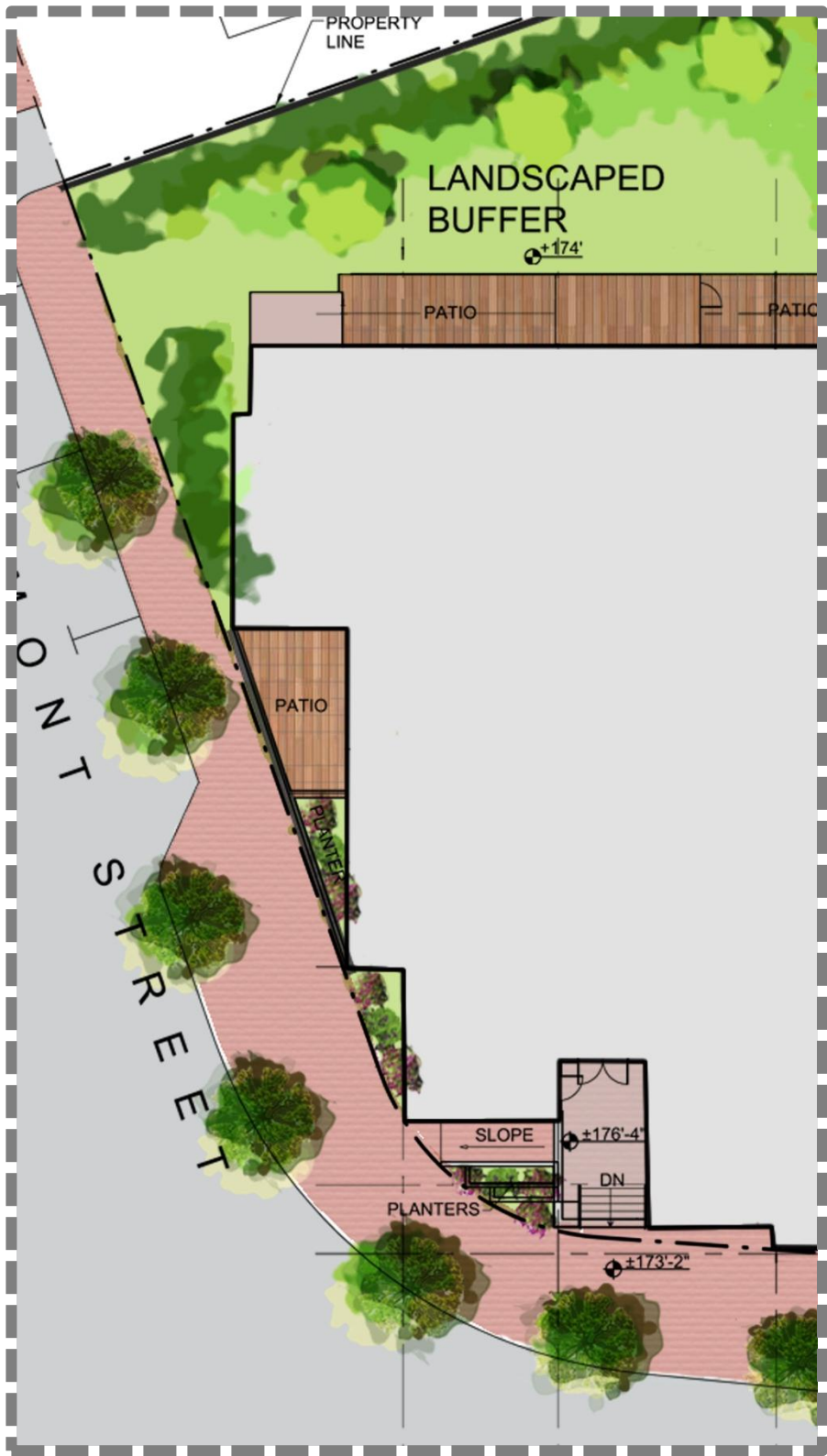



# Site Plan – The Hyland

Belmont Corner



View toward Belmont Corner

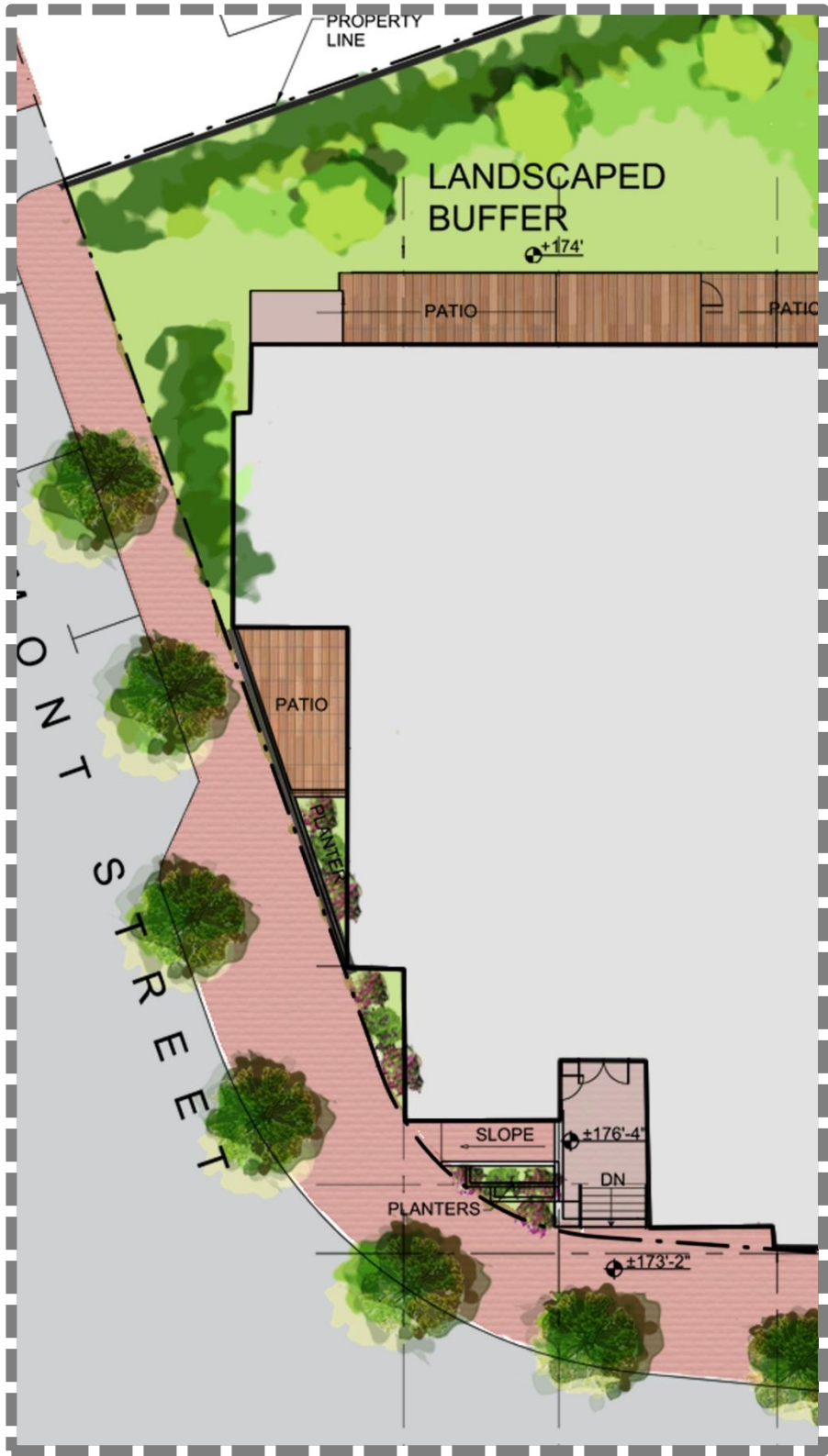



# Site Plan – The Hyland

Belmont Corner



View from Belmont Street

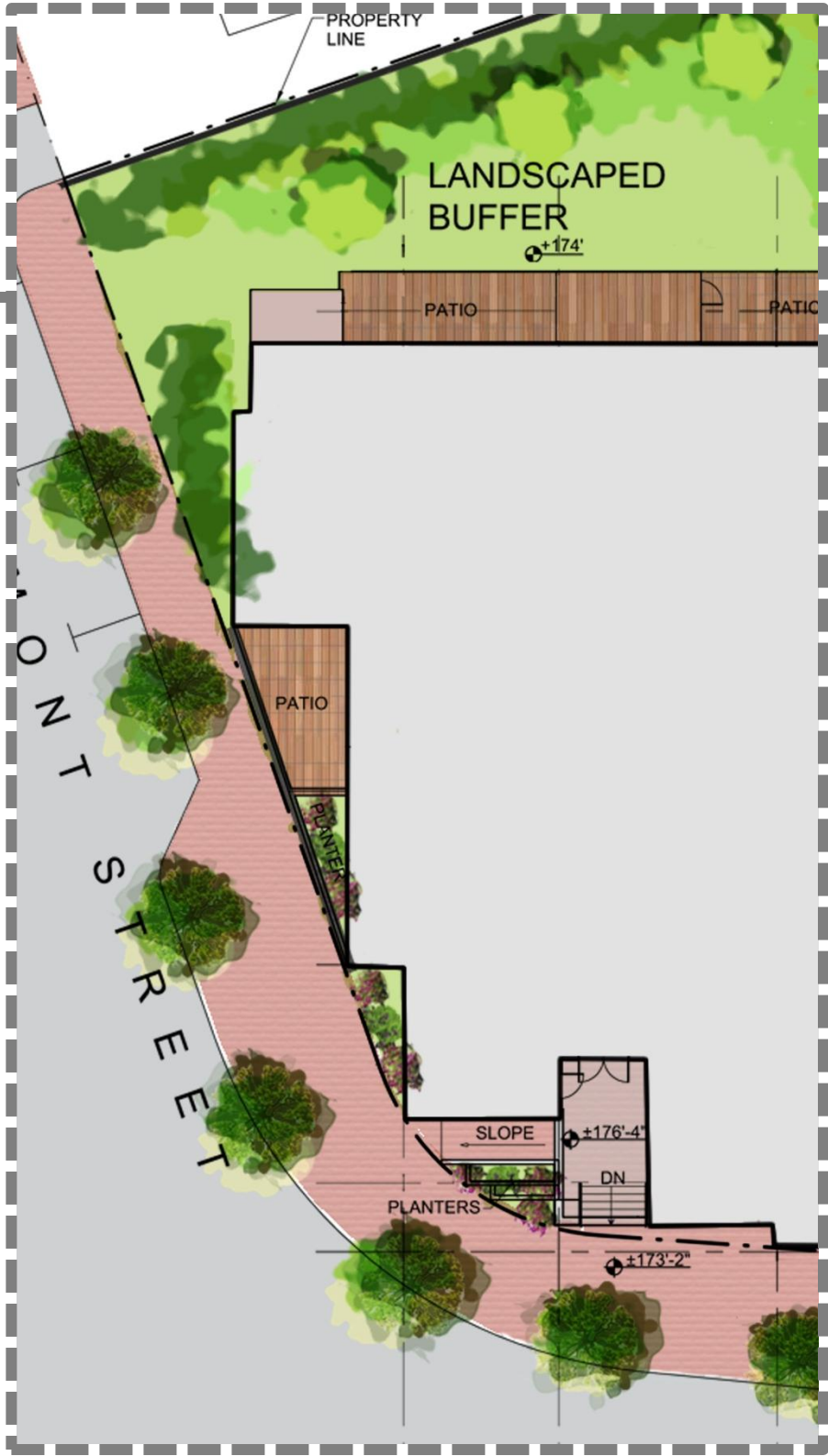



# Site Plan – The Hyland

Belmont Corner



View of Courtyard



# Site Plan – The Hyland

## Landscaped Buffer



View of Landscaped Buffer



# Elevation – Common Street





# Elevation – Belmont Street





Elevation – West





# Elevation – Horne Road



CUSHING VILLAGE  
BELMONT, MA

HYLAND – Horne Road Elevation  
12



# Elevation – Common Street (Data)





# Elevation – Horne Road (Data)





Elevation – West (Data)





# Elevation – Belmont Street (Data)





# Hyland Footprint – 4<sup>th</sup> Floor

