

1 LAYOUT & MATERIALS PLAN 1 of 3
scale: 1"=10'-0"

L-I

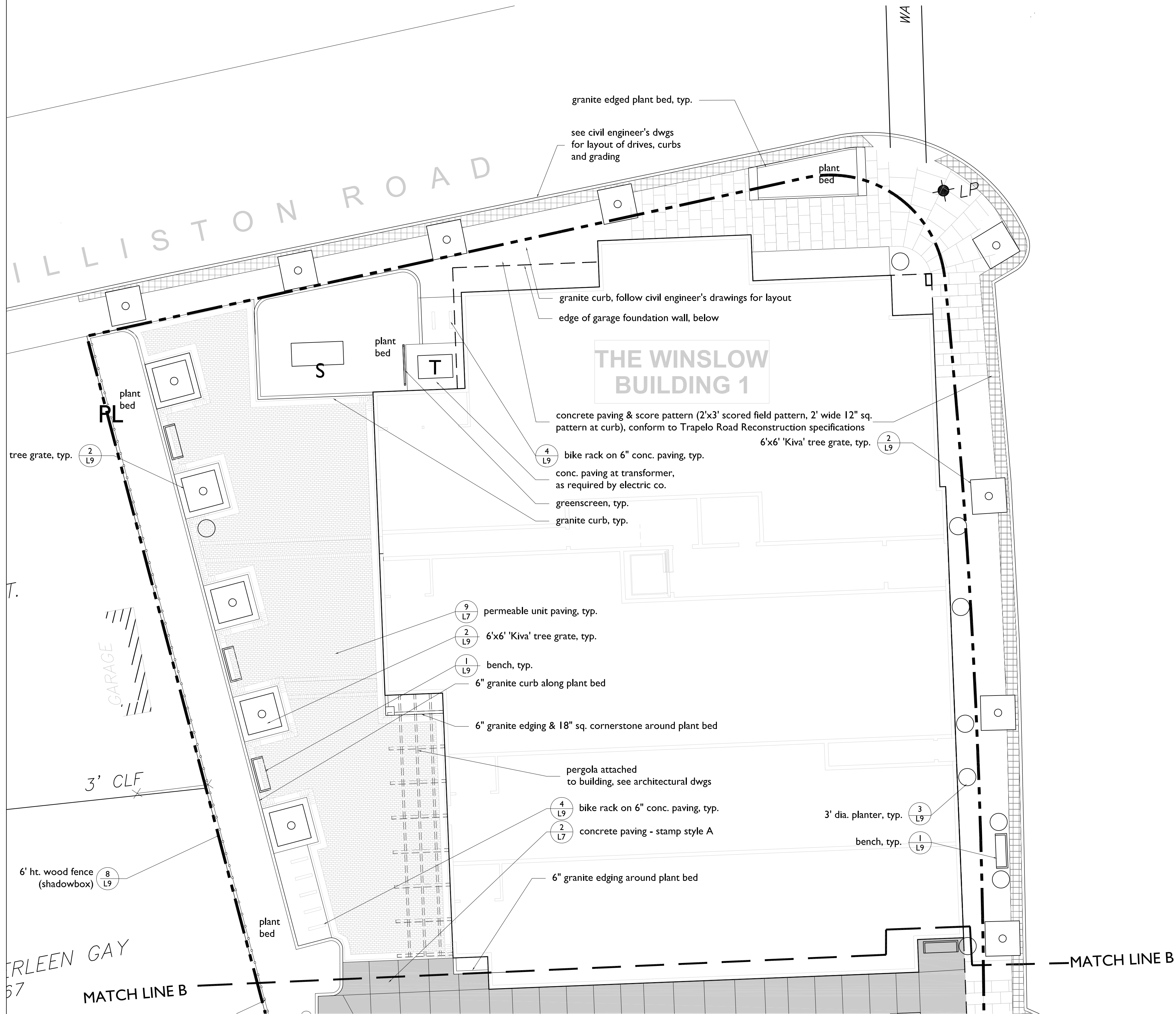

1 LAYOUT & MATERIALS PLAN 3 of 3
scale: 1"=10'-0"

LAYOUT AND MATERIALS NOTES

- Contractor shall lay out paths, walls and site improvements for review by the Architect prior to proceeding with the work. Make adjustments to layout as directed. Provide proposed grades at all corners and site features as directed.
- All lines are parallel or perpendicular to lines from which they are measured, unless otherwise noted. Dimensions are to face of wall, to face of curb; to edge of pavement; to edge of improvement or as otherwise noted.
- All pedestrian walkways and patios on one level plane: flush condition between all changes in paver/paving styles.

STREETSCAPE NOTES

- The proposed design for the streetscape along Trapelo Road, Williston and Common Streets will follow the design standards for Cushing Square Improvements that are shown on the Mass DOT Trapelo Road reconstruction. This includes:
 - Paving: a 24" colored concrete accent band with 12"x12" score joints and 2"x3" running bond concrete panels perpendicular to the back of sidewalk.
 - Granite highway curbing.
- Compliant with the Cushing Square Overlay District, the plan shows: 13 benches (1 per 50 l.f. of road frontage). These benches will match the benches that will be provided as part of the Trapelo Road reconstruction. We have been unable to obtain the specified bench from Mass DOT or from the Town of Belmont.
- 30 Street trees of 3-3.5" caliper. The street tree species are the species that are shown on the Mass DOT plans for other areas of Cushing Square.
- The plan shows six (6) granite edged plant beds within the streetscape, consisting of 6" granite landscape curb abutting 18x18 granite blocks. In addition to tree plantings, these planters include low growing deciduous shrubs and herbaceous plants that will allow for snow storage.
- The plan includes twelve (12) 2'x4' & nine (9) 3' diameter fiberglass reinforced planters for seasonal displays, accenting building entrances and passages.

In addition the the current lighting standards, the buildings will have scones and downlights to provide safe and welcoming passage along the public streets.

INTERIOR LANDSCAPE AVAILABLE TO THE PUBLIC NOTES

Pedestrian Pavements:

- Pedestrian walks will consist of a colored textured concrete in a running bond brick pattern. This pavement extends from Trapelo Road along the arcades of the Winslow and Pomona buildings to connect with the oneway drive to Horne Road Plaza. It extends along both sides of the Horne Road plaza distinguishing pedestrian passage from vehicular pavements. The pedestrian crossings across the vehicular drive will be marked and be fully ADA compliant.

- The Winslow Plaza will be paved with a running bond brick with banding.

Vehicular Pavements:

- Vehicular pavement within the Horne Road Plaza and within the parking spaces between the Winslow and Pomona buildings will consist of patterns of colored textured concrete framed with colored concrete.
- The vehicular pavement in the one way drive to the Horne Road Plaza will be concrete.

Site Amentities

- Three (3) benches will be located within the Winslow Plaza. In addition, a concrete seatwall below a pergola structure will be located at the entrance to the Horne Road Plaza.

Fiberglass reinforced planters will be located at the entrances to commercial spaces throughout the pedestrian zones of the interior of the site.

In addition to building lighting, sixteen (16) bollard lights are proposed to mark the edges of the pedestrian zones and to provide additional lighting.

There are thirteen (13) bicycle racks for twenty-six (26) bikes provided in three areas: Horne Road Plaza, and two at Winslow Plaza. As requested by the Town of Belmont additional bicycle racks can be located in the street as directed by the Town of Belmont DPW.

IRRIGATION NOTES

- Contractor shall provide a complete irrigation system for the rooftop garden including all planters as described in specifications.
- Contractor shall provide a separate price for irrigation of street tree pits and planter at front entry.

LEGEND

bit./ bit. conc.	bituminous concrete
bldg.	building
c.i.p.	cast in place
CL	centerline
CP	centerpoint
conc.	concrete
eq.	equal
ex.	existing
ht.	height
jts.	joints
max.	maximum
min.	minimum
o.c.	on center
PC	point of curvature
PL	property line
P.O.B.	point of beginning
R	radius
typ.	typical
+/-	more or less
10'	linear dimension
3 L9	detail number
9 L8	sheet number
1	
4	
↑	
D	
	hose bib
	wall-mounted light
	path light
	area drain

PETER
QUINN
ARCHI
TECTS

ARCHITECTURE
PLANNING
COMMUNITY DESIGN

PETER QUINN ARCHITECTS LLC
1904 MASS AVE., 2ND FLOOR
CAMBRIDGE, MA 02140
PH 617-354-3989 FAX 617-968-0280

SEAL



CONSULTANT

Blair Hines Design
Associates
LANDSCAPE ARCHITECTS
318 Harvard Street, Suite 25
Brookline, MA 02146
P 617.733.1180
F 617.408.9022
blairhinesdesign.com

CONSULTANT



PROJECT

CUSHING VILLAGE
CUSHING SQUARE
BELMONT, MA

PREPARED FOR



6 LITTLEFIELD ROAD
ACTON, MA 01720

DRAWING TITLE

Layout &
Materials
Plan

SCALE AS NOTED

REVISION DATE

SP REV-#3C 18 June 2013

SP REV-2 31 May 2013

DRAWN BY
KP REVIEWED BY
BH

SHEET

L-3

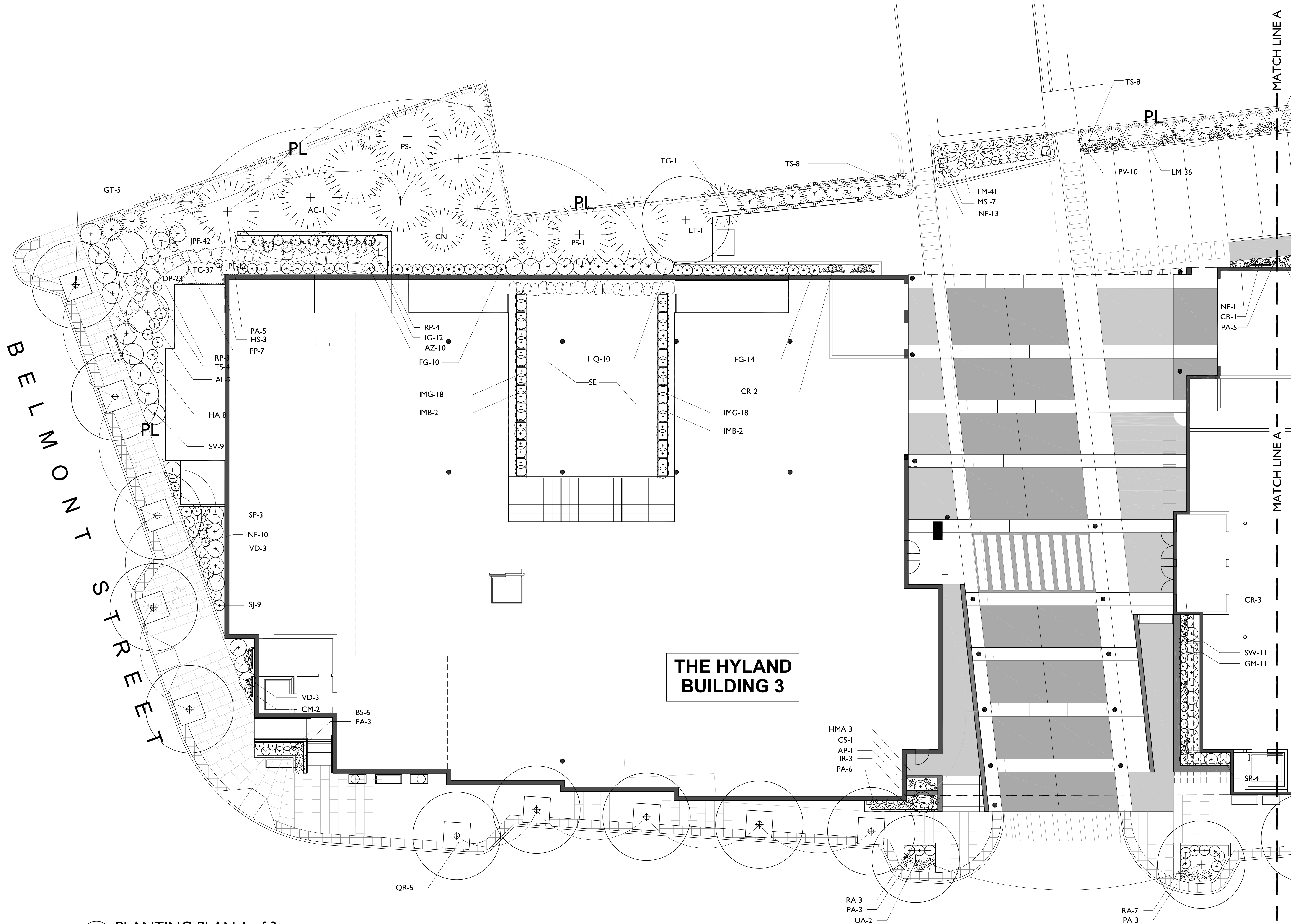

PLANTING PLAN I of 3
scale: 1"=10'-0"

See L-6 for PLANT LIST

PETER QUINN ARCHITECTS

ARCHITECTURE
PLANNING
COMMUNITY DESIGN

PETER QUINN ARCHITECTS LLC
1904 MASS AVE, 2ND FLOOR
CAMBRIDGE, MA 02140
PH 617-354-3989 FAX 617-868-0280

SEAL

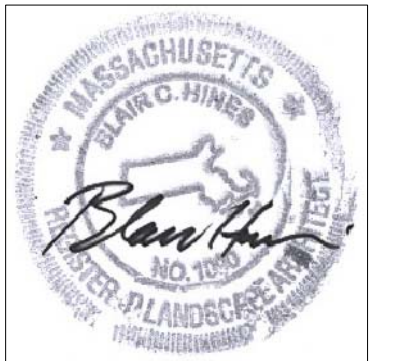

CONSULTANT
Blair Hines Design Associates
LANDSCAPE ARCHITECTS
318 Harvard Street, Suite 25
Brookline, MA 02146
P 617.733.1180
F 617.468.0022
BlairHinesDesignAssociates.com



PROJECT
CUSHING VILLAGE
CUSHING SQUARE
BELMONT, MA

PREPARED FOR
SMITH LEGACY PARTNERS
6 LITTLEFIELD ROAD
ACTON, MA 01720

DRAWING TITLE

Planting Plan

SCALE AS NOTED

REVISION	DATE
----------	------

SP REV-#3C	18 June 2013
------------	--------------

SP REV-2	31 May 2013
----------	-------------

DRAWN BY	REVIEWED BY
KP	BH

SHEET

L-4

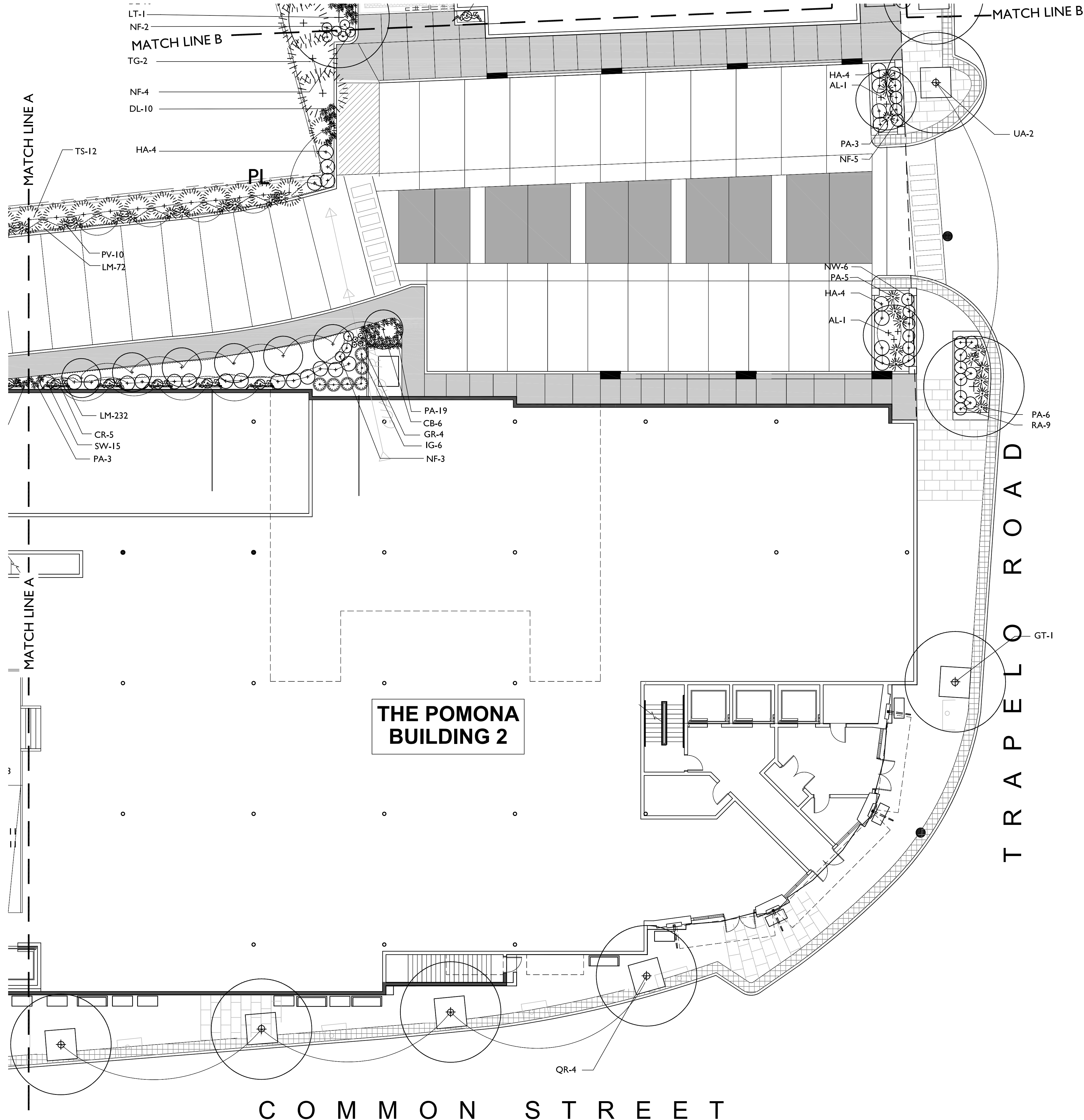

1 PLANTING PLAN 2 of 3
scale: 1"=10'-0"

See L-6 for PLANT LIST

PETER
QUINN
ARCHI
TECTS

ARCHITECTURE
PLANNING
COMMUNITY DESIGN

PETER QUINN ARCHITECTS LLC
1904 MASS AVE, 2ND FLOOR
CAMBRIDGE, MA 02140
PH 617-354-3989 FAX 617-968-0280

SEAL



CONSULTANT

Blair Hines Design
Associates
LANDSCAPE ARCHITECTS
318 Harvard Street Suite 25
Boston, MA 02114
P 617.725.1180
F 617.468.1825
BlairHinesDesignAssociates.com

CONSULTANT



PROJECT

CUSHING VILLAGE
CUSHING SQUARE
BELMONT, MA

PREPARED FOR



6 LITTLEFIELD ROAD
ACTON, MA 01720

DRAWING TITLE

Planting Plan

SCALE AS NOTED

REVISION	DATE
----------	------

SP REV-#3C	18 June 2013
------------	--------------

SP REV-2	31 May 2013
----------	-------------

DRAWN BY KP	REVIEWED BY BH
----------------	-------------------

SHEET

L-5

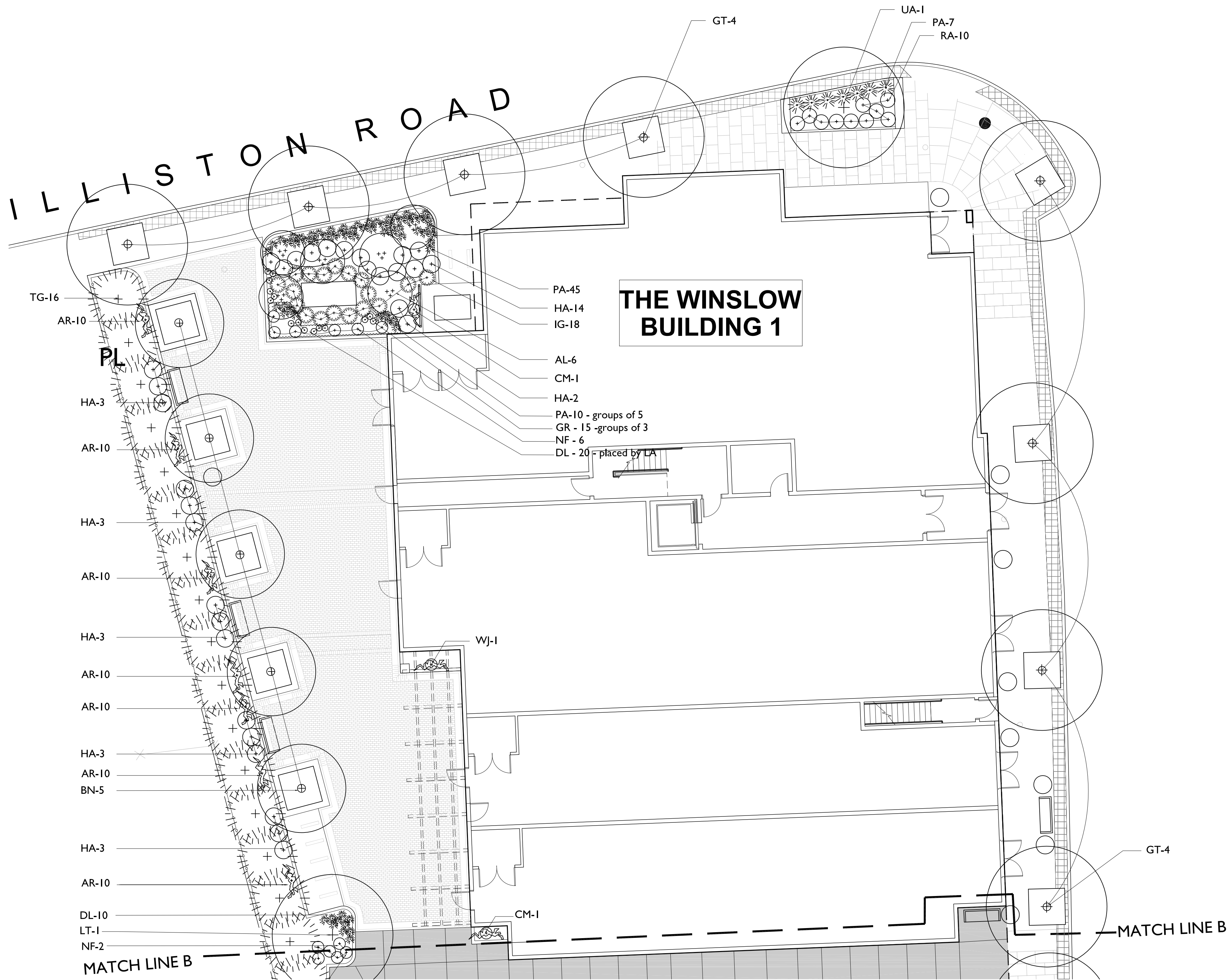

1 PLANTING PLAN 3 of 3
scale: 1"=10'-0"

PLANT LIST					
Key	Qty.	Botanical Name	Common Name	Min. Size	Notes:
Trees - Deciduous					
BN	5	Betula nigra 'Heritage'	River Birch	4 - 5" cal.	single stem
CB	6	Carpinus betulus 'Fastigiata'	Hornbeam	1.5-2" cal.	
GT	14	Gleditsia triacanthos 'Inermis' 'Skyline'	Thornless Honeylocust	4 - 5" cal.	
LT	1	Liriodendron tulipifera	Tulip Tree	4 - 5" cal.	
QR	9	Quercus rubrum	Red Oak	4 - 5" cal.	
SR		Syringa reticulata 'Ivory Silk'	Japanese Tree Lilac	2-2.5" cal.	
UA	5	Ulmus americana 'Valley Forge'	Am. Elm	4 - 5" cal.	B&B
Trees - Evergreen					
AC	1	Abies concolor	White Fir	6 - 7' ht.	
CL		Cupressocyparis leylandii	Leyland Cypress	7 - 8' ht.	
CN	1	Chamaecyparis nootkatensis 'Pendula'	Alaska Cedar	7 - 8' ht.	
PA	5	Picea abies	Norway Spruce	7 - 8' ht.	
PP	7	Picea pungens	Blue Spruce	6 - 7' ht.	
PS	2	Pinus strobus	White Pine	8 -10' ht.	
TG	19	Thuja plicata 'Green Giant'	Arborvitae	8 -10' ht.	
TG	1	Thuja plicata 'Green Giant'	Arborvitae	7 - 8' ht.	
TS	32	Thuja occidentalis 'Smaragd'	Arborvitae	7 - 8' ht.	ALT. Leyland Cypress
Ornamental Trees					
AL	10	Amelanchier leavis	Serviceberry	1.5-2" cal.	single stem
AP	1	Acer palmatum 'Bloodgood'	Red Japanese Maple	1.5-2" cal.	
Shrubs					
AK	10	Azalea - Karen	Lavender Evergreen Azalea	#3 18-24"	
BS	6	Buxus sempervirens 'Green Gem'	Boxwood	18" ht.	
CA		Clethra alnifolia	Summersweet	2 Gal	
CS	1	Cornus sericea	Red-twigged Dogwood	30" ht.	
CP		Corylus maxima 'Purpurea'	Hazelnut	48"-60"	
FG	24	Fothergilla gardenii	Dwarf Fothergilla	24"-30"	
HA	51	Hydrangea arborescens 'Annabelle'	Annabelle Hydrangea	2 Gal	
HQ	10	Hydrangea quercifolia	Oakleaf Hydrangea	3 - 3.5'	
IG	28	Ilex glabra 'Compacta'	Dwarf Inkberry Holly	24"-30"	
IMB	4	Ilex meserveae 'Blue Boy'	Blue Boy Holly	30-36"	
IMG	36	Ilex meserveae 'Blue Girl'	Blue Girl Holly	30-36"	
IR	3	Ilex verticillata 'Red Sprite'	Winterberry	30-36"	
PM		Pinus mugo 'Pumilio'	Dwarf Mugo Pine	#5 24-30"	
RA	29	Rhus aromatica 'Lo Gro'	Lo Gro Sumac	1 Gal	
RP	7	Rhododendron catawbiense 'Boursault'	Violet Rhododendron	30-36"	
SJ	9	Spiraea japonica 'Little Princess'	Little Princess Spirea	15"-18"	
SP	7	Syringa p. 'Miss Kim'	Miss Kim Lilac	24"-30"	
SV	9	Syringa vulgaris	Common Lilac	4-5' ht.	mixed colors
SV	18	Spiraea bumalda 'Anthony Waterer'	Anthony Waterer Spirea	18"-24"	2 Gal
VD	6	Viburnum dentatum 'Blue Muffin'	Compact Viburnum	36" ht.	
Vines					
CM	4	Clematis maximowicziana	Autumn Clematis	2 Gal.	
CR	11	Clematis 'Montana Rubens'	Clematis	2 Gal.	
CR		Campsis radicans	Trumpet creeper Vine	2 Gal.	
HP		Hydrangea paniculata	Climbing Hydrangea	2 Gal.	
WF		Wisteria floribunda	Japanese Wisteria	2 Gal.	
Perennials, Groundcovers, Ferns					
AC		Astilbe 'Amethyst'	Plume Flower		
AR	70	Ajuga reptans 'Bronze Beauty'	Ajuga		
CF		Echinacea purpurea 'Kims Knee High'	Dwarf Coneflower	#2 pots	
DP	23	Dennstaedtia punctilobula	Hay-scented Fern		
EP		Echinacea purpurea 'Magnus'	Coneflower		
GM	11	Geranium macrorrhizum 'Bevan's Variety'	Geranium		
GR	19	Geranium x 'Rozanne'	Blue Geranium		
HF		Hemerocallis 'Happy Returns'	Daylily	#2 pots	
HMA	3	Hakonechloa macra 'Aureola'	Japanese Forest Grass	1 gal pots	
HP		Heuchera 'Palace Purple'	Red Coralbell	1 gal pots	15" o.c.
HS	3	Hosta sieboldiana 'Elegans'	Large Blue Hosta		
JPF	54	Athyrium niponicum 'picatum'	Japanese Painted Fern	1 gal pots	15" o.c.
LM	301	Liriope muscari 'Royal Purple'	Lily Turf		
MS	7	Miscanthus sinensis 'Morning Light'	Miscanthus		
NF	50	Nepeta faassenii 'Walker's Low'	Catmint	2 gal pots	
PA	118	Pennisetum alopecuroides 'Hameln'	Dwarf Fountain Grass	#2 pots	
PT		Pachysandra terminalis - Green Sheen	Pachysandra	4" pots	
PV	20	Panicum virginicas	Shenandoah		
RG		Rudbeckia goldsturm	Black Eyed Susan	1 gal pots	
SA		Sedum 'Autumn Joy'	Sedum		
SE		Sedum mats	Pre-grown 'sod' of variety of Sedums for greenroof		
TC	37	Tiarella cordifolia 'Running Tapestry'	Foamflower	1 gal pots	
YF		Yucca filamentosa	Hardy Yucca	#2 pots	

PETER
QUINN
ARCHI
TECTS

ARCHITECTURE
PLANNING
COMMUNITY DESIGN

PETER QUINN ARCHITECTS LLC
1904 MASS AVE, 2ND FLOOR
CAMBRIDGE, MA 02140
PH 617-354-3989 FAX 617-868-0280

SEAL



CONSULTANT

Blair Hines Design
Associates
LANDSCAPE ARCHITECTS
218 Harvard Street, Suite 21
Brookline, MA 02146
p 617.733.1880
f 617.608.5023
BlairHinesDesignAssociates.com

CONSULTANT



PROJECT

CUSHING VILLAGE
CUSHING SQUARE
BELMONT, MA

PREPARED FOR



6 LITTLEFIELD ROAD
ACTON, MA 01720

DRAWING TITLE

Planting Plan

SCALE AS NOTED

REVISION

DATE

SP REV-#3C 18 June 2013

SP REV-2 31 May 2013

DRAWN BY
KP

REVIEWED BY
BH

SHEET

L-6

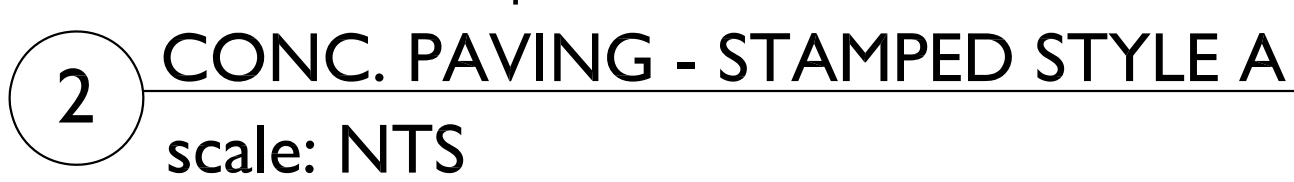
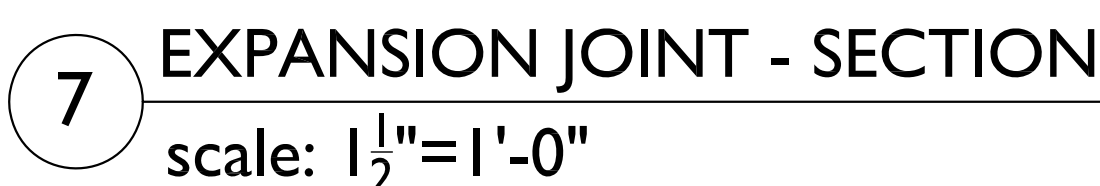
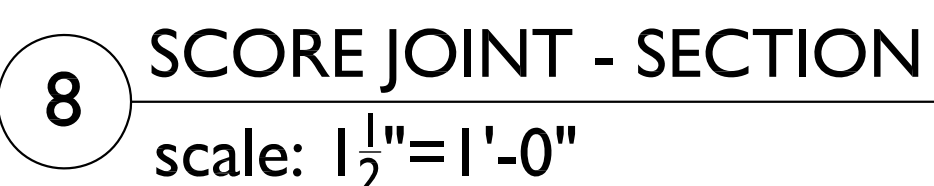
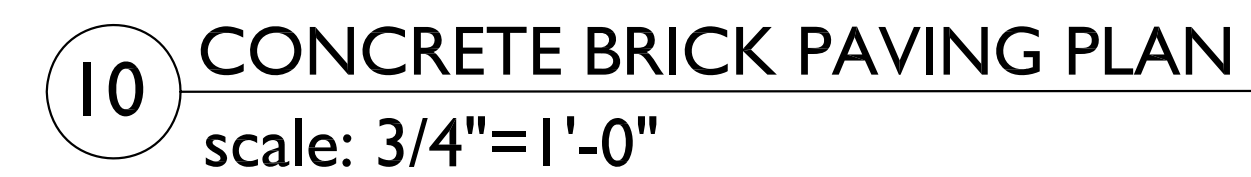

L-7

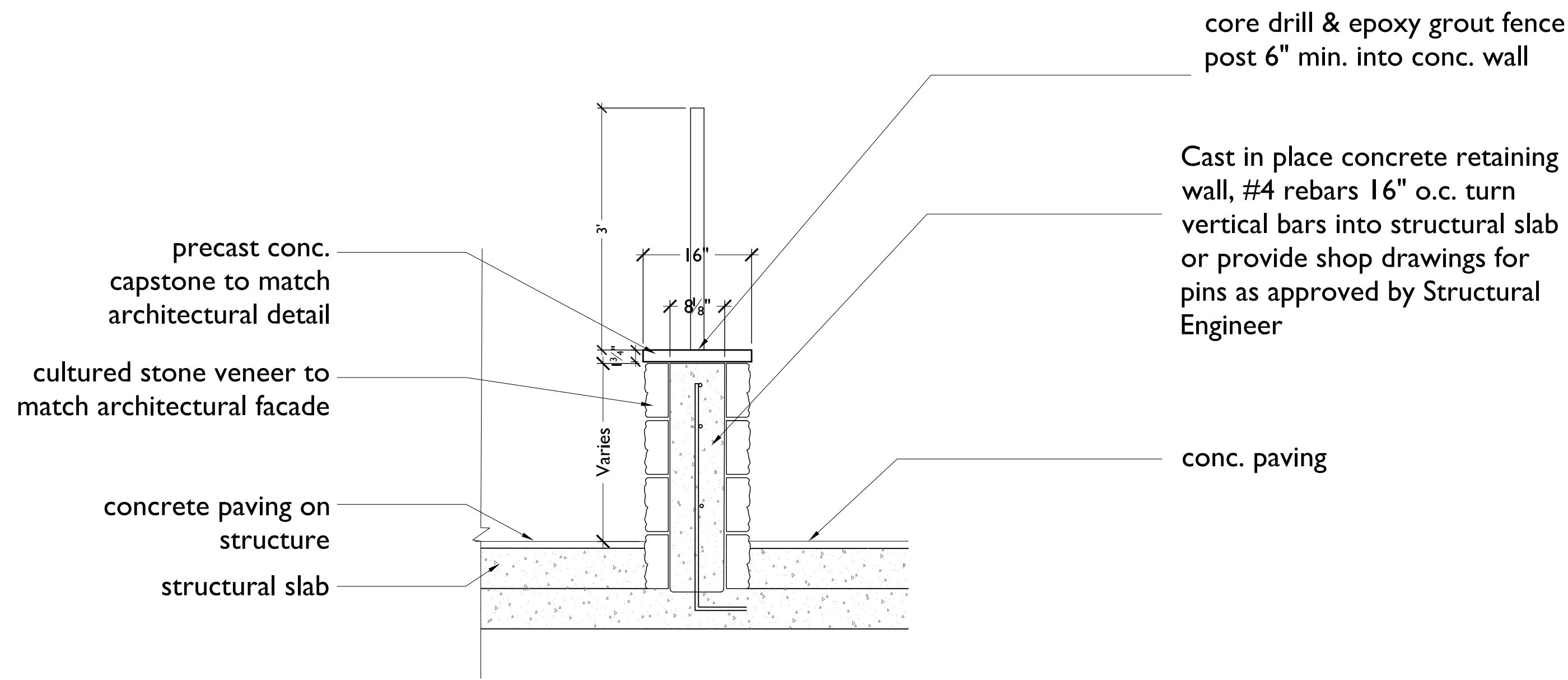

10 DECORATIVE METAL FENCE - SECTION
scale: 3/4"=1'-0"

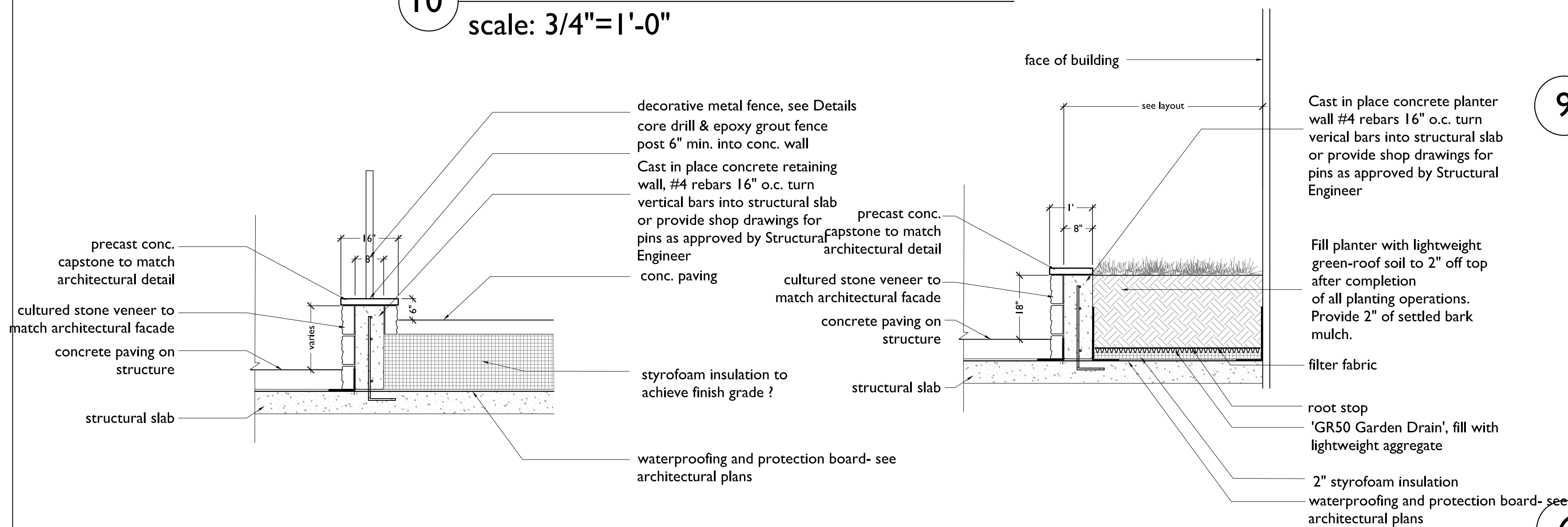

8 RETAINING WALL W/ FENCE - SECTION
scale: 1/2"=1'-0"

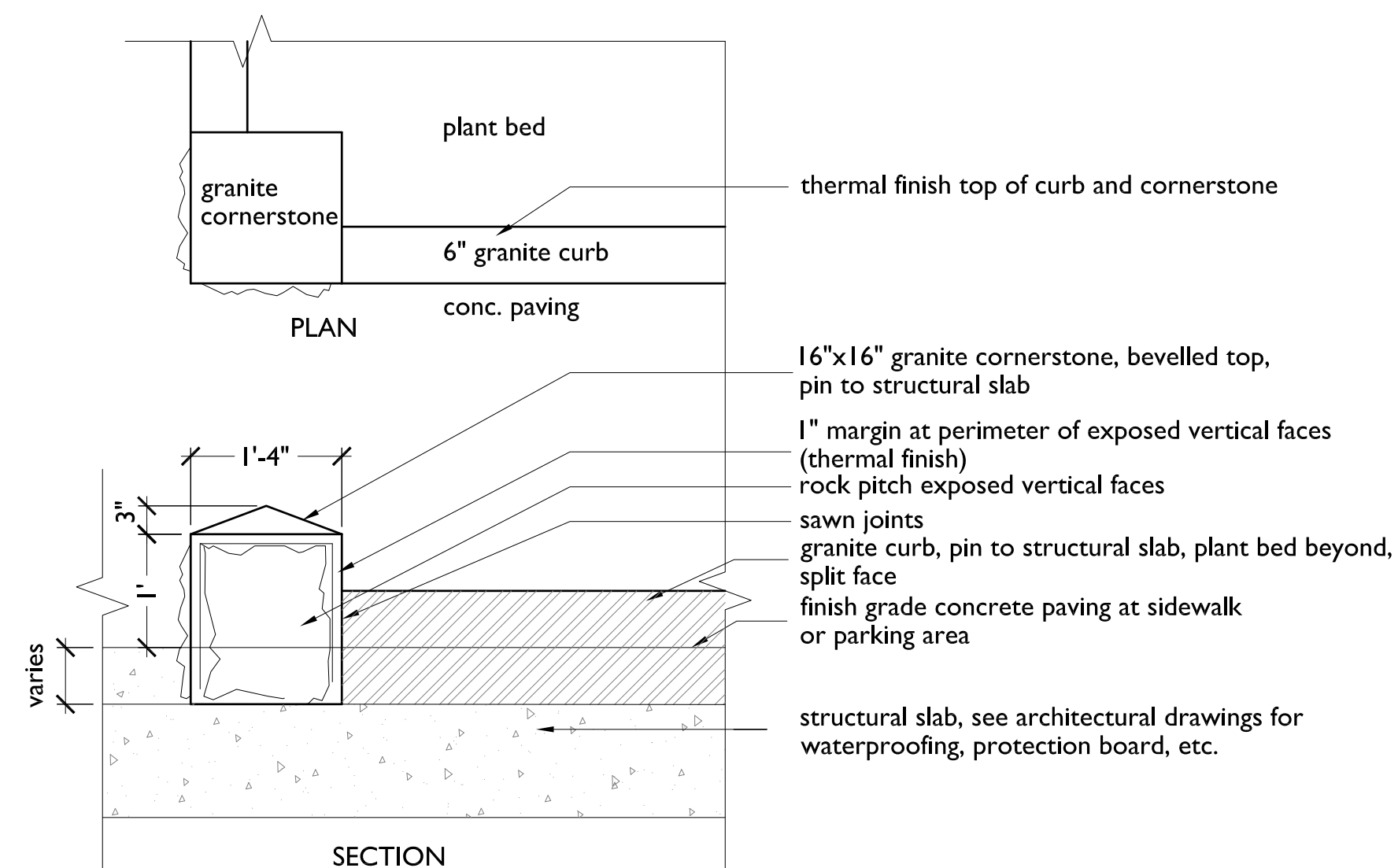

4 GRANITE CORNERSTONE
scale: 3/4"=1'-0"

7 SEATWALL - SECTION
scale: 3/4"=1'-0"

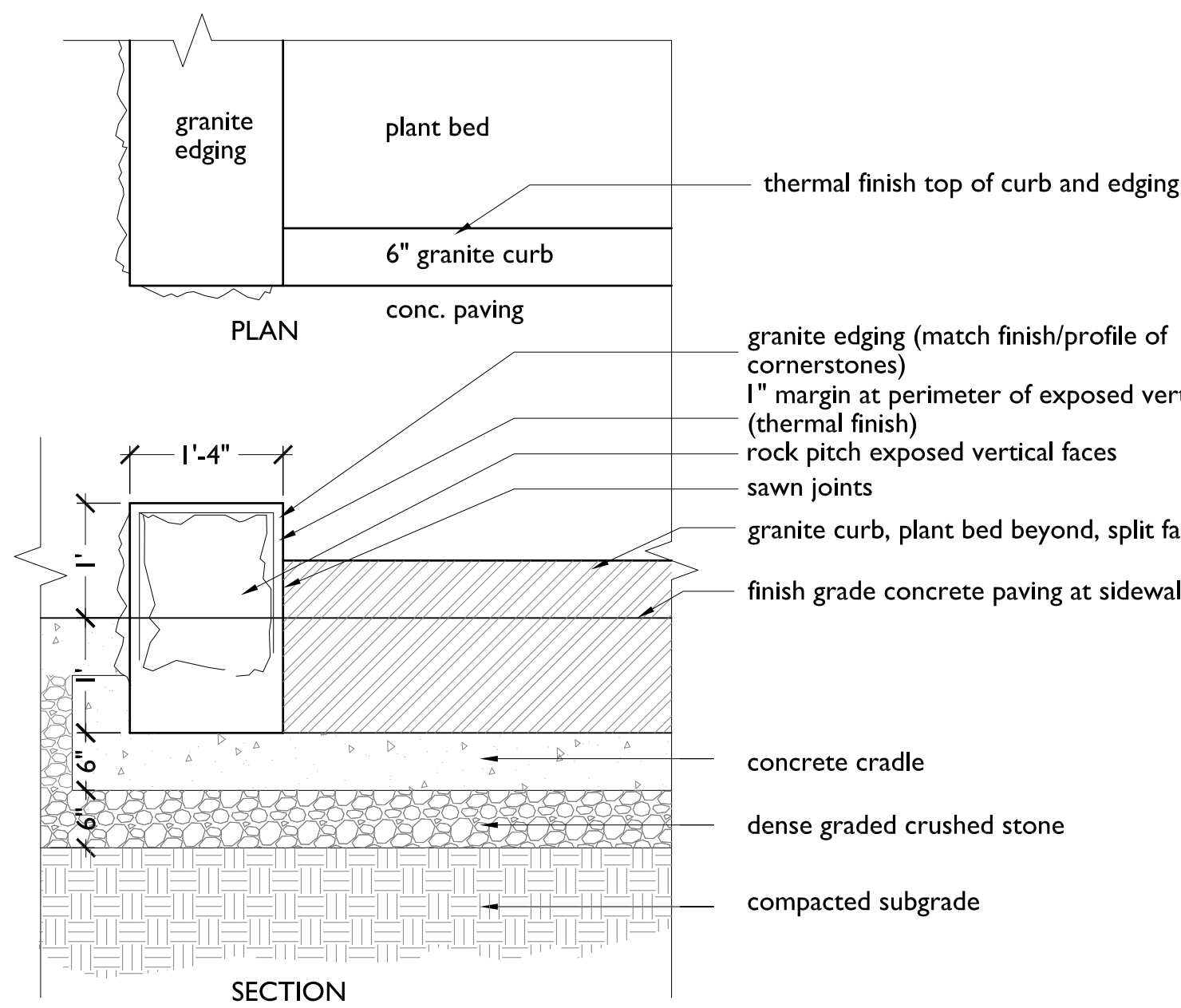

3 GRANITE EDGING AT PLANTER
scale: 3/4"=1'-0"

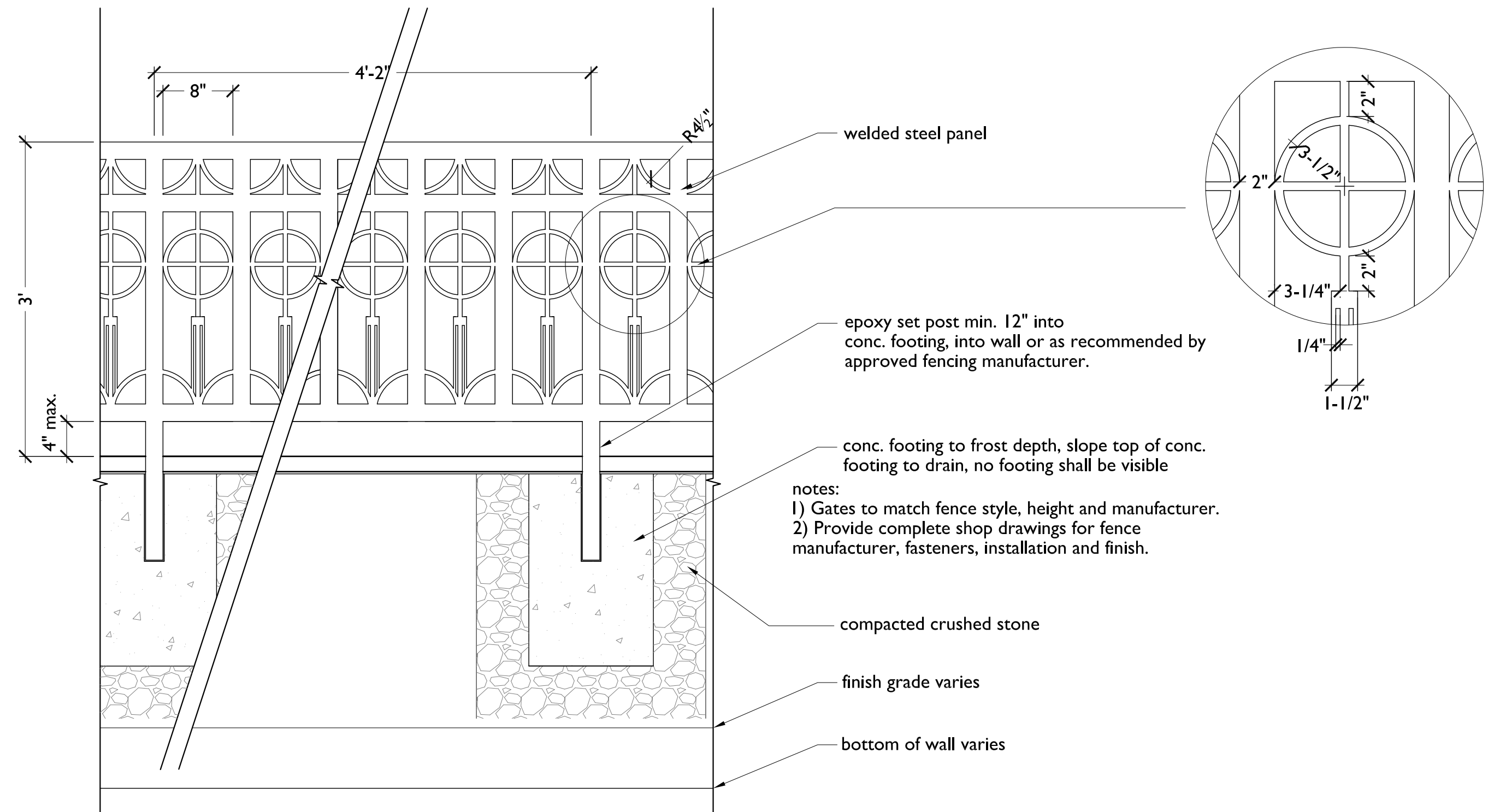

9 DECORATIVE METAL FENCE ELEVATION
scale: 1" = 1'-0"

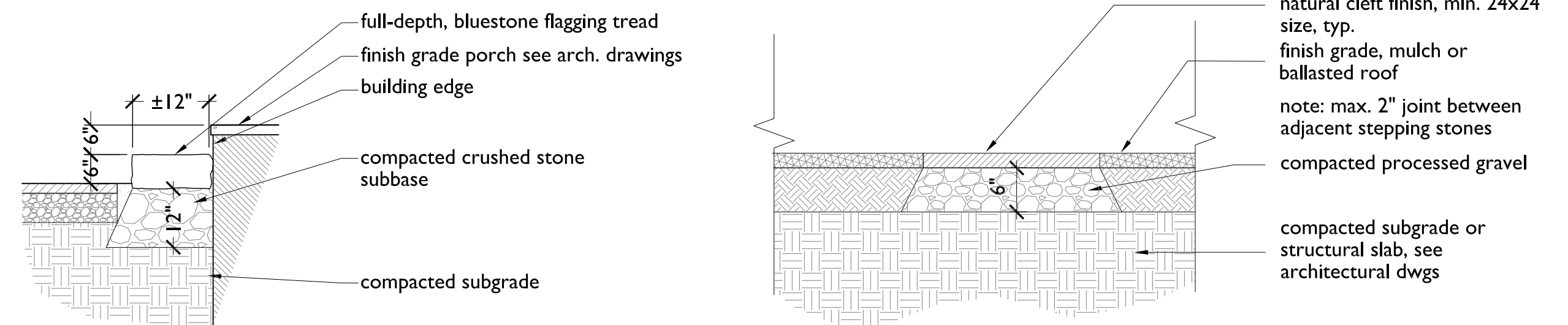

6 STONE FLAGGING STEPS - SECTION
scale: 1/2"=1'-0"

5 BLUESTONE STEP STONES - SECTION
scale: 3/4"=1'-0"

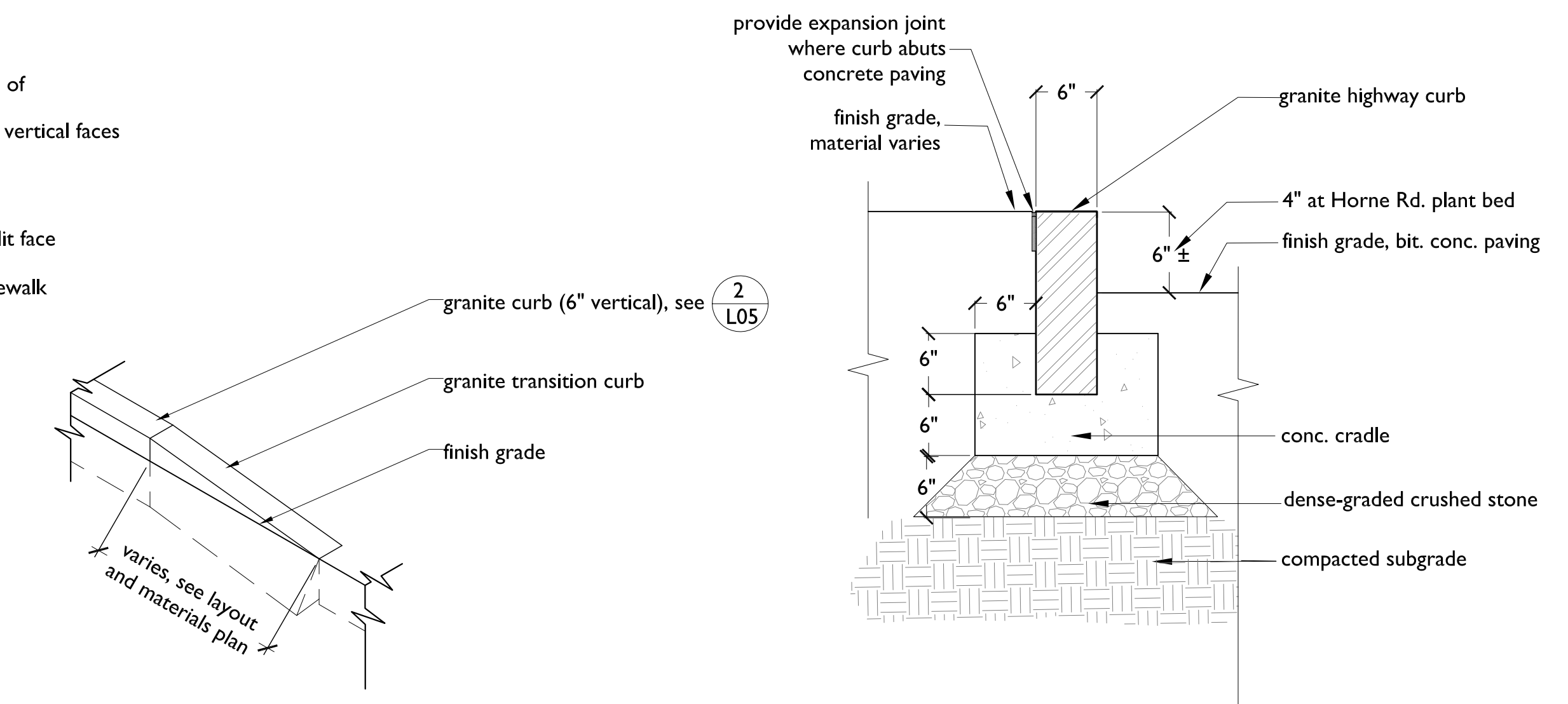

2 GRANITE TRANSITION CURB - ISO
scale: 3/8"=1'-0"

1 6" GRANITE CURB - SECTION
scale: 1"=1'-0"

PETER
QUINN
ARCHI
TECTS

ARCHITECTURE
PLANNING
COMMUNITY DESIGN

PETER QUINN ARCHITECTS LLC
1904 MASS AVE, 2ND FLOOR
CAMBRIDGE, MA 02140
PH 617-354-3989 FAX 617-968-0280

SEAL



CONSULTANT

Blair Hines Design
Associates
LANDSCAPE ARCHITECTS
318 Harvard Street, Suite 25
Boston, MA 02114
P 617-251-1180
F 617-443-8222
BlairHinesDesignAssociates.com

CONSULTANT



PROJECT

CUSHING VILLAGE
CUSHING SQUARE
BELMONT, MA

PREPARED FOR



6 LITTLEFIELD ROAD
ACTON, MA 01720

DRAWING TITLE

Details

SCALE AS NOTED

REVISION	DATE
SP REV-2	31 May 2013
DRAWN BY KP	REVIEWED BY BH
SHEET	

L-8

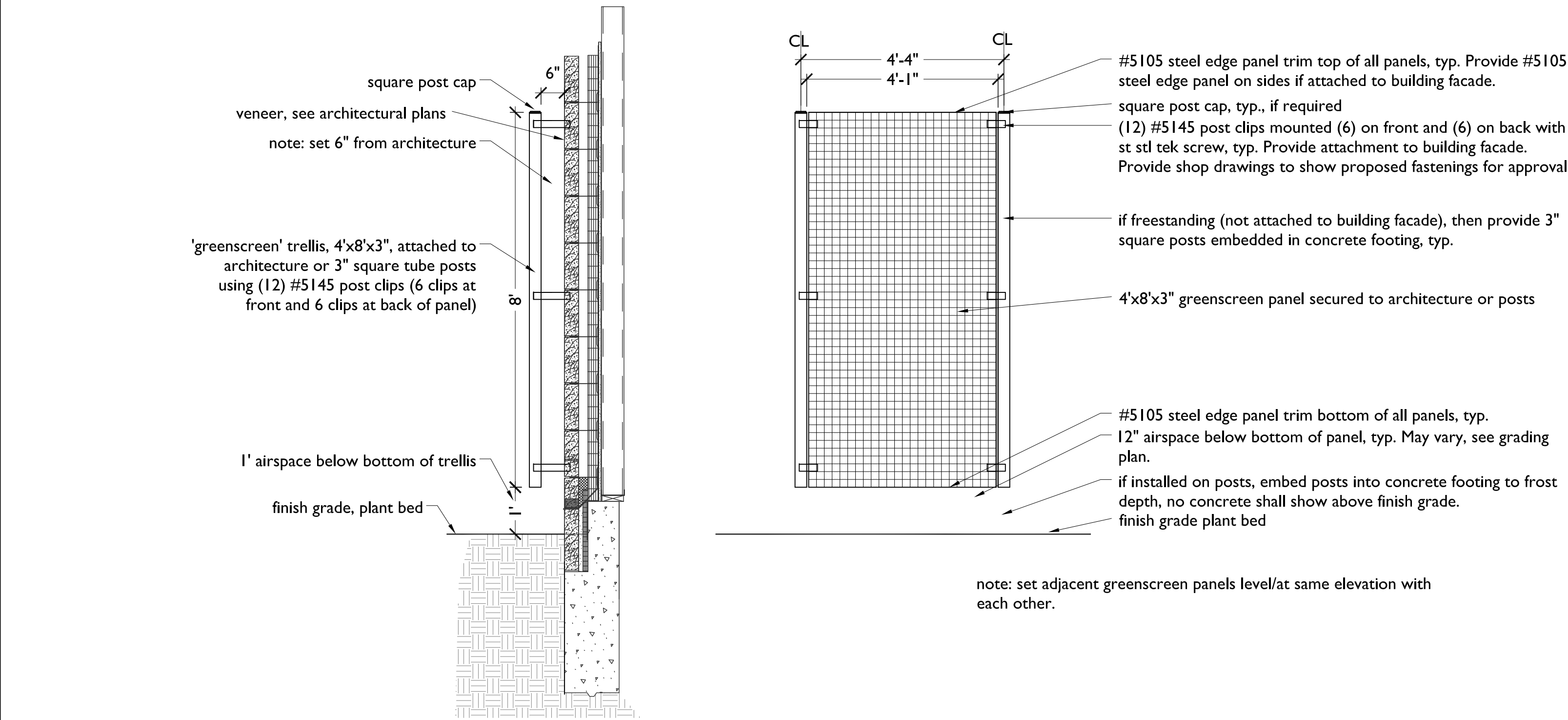

10 GREENSCREEN - TYPICAL
scale: 1/2"=1'-0"

NOTE:
Where layout notes 4' ht.,
omit 2' lattice

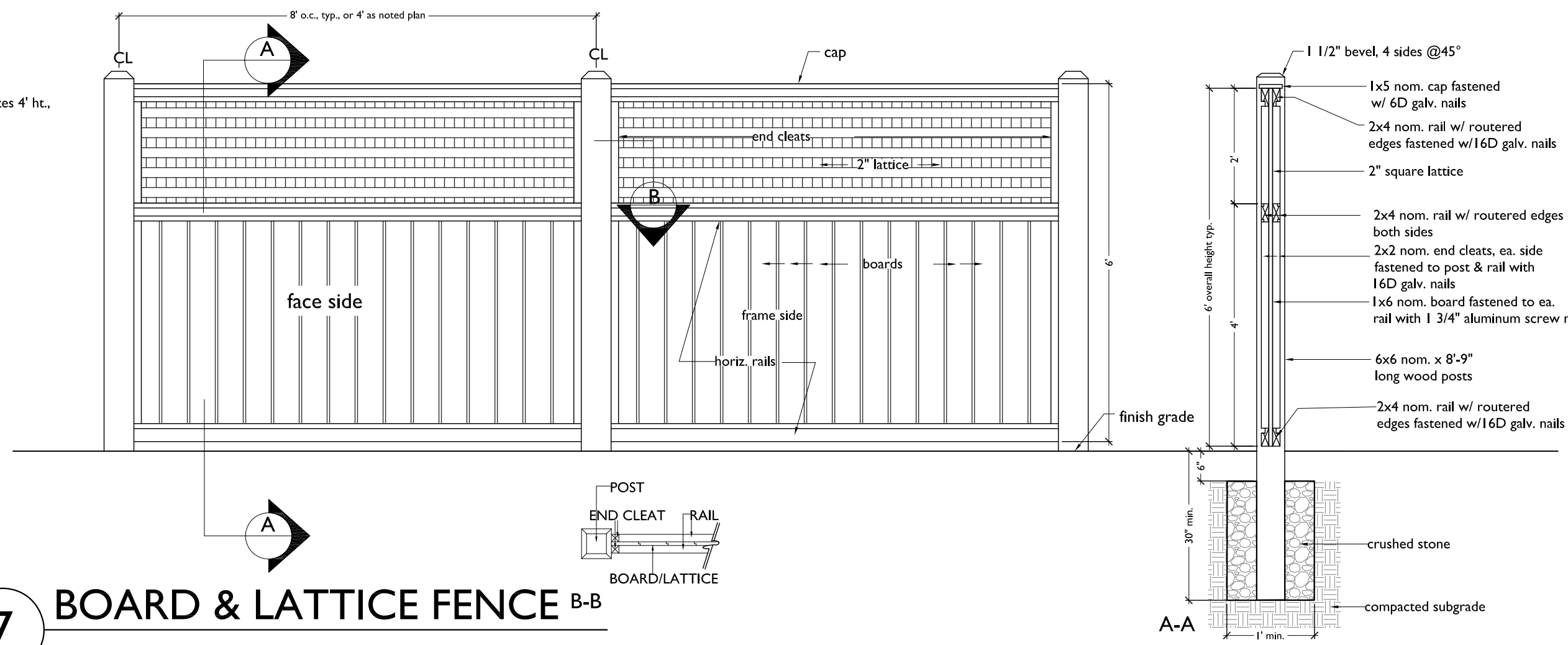

7 BOARD & LATTICE FENCE
scale: 1/2"=1'-0"

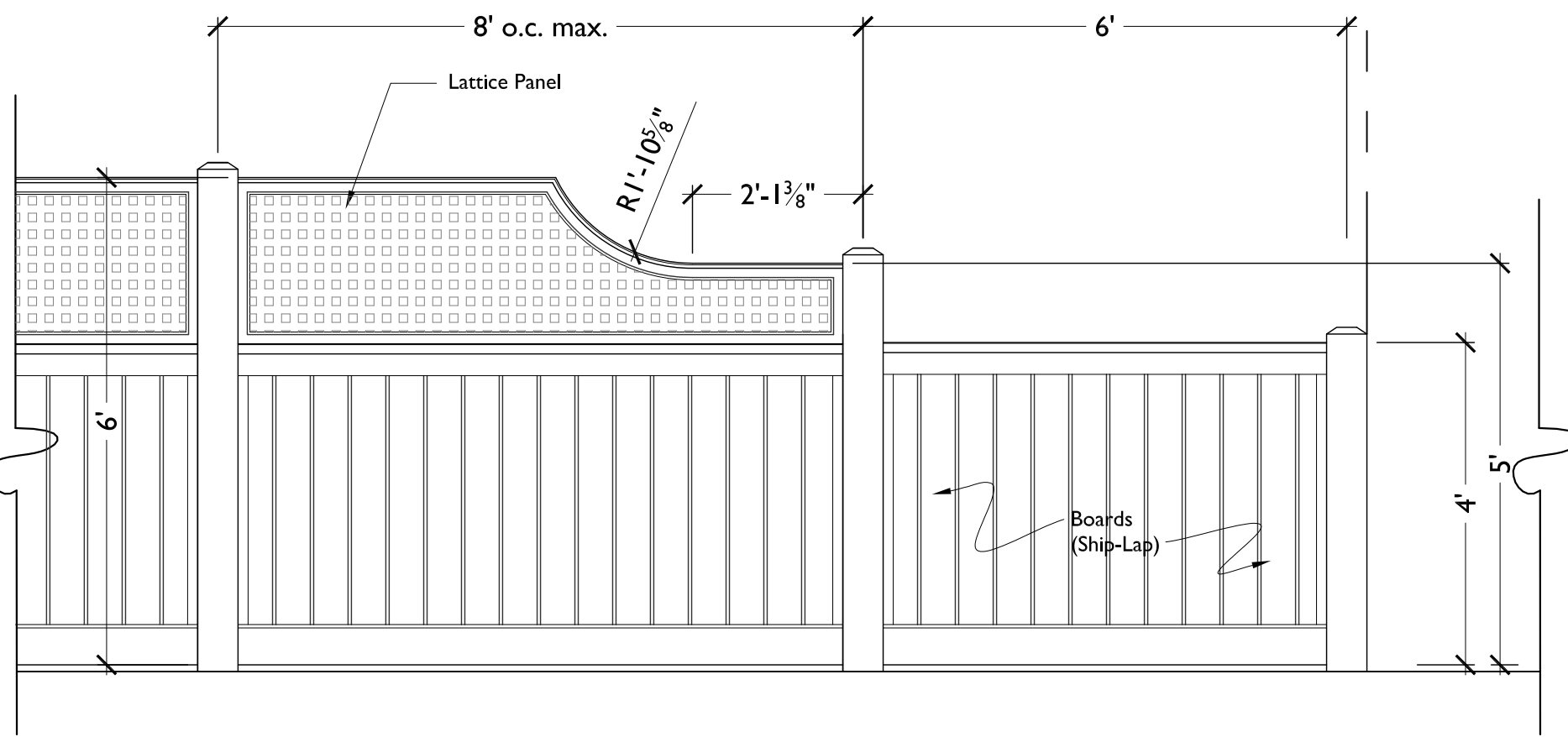

6 TRANSITION FENCE PANEL
scale: 1/2"=1'-0"



8 SHADOWBOX FENCE
NTS

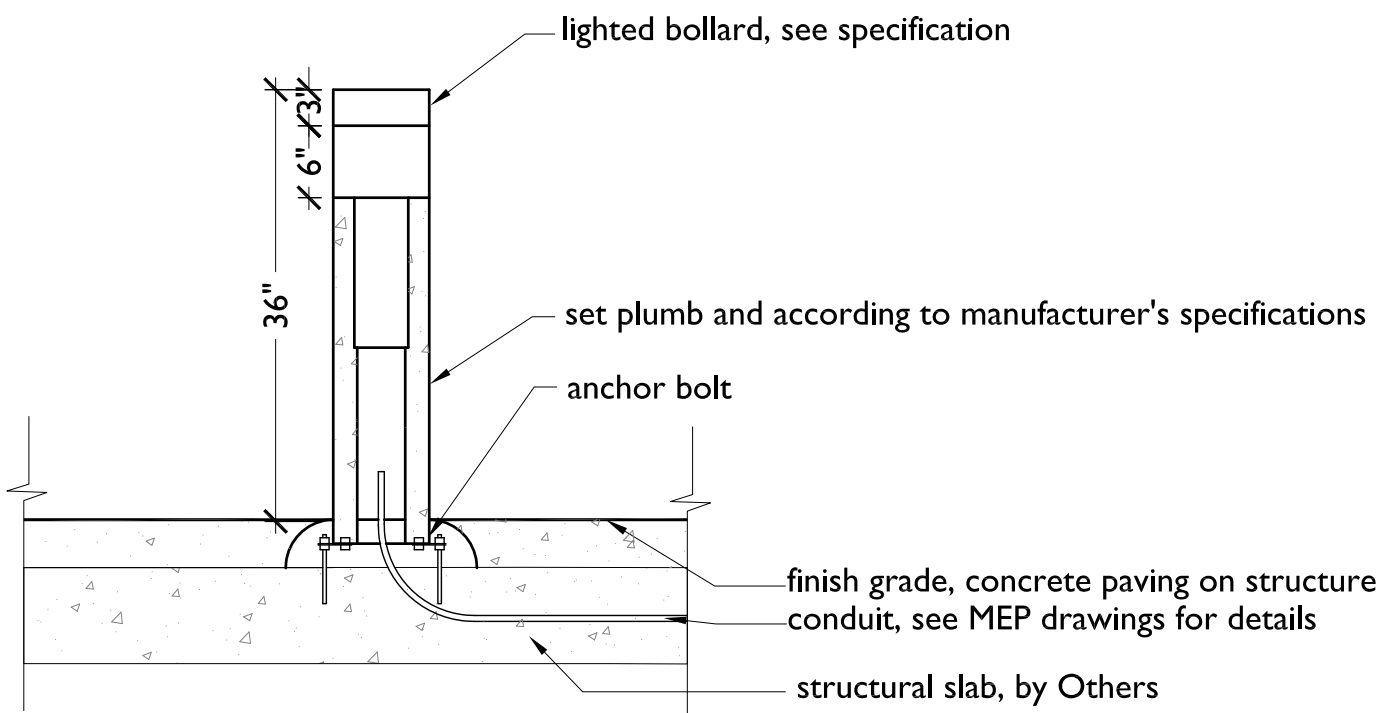

5 BOLLARD - See LT (Lighting Plans)
scale: 3/4"=1'-0"

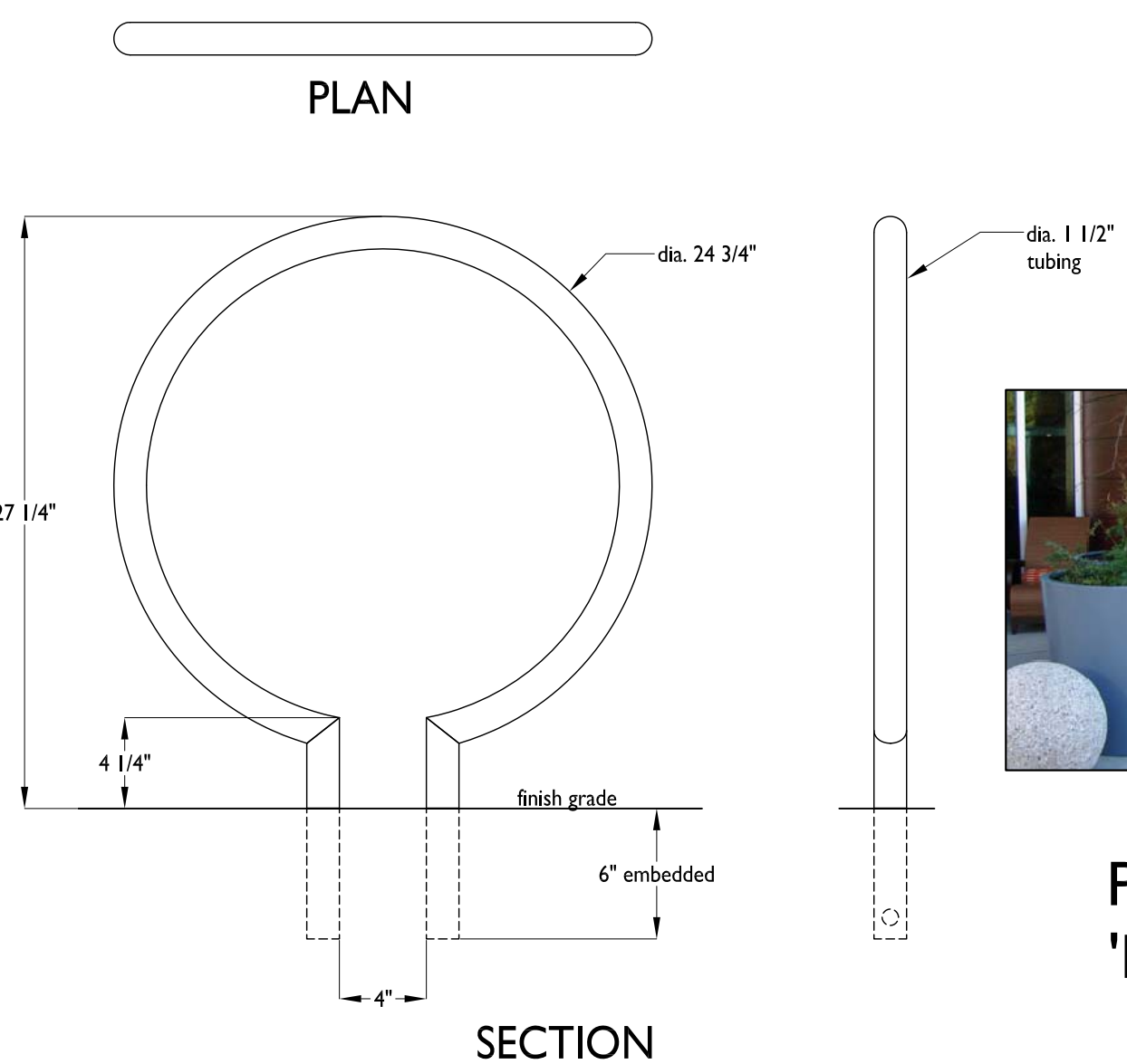

4 BIKE RACK
scale: 3/4"=1'-0"



Planters: 36" Round and 2'x4' Rectangular in 'Urban' style & 'Metro' styles. Available: Tournesol Siteworks

3 PLANTERS AT STREETScape
NTS

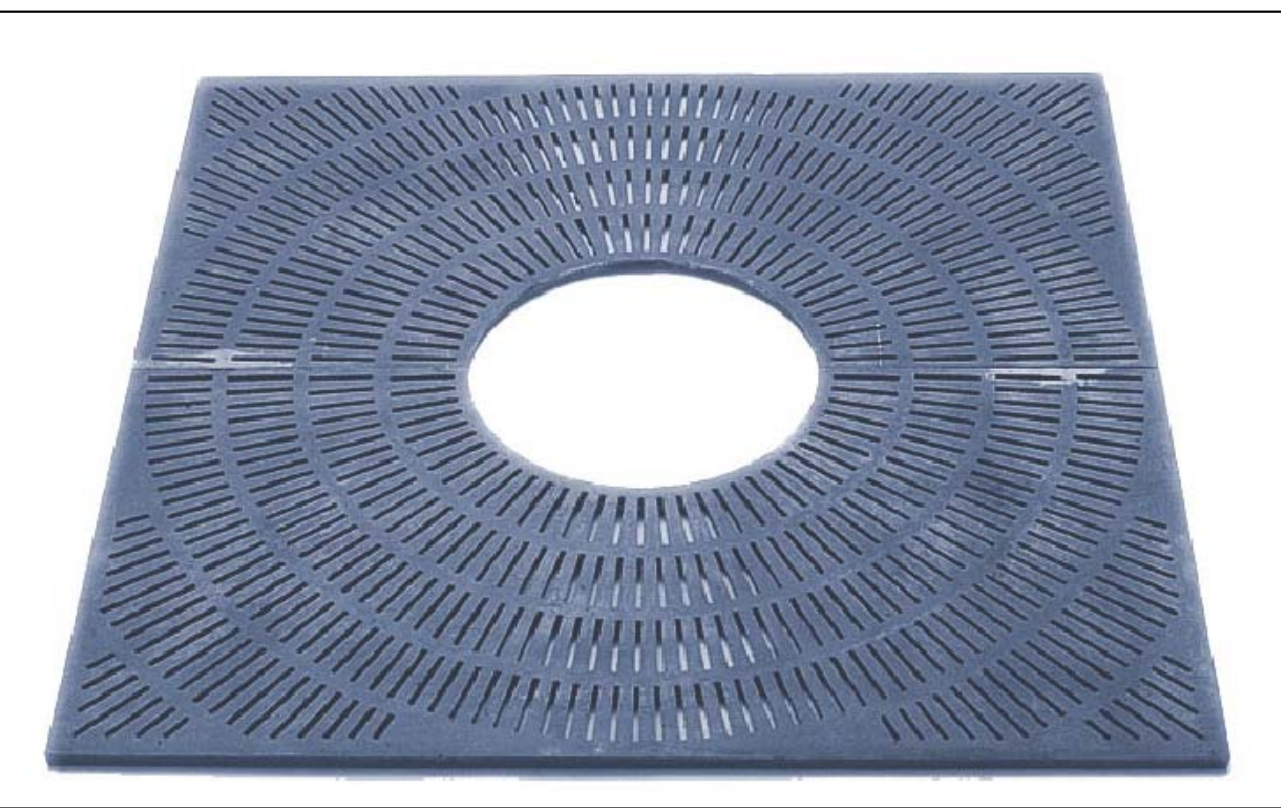

Tree Grate: 'Kiva' style 6'x6'
Available: Urban Accessories

2 TREE GRATE
NTS

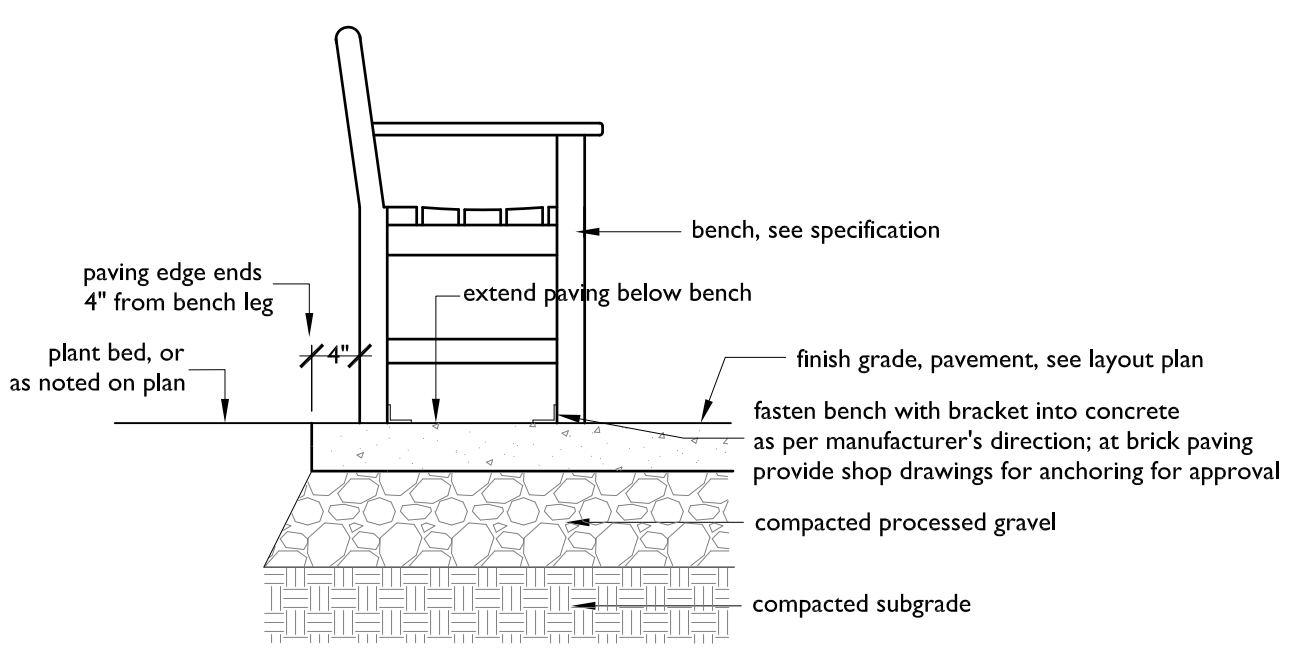

1 BENCH
3/4" = 1'-0"

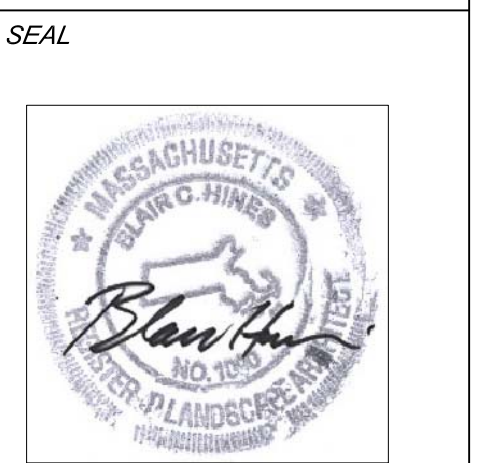

CONSULTANT
Blair Hines Design
Associates
LANDSCAPE ARCHITECTS
318 Harvard Street, Suite 25
Boston, MA 02114
P 617-725-1180
F 617-483-8252
BlairHinesDesign.com

CONSULTANT
LINE
COMPANY
ARCHITECTS
Incorporated

PROJECT
CUSHING VILLAGE
CUSHING SQUARE
BELMONT, MA

PREPARED FOR
SMITH
LEGACY
PARTNERS
6 LITTLEFIELD ROAD
ACTON, MA 01720

DRAWING TITLE

Details

SCALE AS NOTED	
REVISION	DATE
SP REV-#3C	18 June 2013
SP REV-2	31 May 2013
DRAWN BY KP	REVIEWED BY BH
SHEET	

SEAL

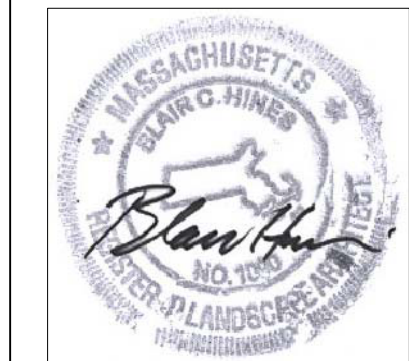

CONSULTANT

Blair Hines Design
Associates
LANDSCAPE ARCHITECTS
318 Hoped Street, Suite 25
Boston, MA 02108
P 617.725.1180
F 617.468.1025
BlairHinesDesignAssociates.com

CONSULTANT



PROJECT

CUSHING VILLAGE
CUSHING SQUARE
BELMONT, MA

PREPARED FOR



6 LITTLEFIELD ROAD
ACTON, MA 01720

DRAWING TITLE

Details

SCALE AS NOTED

REVISION	DATE
SP REV-2	31 May 2013
DRAWN BY KP	REVIEWED BY BH

SHEET

L-10

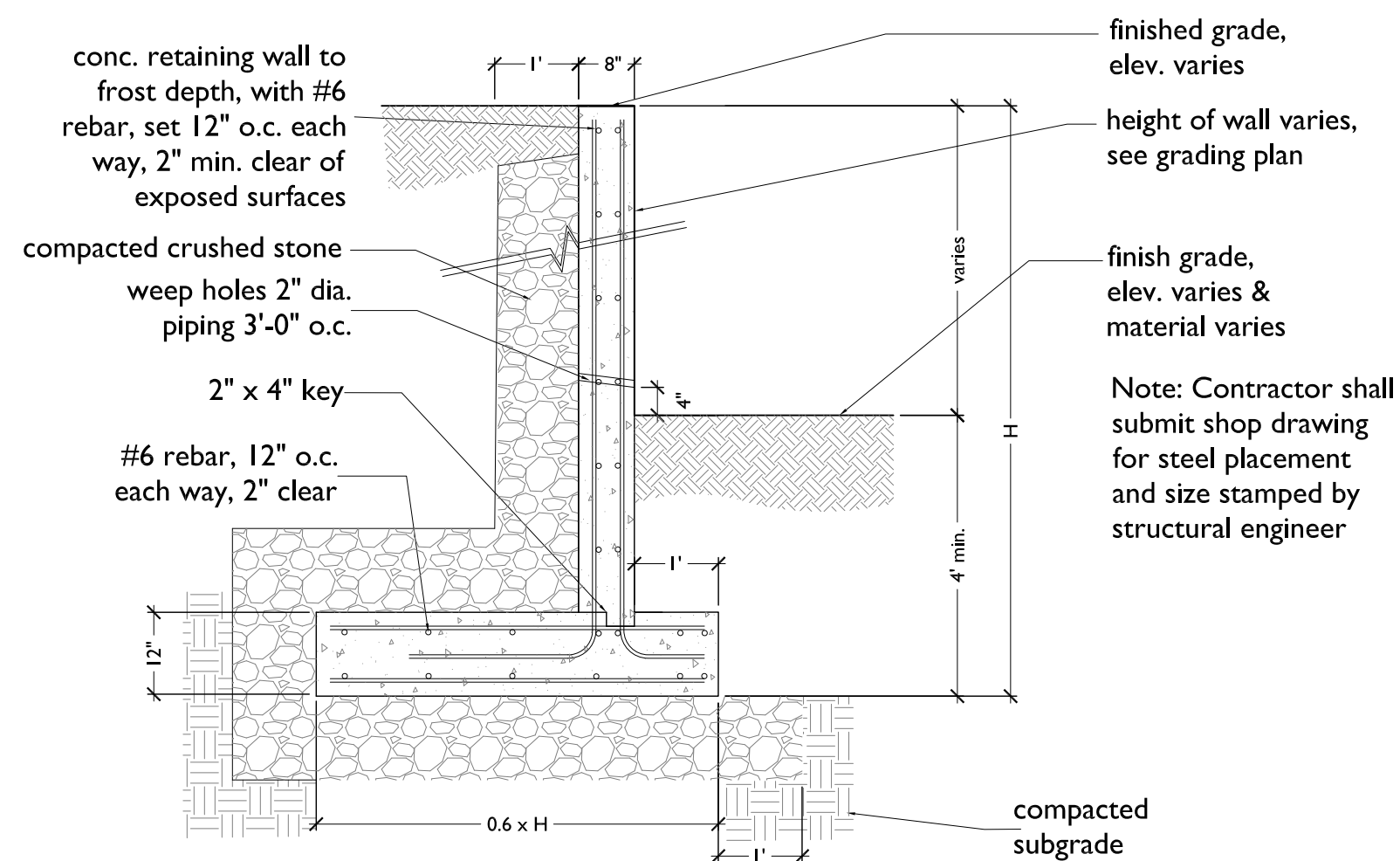

2 CONCRETE RETAINING WALL - SECTION
1/2" = 1'-0"

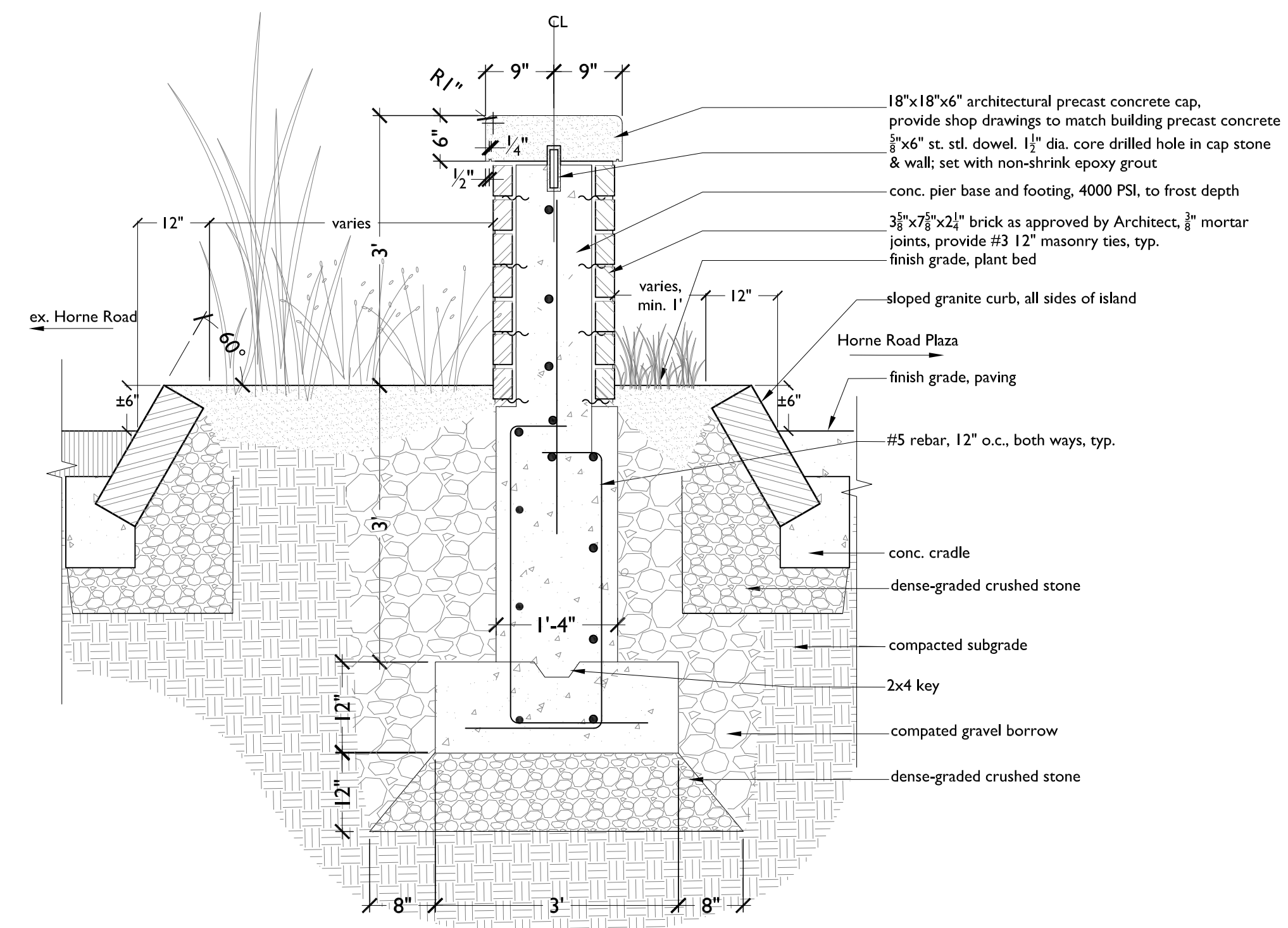

1 SLOPED CURB & BRICK PIER AT PLANT BED
3/4" = 1'-0"

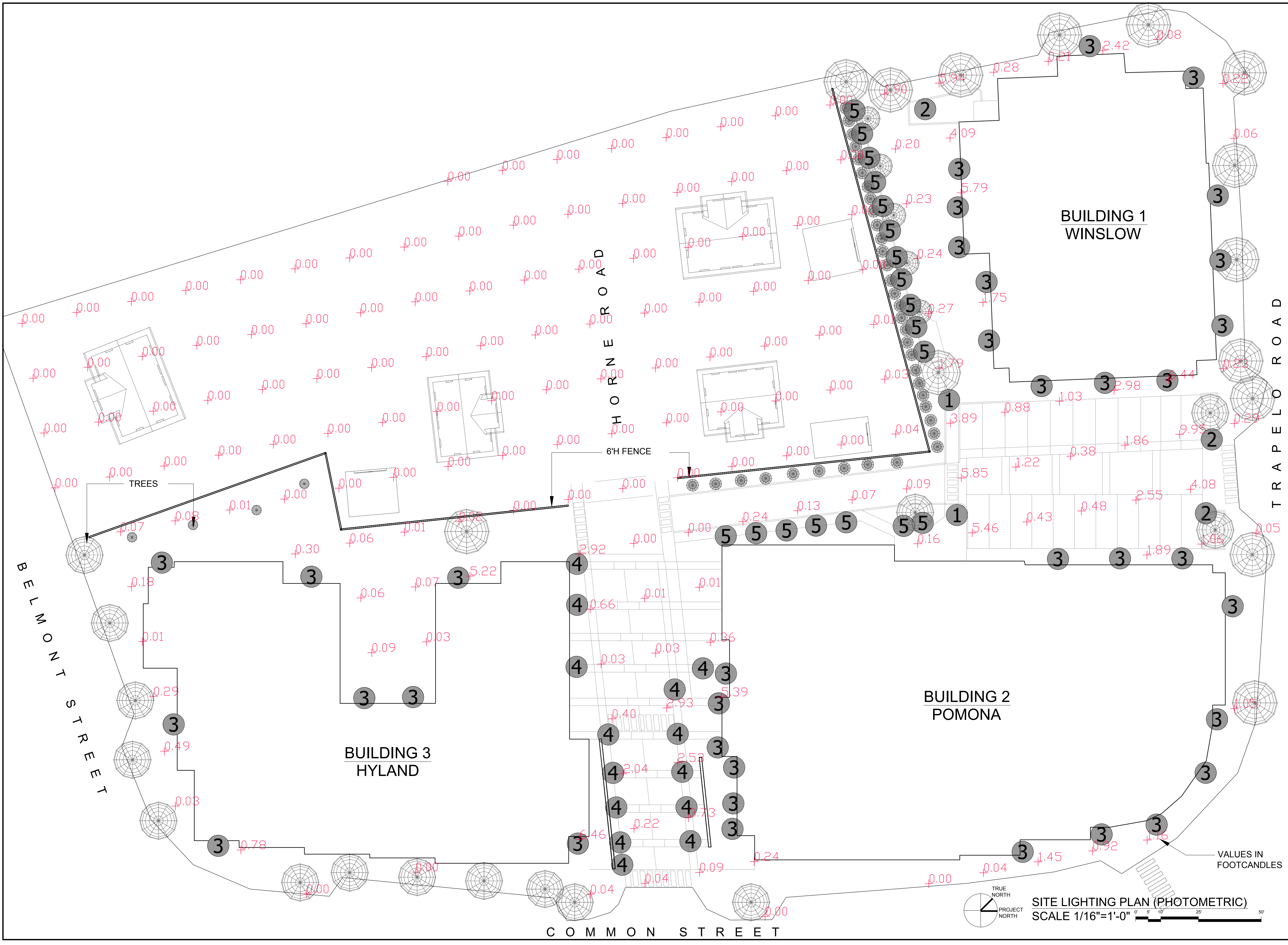

PETER QUINN ARCHITECTS
ARCHITECTURE
PLANNING
COMMUNITY DESIGN

PETER QUINN ARCHITECTS LLC
1904 MASS AVE, 2ND FLOOR
CAMBRIDGE, MA 02140
PH 617-354-3989 FAX 617-868-0280

SEAL

CONSULTANT

CONSULTANT

PROJECT

CUSHING VILLAGE
CUSHING SQUARE
BELMONT, MA

PREPARED FOR

6 LITTLEFIELD ROAD
ACTON, MA 01720

DRAWING TITLE

LIGHTING
CALCULATION

SCALE AS NOTED

REVISION	DATE

SP REVS

5 MAR 2013

DRAWN BY

CY

REVIEWED BY

PQ

SHEET

LT-1

VALUES IN
FOOTCANDLES

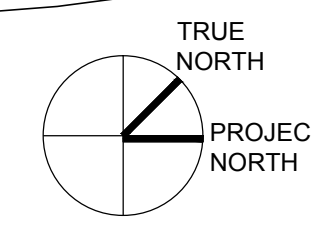

SITE LIGHTING PLAN (PHOTOMETRIC)
SCALE 1/16"=1'-0"

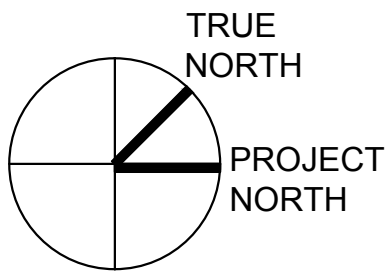
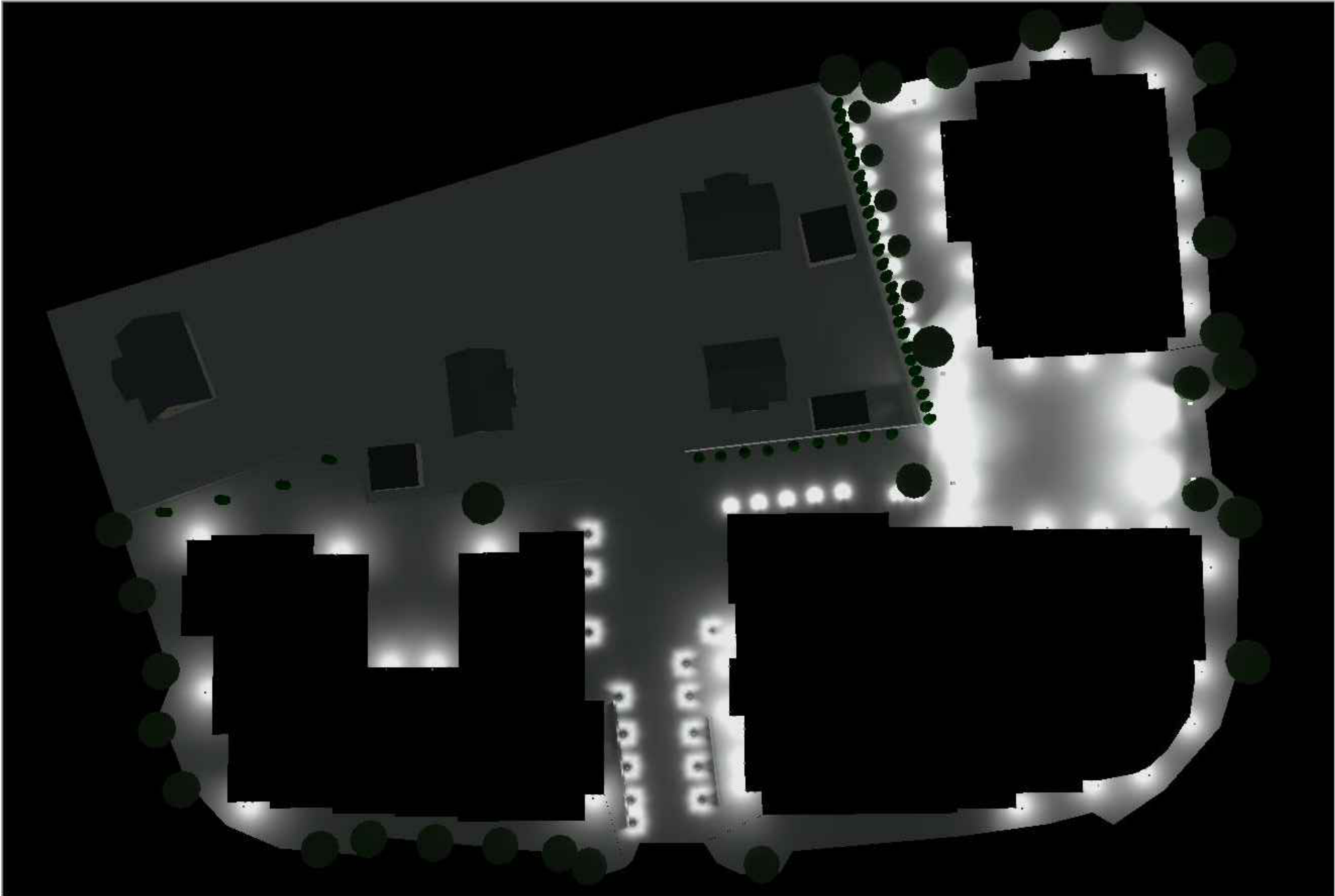

LIGHTING VALUE DRAWING

Note - Existing background light not shown (street lights, off-site buildings, as well as low-level decorative lights)

Pieces	Designation	
1	1. AREA LIGHT ON 12' POLE KIM LIGHTING: AR2-120LED-5100K - ARCHETYPE LED DIE-CAST ALUMINUM HOUSING AND LENS FRAME. - FLAT GLASS LENS. - LED EMITTER DECK INCLUDES CONSTANT CURRENT LEDS, HEATSINKS, AND REFLECTORS.	
2	2. AREA LIGHT ON 12' POLE KIM LIGHTING: AR4-120LED-4200K - ARCHETYPE LED DIE-CAST ALUMINUM HOUSING AND LENS FRAME. - FLAT GLASS LENS. - LED EMITTER DECK INCLUDES CONSTANT CURRENT LEDS, HEATSINKS, AND REFLECTORS.	
3	3. BUILDING MOUNT AT 7'-8" H KIM LIGHTING: SW1-18LED-3500K SITE - WALLFORM LED DIE CAST ALUMINUM UPPER HOUSING AND BASE. - LED BOARDS AND BRACKETS MOUNTED IN HOUSING. - CLEAR FLAT GLASS LENS.	
36	4. BOLLARD 3'-6" H KIM LIGHTING: VRB1-15LED-5100K - VANDAL RESISTANT ROUND BOLLARD LED. - THREE 5-LED BOARDS FOR A TOTAL OF 15-LED. - DARK BRONZE CAST ALUMINUM DOME AND LOUVERS. - ATTACHED TO AN ALUMINUM RISER. - TEMPERED PRISMATIC GLASS.	
14	5. PATH LIGHT AT 3' H MP LIGHTING: L97-2W30S60-MA - LED INPUT VOLTAGE: 24V DC - POWER CONSUMPTION: 8W/18W - MOUNTS TO 36" OR 48" ANODIZED ALUMINUM POST. - COMES WITH 24" CABTIRE LEAD INSIDE POST.	

PETER QUINN ARCHITECTS
ARCHITECTURE
PLANNING
COMMUNITY DESIGN

PETER QUINN ARCHITECTS LLC
1904 MASS AVE, 2ND FLOOR
CAMBRIDGE, MA 02140
PH 617-354-3989 FAX 617-868-0280

SEAL

CONSULTANT

LINE
COMPANY
ARCHITECTS
Incorporated

CONSULTANT

PROJECT

CUSHING VILLAGE
CUSHING SQUARE
BELMONT, MA

PREPARED FOR

SMITH LEGACY PARTNERS

6 LITTLEFIELD ROAD
ACTON, MA 01720

DRAWING TITLE

LIGHTING
CALCULATION

SCALE AS NOTED

REVISION	DATE
SP REVS	5 MAR 2013
DRAWN BY CY	REVIEWED BY PQ

SHEET

LT-2