

REED+HILDERBRAND

GENERAL NOTES

Existing conditions and topography data are from surveys prepared on:

3 December 2020 by Precision Land
Surveying, Inc., 32 Turnpike Road,
Southborough, MA, 01772

Contractor shall verify location of any existing utilities and services and provide protection during construction. Utilities damaged during construction shall be repaired at contractors expense.

Contractor shall obtain permits for the work as required and comply with all laws, ordinances, rules and regulations of the local jurisdiction, the state, and all other authorities having jurisdiction.

Contractor shall leave site clean and orderly during construction process. Remove from site all excess materials, oil, debris and equipment. Store materials only in an approved location.

[illegible]

Drawn by MV/RD	Checked by EFK
Scale 1" = 20'	Date 03 MARCH 2023



**PERMIT SET;
NOT FOR CONSTRUCTION**

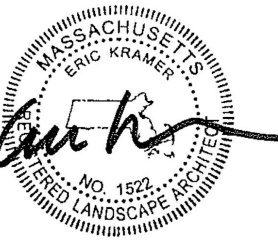

Sheet Title

MATERIALS

PLAN: ZAMBONI

LOT

Sheet Number

L-210

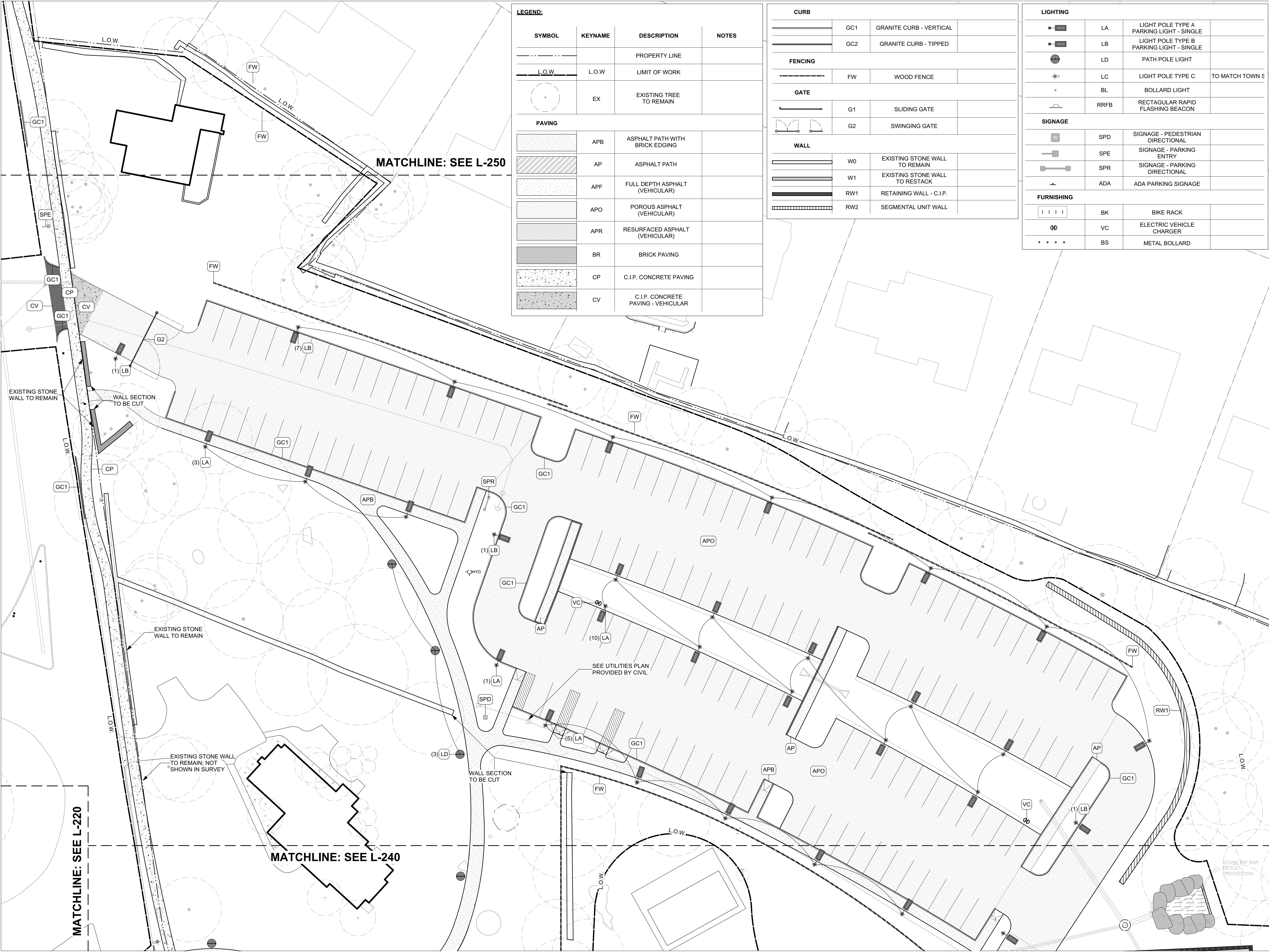

LEGEND:			
SYMBOL	KEYNAME	DESCRIPTION	NOTES
---		PROPERTY LINE	
---	L.O.W.	LIMIT OF WORK	
○	EX	EXISTING TREE TO REMAIN	
PAVING			
[Pattern]	APB	ASPHALT PATH WITH BRICK EDGING	
[Pattern]	AP	ASPHALT PATH	
[Pattern]	APF	FULL DEPTH ASPHALT (VEHICULAR)	
[Pattern]	APO	POROUS ASPHALT (VEHICULAR)	
[Pattern]	APR	RESURFACED ASPHALT (VEHICULAR)	
[Pattern]	BR	BRICK PAVING	
[Pattern]	CP	C.I.P. CONCRETE PAVING	
[Pattern]	CV	C.I.P. CONCRETE PAVING - VEHICULAR	

CURB			
[Symbol]	GC1	GRANITE CURB - VERTICAL	
[Symbol]	GC2	GRANITE CURB - TIPPED	
FENCING			
[Symbol]	FW	WOOD FENCE	
GATE			
[Symbol]	G1	SLIDING GATE	
[Symbol]	G2	SWINGING GATE	
WALL			
[Symbol]	W0	EXISTING STONE WALL TO REMAIN	
[Symbol]	W1	EXISTING STONE WALL TO RESTACK	
[Symbol]	RW1	RETAINING WALL - C.I.P.	
[Symbol]	RW2	SEGMENTAL UNIT WALL	

LIGHTING			
[Symbol]	LA	LIGHT POLE TYPE A PARKING LIGHT - SINGLE	
[Symbol]	LB	LIGHT POLE TYPE B PARKING LIGHT - SINGLE	
[Symbol]	LD	PATH POLE LIGHT	
[Symbol]	LC	LIGHT POLE TYPE C	TO MATCH TOWN S
[Symbol]	BL	BOLLARD LIGHT	
[Symbol]	RRFB	RECTAGULAR RAPID FLASHING BEACON	
SIGNAGE			
[Symbol]	SPD	SIGNAGE - PEDESTRIAN DIRECTIONAL	
[Symbol]	SPE	SIGNAGE - PARKING ENTRY	
[Symbol]	SPR	SIGNAGE - PARKING DIRECTIONAL	
[Symbol]	ADA	ADA PARKING SIGNAGE	
FURNISHING			
[Symbol]	BK	BIKE RACK	
[Symbol]	VC	ELECTRIC VEHICLE CHARGER	
[Symbol]	BS	METAL BOLLARD	

BELMONT HILL SCHOOL
BELMONT, MA

REED-HILDERBRAND
Landscape Architecture
130 Bishop Allen Drive
Cambridge MA, 02139
P617 923 2422 F617 923 3740
www.reedhilderbrand.com

GENERAL NOTES
1. Existing conditions and topography data are from surveys prepared on:
23 December 2020 by Precision Land Surveying, Inc., 32 Turnpike Road, Southborough, MA, 01772
2. Contractor shall verify location of any existing utilities and services and provide protection during construction. Utilities damaged during construction shall be repaired at contractors expense.
3. Contractor shall obtain permits for the work as required and comply with all laws, ordinances, rules and regulations of the local jurisdiction, the state, and all other authorities having jurisdiction.
4. Contractor shall leave site clean and orderly during construction process. Remove from site all excess materials, soil, debris and equipment. Store materials only in an approved location.

Revisions		
Number	Date	Description
03/03/23		RELOCATION OF PARKING LOT FARTHER FROM ABUTTING PROPERTIES

Job number XXX
Drawn by MVRD Checked by EFK
Scale 1" = 20' Date 03 MARCH 2023

0' 20' 40'
1" = 20'

Stamp **PERMIT SET; NOT FOR CONSTRUCTION**

Sheet Title
MATERIALS PLAN: EAST LOT

Sheet Number
L-230

BELMONT HILL
SCHOOL
BELMONT, MA

REED-HILDERBRAND

Landscape Architecture
130 Bishop Allen Drive
Cambridge MA, 02139
P617 923 2422 F617 923 3740
www.reedhilderbrand.com

GENERAL NOTES

- Existing conditions and topography data are from surveys prepared on:
23 December 2020 by Precision Land Surveying, Inc., 32 Turnpike Road, Southborough, MA, 01772
- Contractor shall verify location of any existing utilities and services and provide protection during construction. Utilities damaged during construction shall be repaired at contractors expense.
- Contractor shall obtain permits for the work as required and comply with all laws, ordinances, rules and regulations of the local jurisdiction, the state, and all other authorities having jurisdiction.
- Contractor shall leave site clean and orderly during construction process. Remove from site all excess materials, soil, debris and equipment. Store materials only in an approved location.

Revisions		
Number	Date	Description
	03/03/23	RELOCATION OF FACILITIES LOT AND BUILDING FARTHER FROM ABUTTING PROPERTY

Job number XXX
Drawn by MVRD Checked by EFK
Scale 1" = 20' Date 03 MARCH 2023
0' 20' 40'

Stamp **PERMIT SET;
NOT FOR CONSTRUCTION**



Sheet Title
**MATERIALS
PLAN: FACILITIES
LOT**

Sheet Number

L-240

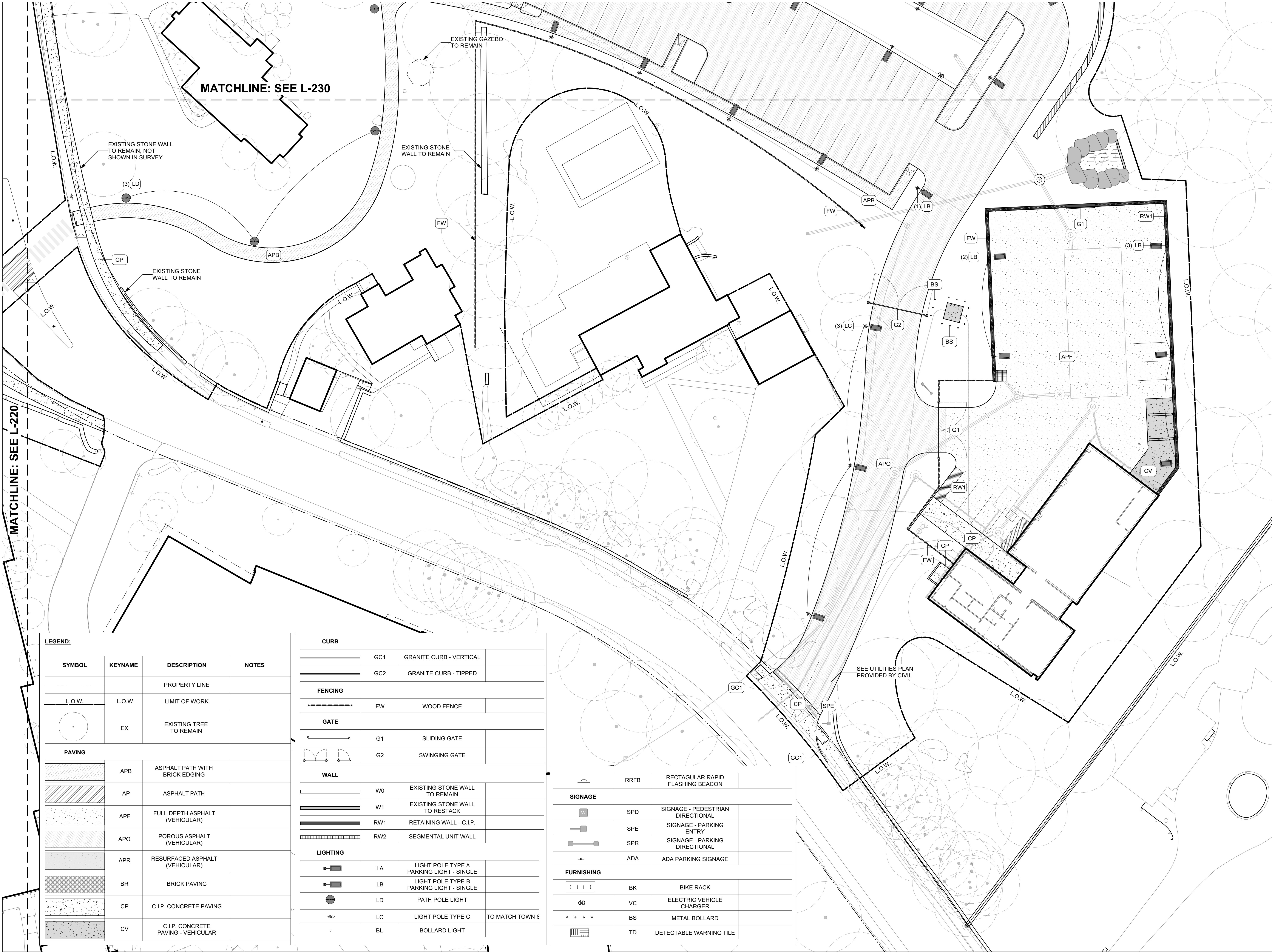

LEGEND:

SYMBOL	KEYNAME	DESCRIPTION	NOTES
		PROPERTY LINE	
	L.O.W.	LIMIT OF WORK	
	EX	EXISTING TREE TO REMAIN	
PAVING			
	APB	ASPHALT PATH WITH BRICK EDGING	
	AP	ASPHALT PATH	
	APF	FULL DEPTH ASPHALT (VEHICULAR)	
	APO	POROUS ASPHALT (VEHICULAR)	
	APR	RESURFACED ASPHALT (VEHICULAR)	
	BR	BRICK PAVING	
	CP	C.I.P. CONCRETE PAVING	
	CV	C.I.P. CONCRETE PAVING - VEHICULAR	

CURB			
	GC1	GRANITE CURB - VERTICAL	
	GC2	GRANITE CURB - TIPPED	
FENCING			
	FW	WOOD FENCE	
GATE			
	G1	SLIDING GATE	
	G2	SWINGING GATE	
WALL			
	W0	EXISTING STONE WALL TO REMAIN	
	W1	EXISTING STONE WALL TO RESTACK	
	RW1	RETAINING WALL - C.I.P.	
	RW2	SEGMENTAL UNIT WALL	
LIGHTING			
	LA	LIGHT POLE TYPE A PARKING LIGHT - SINGLE	
	LB	LIGHT POLE TYPE B PARKING LIGHT - SINGLE	
	LD	PATH POLE LIGHT	
	LC	LIGHT POLE TYPE C	TO MATCH TOWN S
	BL	BOLLARD LIGHT	

	RRFB	RECTAGULAR RAPID FLASHING BEACON	
SIGNAGE			
	SPD	SIGNAGE - PEDESTRIAN DIRECTIONAL	
	SPE	SIGNAGE - PARKING ENTRY	
	SPR	SIGNAGE - PARKING DIRECTIONAL	
	ADA	ADA PARKING SIGNAGE	
FURNISHING			
	BK	BIKE RACK	
	VC	ELECTRIC VEHICLE CHARGER	
	BS	METAL BOLLARD	
	TD	DETECTABLE WARNING TILE	

