



PROJECT NAME:  
MINT Dispensary  
768 PLEASANT STREET  
BELMONT, MA 02478

CLIENT NAME:  
EIVAN SHAHARA  
BRIGHTFOOT, INC.  
5210 SOUTH PRIEST DRIVE  
GUADALUPE, AZ, 85283  
MARICOPA COUNTY, USA

CONTRACTOR:  
VALIEANT-AMERICA  
P.O. BOX 87141  
S. DARTMOUTH, MA 02748  
VALIANT-AMERICA.COM

CIVIL ENGINEER:  
HAYES ENGINEERING  
603 SALEM STREET  
WAKEFIELD, MA 01880  
781.246.2800  
HAYESEN.COM

REV.	DATED	DESCRIPTION
01	11/07/2021	EXISTING COND. SET
02	11/29/2021	PROPOSED PLANS
03	01/20/2022	SCHEMATIC DESIGN SET
04	01/28/2022	DESIGN
05	03/02/2022	DEVELOPMENT SET
06	03/15/2022	CD REVIEW SET PERMIT DOCS

PROJECT ID: 21.001

DRAWN BY: MCO

CHECKED BY: MCO

SCALE: AS NOTED

ISSUE DATE: 03/15/2022

SHEET TITLE

PROPOSED  
FLOOR PLAN

SHEET NUMBER

A-100

**FLOOR PLAN NOTES**

- DIMENSIONS ARE FROM FINISH FACE TO FINISH FACE UNLESS OTHERWISE NOTED.
- ALL GYPSUM WALLBOARD AT BATHROOM LOCATIONS/PLUMBING LOCATIONS TO BE MOISTURE RESISTANT.
- ALL PARTITIONS TO BE TYPE 1 UNLESS OTHERWISE NOTED

**FLOOR PLAN LEGEND**

- PARTITIONS AND OTHER OBJECTS TO BE DEMOLISHED
- PARTITION TO REMAIN
- PROPOSED PARTITION - SEE PARTITION SCHEDULE
- WALL TAG
- DOOR TAG
- WINDOW TAG
- CEILING HEIGHT

**NOTE:**  
MILLWORK DESIGN, LAYOUT,  
AND DRAWINGS BY OTHERS.

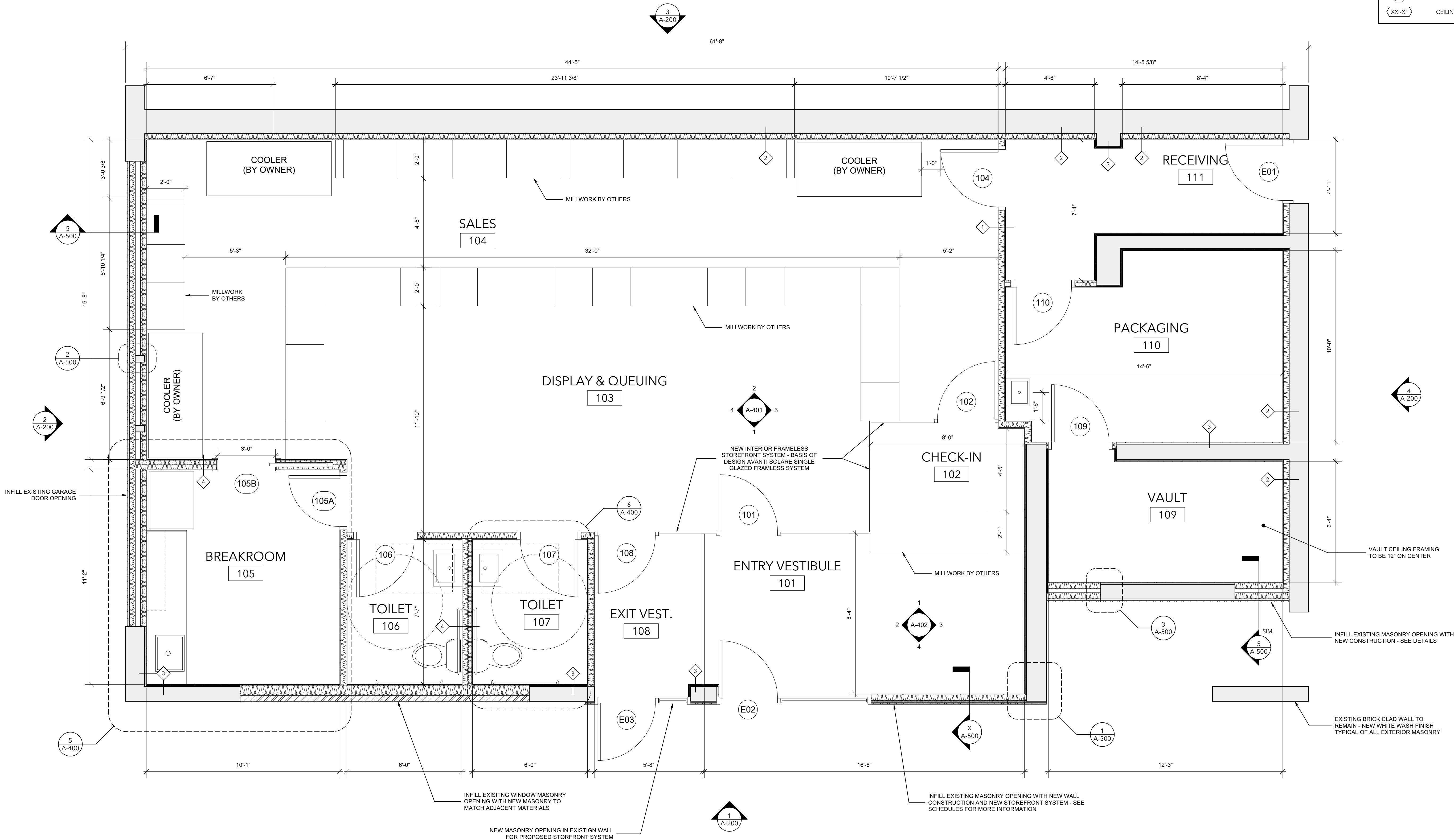

**PROPOSED FIRST FLOOR PLAN**

Scale: 3/8" = 1'-0"