



Town Belmont
Historic District Commission
Homer Municipal Building, 2nd Floor
19 Moore Street
Belmont, MA 02478

OFFICE USE

Case Number: HDC -

APPLICATION

In accordance with the Historic Districts Act, MGL Ch 40C, and the Town of Belmont General Bylaws, §40-315, the undersigned applies to the Belmont Historic District Commission for a Certificate of:

☒ Appropriateness

☐ Non-Applicability

☐ Hardship

1. PRELIMINARY INFORMATION:

Address of Property: 527 Concord Ave

Property Owner's Name: Dorothy + Steve Gilman

Address: 527 Concord Ave

Email: steven.gilman@outlook.com

Phone: 617-710-1513

Agent Name: N/A

Address: _____

Email: _____

Phone: _____

I am the: ☒ Property Owner ☐ Agent

☐ Property is Owned by a Corporation, LLC, or Trust (Submit authorization to sign as owner)

☐ Property is a Condominium or Cooperative Association (submit authorization to sign as trustee)

If applicable: Architect: _____

Contractor: Bennet Custom Renovations
(andrew calorio)

2. BRIEF DESCRIPTION OF PROPOSED WORK:

Replace non-functional French door in lower family room with custom-made door matching existing design and color (white)

Figure 1 - VIEW OF house showing existing opening for Door

Figure 2 - existing door

Figure 3 - shop drawing and specification of custom replacement

3. SIGNATURES:

As Owner, I make the following representations:

A. I hereby certify that I am the Owner of the Property at: 527 Concord Ave

B. I hereby certify that if an Agent is listed on this Application, this Agent has been authorized to represent this Application before the Belmont Historic District Commission.

Owner: Steve Gilman

Date: 5/10/23

As Applicant/Agent, I make the following representations:

1. The information supplied on and in this Application is accurate to the best of my knowledge;

2. I will make no changes to the approved plans without prior approval from the Belmont Historic District Commission.

Applicant/Agent: Steve Gilman

Date: 5/10/23

* Incomplete applications and Insufficient documentation will not be accepted. *

Approved March 23, 2017

Historic District Commission:

We are requesting a Certificate of Appropriateness to replace a French door in our lower family which has had water damage and is non-functional. The lower family had a significant water leak from our heating system which flooded the crawlspace under the room and had to be urgently addressed to avoid further damage. The water and humidity warped the floor, existing door and built in cabinets. Because of the urgency of repairing the leak and flooded crawlspace, the existing/prior door was removed early in the project to provide access to construction equipment and because we assessed early on that it was unusable and would need to be replaced in any event. Hence, we do not have any pictures of the original door in place but have attached a picture of the opening for the door (Figure 1) and a picture of the removed door (Figure 2).

We had a site visit with Carl Solander who encouraged us to find a custom manufacturer to make a replacement door that would match the existing door design.

Fortunately, we *were* able to identify a supplier (JB Sash and Door, Chelsea) who will provide a custom-made replacement door to match the existing (compare Figure 2 and Figure 3). Like the existing, this will be a high quality (Marvin) wood door with the exterior painted white to match the original.

Steve and Dorothy Gilman
527 Concord Ave

Figure 1
GILMAN



FIGURE 1

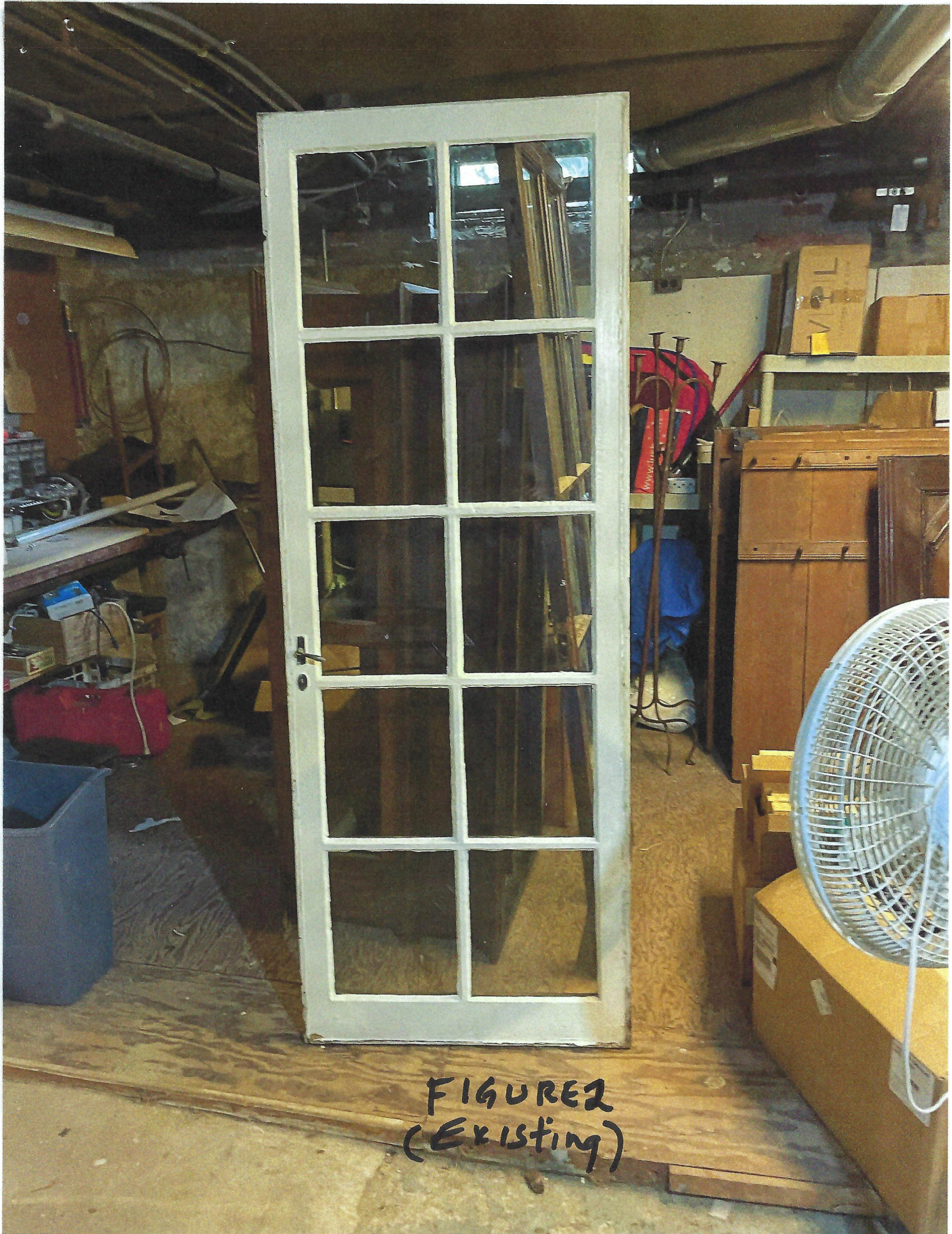

FIGURE2
(EXISTING)

527 CONCORD AVENUE BELMONT, MA BENNETT CUSTOM RENOVATIONS

Quote #: 5F1PB3V

A Proposal for Window and Door Products prepared for:

Shipping Address:

J B SASH & DOOR CO INC
280 Second ST
CHELSEA, MA 02150-1710

JBSASH & DOOR

HOME OF THE WINDOW BOYS

JOE ADAMS

J B SASH & DOOR CO INC

280 2ND ST

CHELSEA, MA 02150-1710

Phone: (617) 884-8940

Email: joea@jbsash.com

This report was generated on 5/2/2023 2:29:49 PM
using the Marvin Order Management System,
version 0004.02.01 (Current). Price in USD. Unit
availability and price are subject to change. Dealer
terms and conditions may apply.

Featuring products from:

MARVIN 

UNIT SUMMARY

The following is a schedule of the windows and doors for this project. For additional unit details, please see Line Item Quotes.

Additional charges, tax or Terms and Conditions may apply. Detail pricing is per unit.

NUMBER OF LINES: 1

TOTAL UNIT QTY: 1

EXT NET PRICE: USD 8,950.55

LINE	MARK UNIT	PRODUCT LINE	ITEM	NET PRICE	QTY	EXTENDED NET PRICE
1	INSWING HINGED DOOR	Ultimate Wood	Inswing French Door Pre 6/28/2021 CN 50R66R RO 60" X 80" Entered as CN 50R66R	8,950.55	1	8,950.55

Figure 3

LINE ITEM QUOTES

The following is a schedule of the windows and doors for this project. For additional unit details, please see Line Item Quotes. Additional charges, tax or Terms and Conditions may apply. Detail pricing is per unit.

Line #1	Mark Unit: INSWING HINGED DOOR	Net Price:	8,950.55
Qty: 1		Ext. Net Price: USD	8,950.55

MARVIN

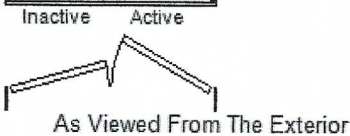
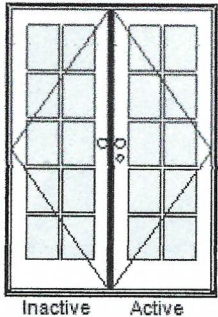

Entered As: CN
CN 50R66R
RO 60" X 80"
Egress Information
Width: 51 9/16" Height: 75 27/32"
Net Clear Opening: 27.16 SqFt
Performance Information
U-Factor: 0.3
Solar Heat Gain Coefficient: 0.2
Visible Light Transmittance: 0.34
Condensation Resistance: 62
CPD Number: MAR-N-393-10220-00001
ENERGY STAR: N, NC, SC, S

Primed Pine Exterior
Bare Pine Interior
Ultimate Wood Inswing French Door 6 9/16" - XX Right Hand
CN 50R66R
Rough Opening 60" X 80"
Traditional Panels
Left Panel
Primed Pine Sash Exterior
Bare Pine Sash Interior
IG
Tempered Low E2 w/Argon
Black Perimeter and Spacer Bar
7/8" SDL - With Spacer Bar - Black
Rectangular - Standard Cut 2W5H
Primed Pine Ext - Bare Pine Int
Ogee Interior Glazing Profile
Right Panel
Primed Pine Sash Exterior
Bare Pine Sash Interior
IG
Tempered Low E2 w/Argon
Black Perimeter and Spacer Bar
7/8" SDL - With Spacer Bar - Black
Rectangular - Standard Cut 2W5H
Primed Pine Ext - Bare Pine Int
Ogee Interior Glazing Profile
Non Finger-Jointed Door Option for Secondary Surface
Traditional Lever(s)
Multi-Point Lock on Active Panel
Brass PVD Active Exterior Handle Set on Active Panel Keyed
Brass PVD Active Interior Handle Set on Active Panel
Multi-Point Lock on Inactive Panel
Brass PVD Inactive Exterior Handle Set on Inactive Panel
Brass PVD Inactive Interior Handle Set on Inactive Panel
Brass PVD Adjustable Hinges 3 Per Panel
Exterior Ultimate Swinging Screen G2
Stone White Surround
Brass PVD Traditional Handle
Bright View Mesh
***Screen/Combo Ship Loose
Bronze Ultrex Sill
Black Weather Strip
Bare Oak Sill Liner
6 9/16" Jambs
Exterior Casing - None
Installed Installation Brackets
Skid Plate Applied
***Note: Unit Availability and Price is Subject to Change

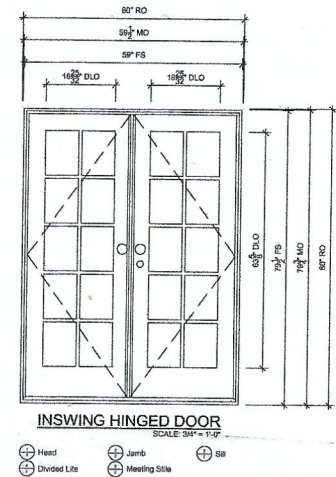

Project Subtotal Net Price: USD	8,950.55
6.250% Sales Tax: USD	559.41
Project Total Net Price: USD	9,509.96

Accepted:

Processed on: 5/2/2023 2:29:49 PM

Page 3 of 7