

Belmont Traffic Advisory Committee
Minutes
June 15, 2017

2017 NOV 15 PM 2:24

Larry MacDonald, Chair, opened the meeting at 710p
He read a letter from (Fire) Chief David Frizzell requesting that the Middle School/
Selwyn Road decision be postponed

Principal Michael McAllister, Chenery Middle School, stated that he was happy to be
part of the dialog and to help come up with solutions.

Mr. MacDonald talked about the problems facing the neighbors on Selwyn Road:
infractions, parking in front of driveways, parking on both sides of the street which
does not allow for emergency vehicles to pass. He stated that the School Department
was addressing the issues and that the goal was to make a plan that works.

Many resident neighbors were present.

Questions from neighbors: (Hurd Road resident) Is the TAC planning a parking lot
on Hurd Road? What they are presently seeing as a plan is unfair to Hurd Rd since it
shifts the burden from Selwyn to Hurd.

Mr. McAllister identified the *net overflow* (number of staff cars exceeding school
parking spaces) as 45-56 cars. He noted that cars were blocking others and parking
wherever. He was unable to identify parent cars but 45-56 is the teacher overflow.

Resident Brad., 2 Selwyn Road: stated that the parking situation is an unfair burden
on Selwyn. "Parents parking in front of houses, parking like maniacs, blocking
driveways, parking in the wrong direction, on crosswalks and at the corner." He
was further concerned that there was no parking enforcement.

Neighbor Ms. Parent said that Teacher Night is even worse. Parents are insensitive
and disrespectful and ignore signs. She believe this sets a poor example for kids

Resident Bob Singler asked Mr. McAllister how the Butler plan was developed when
Mr. McAllister was Principal there. Mr. McAllister said that staff had to go to the
Town Clerk's office to get a registration card.

Mr. McAllister indicated that the Butler school had 79 cars with a net overflow of 40
that were accommodated on neighboring streets.

Margo Keegan, a West Street resident was concerned that traffic issues have gotten
worse. She noted that 22 Yrs. ago when the Chenery was built a back entrance was
designed so that the children could enter there as an alternative to Washington
Street.

Ms. Keegan noted that 150 to 200 cars go down West Street daily. She questioned if other methods of getting to the schools have been explored. She also offered the suggestion that parking around the Reservoir is convenient and plentiful. She believes it's a collective issue that West Street residents should not have to bear alone.

Mary Domingas, 2 West Street, presented photos of illegal parking on Washington Street and West Street when parents pick up their children. She offered a report from a Los Angeles Traffic study. They cited a Best Practice as needing 20 feet. Since Belmont streets are only 26 feet, if parking is allowed on both sides of the street it is not safe. She also indicated her concern for neighbors with health emergencies.

Mr. Gary Kalazian said that he was grateful that the Fire Department spoke to this issue. He hoped to have another look at the problem.

John Caruso, 36 Selwyn suggested that the corner of Branchard/Washington Street could accommodate 30 staff cars if the zoning changed.

Mary Gorman reported that after school there were 25 cars waiting for their children.

A Garden Street resident suggested that a bigger problem is parents tearing down the street after leaving their child off at the school.

Mr. John Malone said that notes have been left for after-school parents by the neighbors regarding blocking driveways etc , and that they have been ignored. He also reported that the parents were speeding down the street and he questioned how we could spread the number of cars parking out further in the neighborhood.

Sara Kenneston of 45 Selwyn stated that safety is the issue.

Linda Nickens, (TAC member) offered that we all need to recognize that we don't own the front of our houses. Further a decision to allow parking on one side can be problematic.

Lena Wong of Selwyn Road pointed out that 19 permit spaces on Selwyn were used by CMS staff daily which virtually constitutes Selwyn as a Chenery parking lot.

It was suggested that the teachers park at an offsite location and take a "school bus" to the Chenery.

Mr. MacDonald suggested Working Group be convened of neighbors who are interested which Principal McAllister will host.

Ridge Road residents requested turn restrictions. Mr. Perry Reddy had sent a letter to TAC. It noted that Ridge Road is a one-way street which now has 15 children living there. He noted that people drive in the wrong direction and that many cars try to avoid the light at White Street.

Larry MacDonald suggested a 6-month temporary change. Officer Matt Benoit indicated that enforcement would be across the board. Residents as well as non-residents of the street will be pulled over if they ignore the changes being implemented. Police presence will be generally from 7 to 9 am, however it needs to be noted that shift change is at 745am

Other ideas were suggested: Possibly change the length of the light cycle? Speed bumps? 5 mile/hour sign?

It was also noted that the Montessori School on 34 Ridge, corners onto Belmont Street. Drop off and pick up is on Ridge. The TAC will look into establishing a school zone there because of the Montessori school

The parking issue at the **Belmont Public Library** was presented by Peter Struzziero., Director of the BPL, Mark Carney, Board Member of the BPL and Ellen Schrieber as representative of the Belmont Pool.

It was noted that some people park their cars for up to 6 hours in front of the Library and the Pool making it difficult for staff to park. Several suggestions were made: Additional signage on Concord Avenue; Tow Sign in the Library lot for all day unauthorized parking; Mr. MacDonald Larry suggested 5-4 hour spaces plus no parking before 8 am. Selectmen approval will be necessary.

Board voted to establish 5-4 hour slots in front of the Library. Tomi moved. Linda seconded. Unanimous accepted.

The Board decided that there needed to be more investigation of the no parking issue before 8am. It will be put on the Agenda for a future meeting

Burbank School discussion:

Present for the discussion were a Burbank parent, representing the Burbank PTA, and Mr. Ernie Fay, resident neighbor.

It was noted that there is much going on at the Burbank. Modulers have been added. Now 4 buses are bringing students to the Burbank. Sharpe Road had 18 cars parked on it today. Speeding has become an issue.

The Board voted to recommend one more crossing guard. Linda moved/Matt seconded. Unanimous vote.

The Board voted to accept the Minutes of May 11.

Respectfully submitted,

Tomi Olson, Secretary



Traffic Advisory Committee

TOWN OF BELMONT

19 Moore Street
Homer Municipal Building
Belmont, Massachusetts 02478-0900
Telephone: (617) 993-2650 Fax: (617) 993-2651

Laurence Macdonald, Chair
Dana Miller, Vice Chair

Peter Curro
Donald Mercier
Linda Nickens
Tommasina Olson
Elizabeth "Sue" Pew
Matt Sullivan

Date: June 5, 2017

To: Members – Traffic Advisory Committee

From: Glenn R. Clancy, Committee Liaison

Subject: Agenda for Meeting on **Thursday, June 15, 2017 at 7:00 PM** in **Town Hall Conference Room 2**. If you cannot attend the meeting, please contact me via e-mail.

7:00 – 7:05 Minutes (May 11, 2017)

7:05 – 7:45 Public Meeting – Chenery Middle School Parking Issues

- Discussion and Vote on Final Plan

7:45 – 8:05 Ridge Road - Proposed Turn Restrictions (Resident Request)

- Discussion and Vote

8:05 – 8:20 Proposed Parking Restriction – Concord Avenue at Memorial Library (Belmont Library)

- Discussion and Vote

8:20 – 8:40 Burbank School – Proposed Parking Restrictions on Sharpe Road

- Discussion and Vote

8:40 – 8:50 Old Business

- Other (No Known Items)

8:50 – 9:00 New Business

- Other (No Known Items)

9:00 Adjourn

Note: Times are tentative depending on the flow of the meeting, the time of any particular item may deviate ten to fifteen minutes from the schedule.

Cc: Board of Selectmen – Jim Williams
Phyllis Marshall, Interim Town Administrator
Sgt Ben Mailhot, Belmont Police Department
Richard McLaughlin, Belmont Police Chief
Jay Marcotte, Director, Department of Public Works
Karl Haglund, Planning Board



OFFICE OF COMMUNITY DEVELOPMENT

MEMO

MEMO TO: Traffic Advisory Committee
FROM: Glenn R. Clancy, P.E.
SUBJECT: Chenery Middle School – Overflow Parking Plan
DATE: June 6, 2017

Principal Michael McAllister of the Chenery Middle School estimates there are fifty-six parking spaces required to accommodate the overflow parking at the school. Recall the Traffic Advisory Committee is interested in considering a plan that will distribute parked vehicles on five roads near the school; Garden Street, West Street, Howard Street, Hurd Road and Selwyn Road.

I have looked at each of the roads and I believe 56 spaces can be accommodated by distributing them as follows:

Garden Street – 4
West Street – 9
Howard Street – 6
Hurd Road – 18
Selwyn Road – 19

In order to minimize the impact to residents this plan allows teachers to park on one side of the road only (see attached plan). The other side of each road can be left unrestricted for use by anyone other than teachers. Please be aware that due to access restrictions on each road between 7:00 am to 9:00 am there is really only one side of the road available between those hours. Teachers parking on Garden Street, West Street and Howard Street will need to access Washington Street from Common Street to avoid violating the posted access restriction on Washington Street at Goden Street.

Each teacher will receive a parking tag specific to the road they are allowed to park on. This will regulate the number on each road and allow residents to identify permit holders parking in the wrong location. This program will be administered by principal McAllister.

Additional vehicles above 56 would be required to find parking elsewhere. Near the Payson Park Reservoir has been mentioned and is a possibility.

June 5, 2017 Scale 1" = 160'

Office of Community Development

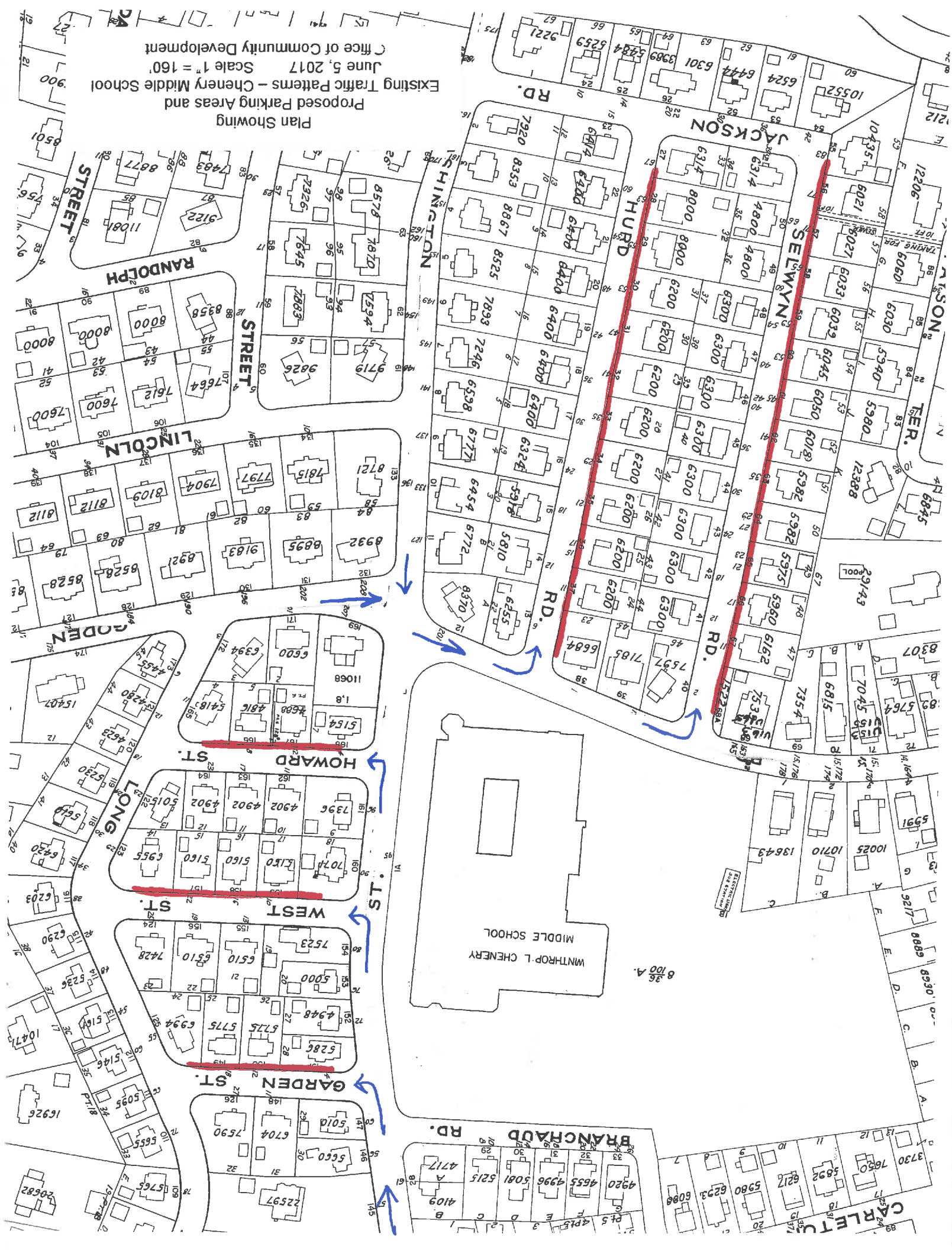



- Town-Owned Buildings
- McLean Buildings
- Buildings
- Parcels
- Town Boundary
- MA Highways
- Interstate
- US Highway
- Numbered Routes
- Charles_pole
- Charles_arc
- Abutting Town Labels
- Abutting Towns
- Roads
- Major Road, Collector
- Minor Road, Arterial

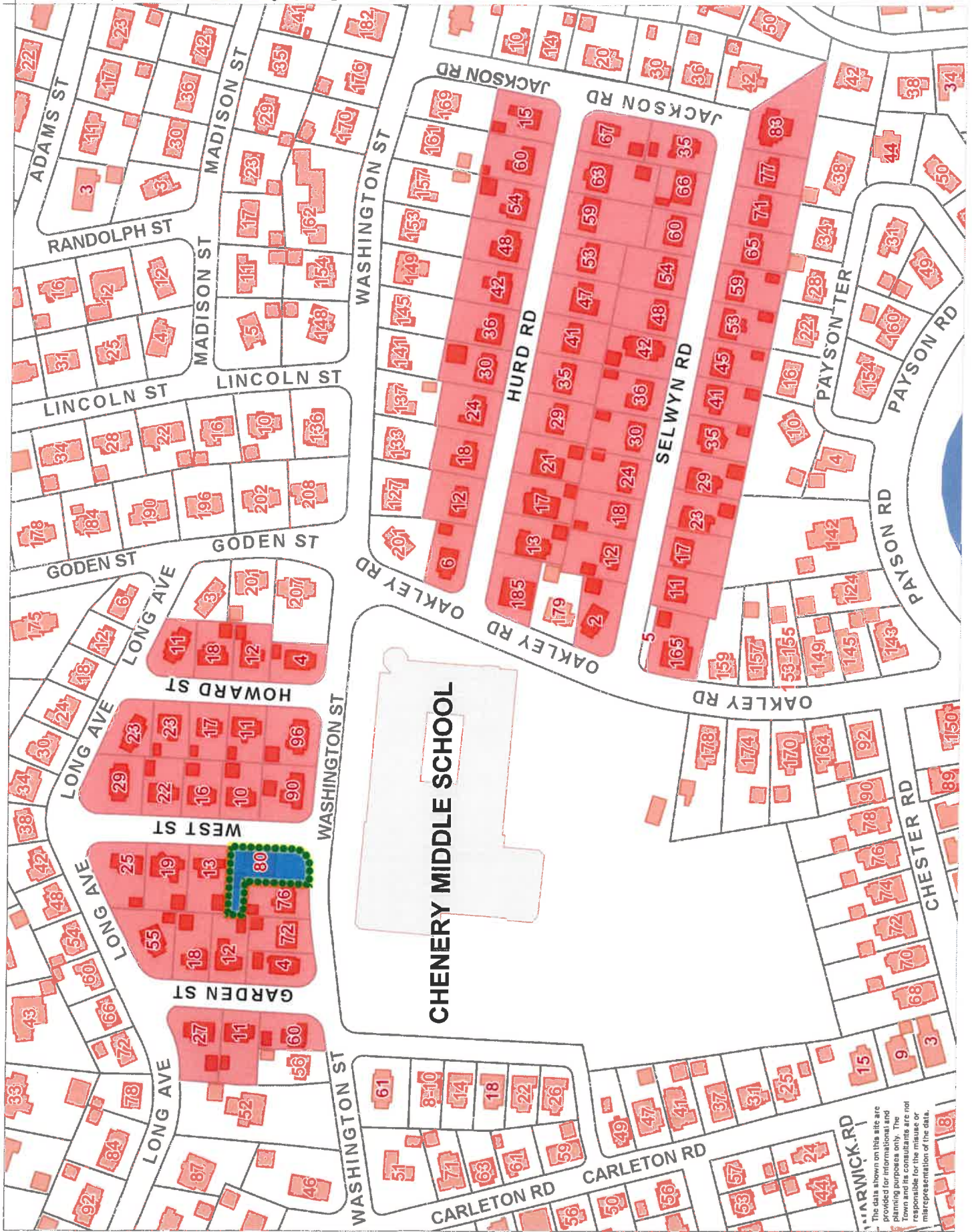

Clancy, Glenn

From: McAllister, Michael <MMcAllister@belmont.k12.ma.us>
Sent: Thursday, June 01, 2017 8:01 AM
To: Clancy, Glenn
Subject: RE: Parking Counts

Hi Glenn,

Here are the counts you requested:

Total spots available in CMS parking lot: 114 (does not include handicap parking spots) Additional spots we have managed to create due to some semi-illegal parking that the Fire Department doesn't exactly love: 9
Total capacity of CMS lot: 123 Total staff cars: 179 Overflow spots needed: 56

I hope these numbers prove helpful. Please let me know if you would like me to be at the next TAC meeting to present these numbers formally. If memory serves me correctly, it is next Thursday.

Respectfully,
Mike

From: Clancy, Glenn [gclancy@belmont-ma.gov]
Sent: Monday, May 22, 2017 9:51 AM
To: McAllister, Michael
Subject: Parking Counts

Good morning Mike:

Have you had a chance to get the parking number we discussed at the TAC meeting?

Thanks, Glenn

4 - GARDEIN
9 - WEST
6 - HOWARD
18 - HURD
19 ~~20~~ - SCLWYN

56

Parcel ID: 18-154
STAMATOPOULOS TE
VIRGINIA STAMATOPOULOS
80 WASHINGTON ST
BELMONT, MA 02478

Parcel ID: 18-122
CHEN YONG HUA
23 LONG AVE
BELMONT, MA 02478

Parcel ID: 18-123
GRABOVAC TE DALIBOR
AIDA REPUH
29 LONG AVE
BELMONT, MA 02478

Parcel ID: 18-124
RIES TE DANIEL R
NANCY G RIES
25 WEST ST
BELMONT, MA 02478

Parcel ID: 18-125
BASSLER TE STUART B
ANNE H BASSLER
55 LONG AVE
BELMONT, MA 02478

Parcel ID: 18-126
SALEK TR HENRIETTE B
SALEK REALTY TRUST
27 GARDEN ST
BELMONT, MA 02478

Parcel ID: 18-147
FREEDMAN TE PETER H
JANET FREEDMAN
60 WASHINGTON ST
BELMONT, MA 02478

Parcel ID: 18-148
ZOLNER TC ROBERT J
ANGELA E TUEL
11 GARDEN ST
BELMONT, MA 02478

Parcel ID: 18-149
CADIN TE JEFFREY M
LORA J CHAJKA CADIN
18 GARDEN ST
BELMONT, MA 02478

Parcel ID: 18-150
ITO-ADLER TE JAMES P
LINDA ITO-ADLER
12 GARDEN ST
BELMONT, MA 02478

Parcel ID: 18-151
RAPA JT ELEANOR F
MARILYN G RAPPA
4 GARDEN ST
BELMONT, MA 02478

Parcel ID: 18-152
TAYLOR TE ZACHARIAH
BARBARA B TAYLOR
72 WASHINGTON ST
BELMONT, MA 02478

Parcel ID: 18-153
FIREMAN TE GARY D
SHEILA MURPHY FIREMAN
76 WASHINGTON ST
BELMONT, MA 02478

Parcel ID: 18-155
HAMAD TR CHARLES D
HAMAD FAMILY REALTY TRUST
13 WEST ST
BELMONT, MA 02478

Parcel ID: 18-156
SMITH TE CURTIS L III
N KAYE DENNY
19 WEST ST
BELMONT, MA 02478

Parcel ID: 18-157
DOMINGUEZ MARY A
22 WEST ST
BELMONT, MA 02478

Parcel ID: 18-158
KEEGAN TE J GERARD
MARGARET M KEEGAN
16 WEST ST
BELMONT, MA 02478

Parcel ID: 18-159
ROKOSZ TE JOHN A
DEBRA ROKOSZ
10 WEST ST
BELMONT, MA 02478

Parcel ID: 18-160
KALAJIAN TE GARY G
REGINA A KALAJIAN
90 WASHINGTON ST
BELMONT, MA 02478

Parcel ID: 18-161
MALSKY TE HERBERT
ELIZABETH Z MALSKY
96 WASHINGTON ST
BELMONT, MA 02478

Parcel ID: 18-162
CHEN TE DAPENG
NING MA
11 HOWARD ST
BELMONT, MA 02478

Parcel ID: 18-163
FLYNN TE JOHN B
PATRICIA A FLYNN
122 RUSSELL AVE
WATERTOWN, MA 02472

Parcel ID: 18-164
FRIEDMAN TE STEVEN
JANE D HANENBERG
23 HOWARD ST
BELMONT, MA 02478

Parcel ID: 18-165
FIRTH TE PAUL G
CAROL P FIRTH
11 LONG AVE
BELMONT, MA 02478

Parcel ID: 18-166
MCDEVITT TE JOHN A
DEBORAH M MCDEVITT
18 HOWARD ST
BELMONT, MA 02478

Parcel ID: 18-167
MCMANUS TE JOHN N
CHRISTINE B MCMANUS
12 HOWARD ST
BELMONT, MA 02478

Parcel ID: 18-168
HO TRS BERNARD AND LAI
BERNARD HO AND LAI CHUN
4 HOWARD ST
BELMONT, MA 02478

Parcel ID: 7-13
LI HUANYU
6 HURD RD
BELMONT, MA 02478

Parcel ID: 7-14
WEINSTEIN RUTH A
12 HURD RD
BELMONT, MA 02478

Parcel ID: 7-15
LYONS PAULA D
18 HURD RD
BELMONT, MA 02478

Parcel ID: 7-16
FITZGERALD TE JAMES P
JANE E FITZGERALD
24 HURD RD
BELMONT, MA 02478

Parcel ID: 7-17
BOYLE TE JOHN TAGGART
LAURA CONOVER BOYLE
30 HURD RD
BELMONT, MA 02478

Parcel ID: 7-18
MONKIEWICZ TE FRANK
AMY MONKIEWICZ
36 HURD RD
BELMONT, MA 02478

Parcel ID: 7-19
BOJANOWSKI TE JERZY
TANIA BOJANOWSKI
42 HURD RD
BELMONT, MA 02478

Parcel ID: 7-20
MERINGER TE JULIE H
BRIAN MERINGER
48 HURD RD
BELMONT, MA 02478

Parcel ID: 7-21
INDRAKANTI TE RAMESH BABU
MEENA MEENA
54 HURD RD
BELMONT, MA 02478

Parcel ID: 7-22
LIND TE KENNETH E
KATE M BLUMENREICH
60 HURD RD
BELMONT, MA 02478

Parcel ID: 7-23
PICARDI TE RALPH G
DIANE PICARDI
15 JACKSON RD
BELMONT, MA 02478

Parcel ID: 7-27
JORDAN JT THOMAS
CATHERINE OLOFSON
67 HURD RD
BELMONT, MA 02478

Parcel ID: 7-28
KALKOFEN TE WOLFGANG
RENATE KALKOFEN
63 HURD RD
BELMONT, MA 02478

Parcel ID: 7-29
BAUERLE TE LARS
KAREN BAUERLE
59 HURD RD
BELMONT, MA 02478

Parcel ID: 7-30
TWIETMEYER TE ERIC P
KAREN M TWIETMEYER
53 HURD RD
BELMONT, MA 02478

Parcel ID: 7-31
LESTER TE JAMES T III
N CATHERINE CLAYPOOLE
47 HURD RD
BELMONT, MA 02478

Parcel ID: 7-32
WHITMER TE PETER
HANNAH E FISCHER
41 HURD RD
BELMONT, MA 02478

Parcel ID: 7-33
GORMAN TRS MARY E &
GORMAN FAMILY REALTY
35 HURD RD
BELMONT, MA 02478

Parcel ID: 7-34
ROUHANA TE NADIM N
KATE B ROUHANA
29 HURD RD
BELMONT, MA 02478

Parcel ID: 7-35
CHASE TE MICHAEL R
HERMIK BABAKHANLOU-CHASE
21 HURD RD
BELMONT, MA 02478

Parcel ID: 7-36-15
VANDERLEY TE ROBERT
JIE CHEN VANDERLEY
15 HURD RD
BELMONT, MA 02478

Parcel ID: 7-36-17
VANDERLEY W CAREN
17 HURD RD
BELMONT, MA 02478

Parcel ID: 7-37
BABALAS DANITA R
152 WATSON RD
BELMONT, MA 02478

Parcel ID: 7-38
PALOSKY TC TRS LEWIS E
LINDA T PALOSKY
49 CERES ST
PORTSMOUTH, NH 03801

Parcel ID: 7-40
QUIGLEY TE AMY E
DAVID BRADFORD QUIGLEY
2 SELWYN RD
BELMONT, MA 02478

Parcel ID: 7-41
KULLER TE GIORA K
ORA KEDEM KULLER
12 SELWYN RD
BELMONT, MA 02478

Parcel ID: 7-42
MALONE TE JOHN J
EMMA L MALONE
18 SELWYN RD
BELMONT, MA 02478

Parcel ID: 7-43
TAUBES CLIFFORD H
24 SELWYN RD
BELMONT, MA 02478

Parcel ID: 7-44
DUNLAP THOMAS J
30 SELWYN RD
BELMONT, MA 02478

Parcel ID: 7-45
CARUSO TR JOAN Q
JOAN Q CARUSO ESTATE
36 SELWYN RD
BELMONT, MA 02478

Parcel ID: 7-46
VASTIS GEORGE A
C/O VALERIE VASTIS
821 BELMONT ST
BELMONT, MA 02478

Parcel ID: 7-47
GREELEY JOHN J
ALICE L GREELEY
48 SELWYN RD
BELMONT, MA 02478

Parcel ID: 7-48
PEREDA TE FELIPE
CRISTINA MORILLA
54 SELWYN RD
BELMONT, MA 02478

Parcel ID: 7-49
MESSER TE CHRISTOPHER
KRISTEN DAWN MESSER
60 SELWYN RD
BELMONT, MA 02478

Parcel ID: 7-50
ARONSON TE MICHAEL A
LINDA L HOWE
66 SELWYN RD
BELMONT, MA 02478

Parcel ID: 7-51
SCHERRER TE KARL F
ABIGAIL B SCHERRER
35 JACKSON RD
BELMONT, MA 02478

Parcel ID: 7-55
DELROSE CONSTANCE
83 SELWYN RD
BELMONT, MA 02478

Parcel ID: 7-56
KUSNITZ TE EDWARD M
MINDEN KUSNITZ RUTH
77 SELWYN RD
BELMONT, MA 02478

Parcel ID: 7-57
ELIHU J TICHOVOLSKY
SUSAN L TICHOVOLSKY
71 SELWYN RD
BELMONT, MA 02478

Parcel ID: 7-58
FREEMAN TRS ETAL WILLIAM
65 SELWYN ROAD REALTY
65 SELWYN RD
BELMONT, MA 02478

Parcel ID: 7-59
LAVOIE TE LANCE
NICOLE LAVOIE
59 SELWYN RD
BELMONT, MA 02478

Parcel ID: 7-60
SINGLER TE ROBERT E
JUDITH R SINGLER
53 SELWYN RD
BELMONT, MA 02478

Parcel ID: 7-61
KENISTON SARAH
45 SELWYN RD
BELMONT, MA 02478

Parcel ID: 7-62
KOSLOWSKY TE JOSEPH R
MARGARET M KOSLOWSKY
41 SELWYN RD
BELMONT, MA 02478

Parcel ID: 7-63
ROBBINS TE MARK E
FLORENCE A FARRELL
35 SELWYN RD
BELMONT, MA 02478

Parcel ID: 7-64
PETERS JT ARTHUR T &
CATHERINE PETERS
27 SELWYN RD
BELMONT, MA 02178

Parcel ID: 7-65
MYSTIC INVESTMENTS LLC
11 BLODGETT RD
LEXINGTON, MA 02420

Parcel ID: 7-66
RAPPLE TRS TC SUSAN E
SIKORSKI TRS BRANDI M
17 SELWYN RD
BELMONT, MA 02478

Parcel ID: 7-67
WONG TE JOHNNY B S
LENA KING WONG
11 SELWYN RD
BELMONT, MA 02478

Parcel ID: 7-68-163
SILVERFINE TE JEREMY I
LOUISE R DOMENITZ
163 OAKLEY RD
BELMONT, MA 02478

Parcel ID: 7-68-165
KAO JT EDWARD K
AMY M LING
165 OAKLEY RD
BELMONT, MA 02478



OFFICE OF COMMUNITY DEVELOPMENT

MEMO

MEMO TO: Traffic Advisory Committee

FROM: Glenn R. Clancy, P.E.

SUBJECT: Ridge Road – Turn Restrictions Letter Dated 5/26/2017

DATE: June 6, 2017

The Traffic Advisory Committee has received a letter from Carrie Redi of 16 Ridge Road regarding issues with traffic flow on Ridge Road. A copy of the letter is attached.

Three requests have been made:

- ✓ a) The One-Way sign at the end of Ridge Road at White Street should be lowered so that drivers are able to see it more clearly. It is currently placed much higher than usual and is easy to miss.
- ✓ b) “Do Not Enter” signs should be added at the end of Ridge Road at White Street on both sides of the street.
- c) A “No Right Turn” sign during certain hours (7-9am, 4-7pm) should be added at the entrance to Ridge Road at Belmont Street, so drivers would not be able to use our street as a cut-through to avoid the traffic light.

The first two requests are easily addressed and I will work with the Belmont DPW to resolve them.

The third request should be decided by the committee through the public hearing process. I have invited the residents of Ridge Road to attend a discussion on the evening of June 15, 2017.

Carrie Redi
16 Ridge Road Belmont, MA 02478
617-855-8118
carrie@jasonredi.com

5/26/2017

Office of Community Development; Homer Municipal Building
19 Moore Street; 2nd Floor
Belmont, MA 02478

Dear Belmont Traffic Advisory Committee,

I am writing to express concern over traffic issues on our street, Ridge Road, which have become dangerous for children, pedestrians, and other drivers.

Ridge Road is a One-Way street connecting Belmont Street to White Street. Many drivers use this road as a cut-through to avoid the traffic light at Belmont and White Streets. We have witnessed drivers speeding down our street mostly during morning and evening rush hour times. There are 16 children living on this street, one of which has a hearing loss, and we are very concerned about their safety.

Another issue we encounter regularly is that drivers are going down our street the wrong way. Many are apologetic upon being told they are going the wrong way but some are fully aware and are repeat offenders. For some reason the wrong-way driving has become much more common in the past few months, with daily occurrences of wrong way drivers recently.

We would like to propose that:

- a) The One-Way sign at the end of Ridge Road at White Street should be lowered so that drivers are able to see it more clearly. It is currently placed much higher than usual and is easy to miss.
- b) "Do Not Enter" signs should be added at the end of Ridge Road at White Street on both sides of the street.
- c) A "No Right Turn" sign during certain hours (7-9am, 4-7pm) should be added at the entrance to Ridge Road at Belmont Street, so drivers would not be able to use our street as a cut-through to avoid the traffic light.

Thank you for taking these proposals into consideration. We have the signatures of many concerned residents of Ridge Road/Belmont Street who are affected by these traffic concerns which I can send upon request.

Sincerely,

Carrie Redi



- Town-Owned Buildings
McLean Buildings
Buildings
Parcels
Town Boundary
MA Highways
Interstate
US Highway
Numbered Routes
Charles Poly
Charles Arc
Abutting Town Labels
Abutting Towns
Roads
Major Road, Collector
Minor Road, Arterial



The data shown on this site are provided for informational and planning purposes only. The Town and its staff are not responsible for the misuse or misrepresentation of the data.



Printed on 06/05/2017 at 01:37 PM

Parcel ID: 15-143
JONES TRS MICHAEL E
CAROL CULLINGTON
21 RIDGE RD
BELMONT, MA 02478

Parcel ID: 15-128-232
MACURDY TE BLAKE D
ELAINE HARMAN
232 WHITE ST
BELMONT, MA 02478

Parcel ID: 15-128-234
HIRNER JT LARA
JASON REED
234 WHITE ST
BELMONT, MA 02478

Parcel ID: 15-129
SPRINGER JT WILLIAM
CAROLINE MCCABE
12 RIDGE RD
BELMONT, MA 02478

Parcel ID: 15-130
REDI JASON K
16 RIDGE RD
BELMONT, MA 02478

Parcel ID: 15-131
SHAGINIAN TE ALEX
DIANA SHAGINIAN
22 RIDGE RD
BELMONT, MA 02478

Parcel ID: 15-132
AMER TE EDWARD F
JOANNA E DUNN
24 RIDGE RD
BELMONT, MA 02478

Parcel ID: 15-133
YOUNG TE PATRICK J
COLLEEN M YOUNG
26 RIDGE RD
BELMONT, MA 02478

Parcel ID: 15-134
SULLIVAN KERRY L
300 LAKE ST
BELMONT, MA 02478

Parcel ID: 15-135-1
LIEBMANN TE MATTHEW
MARIA J LIEBMANN
34 RIDGE RD
BELMONT, MA 02478

Parcel ID: 15-135-2
MASLARIS TE DIMITRIOS
ELAINE MASLARIS
32 RIDGE RD
BELMONT, MA 02478

Parcel ID: 15-142
COLLINS ANNE J
785 BELMONT ST
BELMONT, MA 02478

Parcel ID: 15-144
ENGERMAN TE DAVID C
STEPHANIE L WRATTEN
17 RIDGE RD
BELMONT, MA 02478

Parcel ID: 15-145
KILLILEA T THOMAS W
MARGARET F KILLILEA
11 RIDGE RD
BELMONT, MA 02478

Parcel ID: 15-146
HANSON TE CHADWICK G
EILEEN L HANSON
236-238 WHITE STREET
BELMONT, MA 02478

Parcel ID: 15-147
GEIS THEODORE C
240 WHITE ST
BELMONT, MA 02478

Parcel ID: 15-148
HOWICK TE RICHARD H
CLARE L HOWICK
789 BELMONT ST
BELMONT, MA 02478

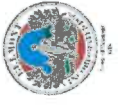

- Town-Owned Buildings
- McLean Buildings
- Buildings
- Permits
- Town Boundary
- MA Highways
- Interstate
- US Highway
- Numbered Routes
- Charles_pole
- Charles_arc
- Abutting Town Labels
- Abutting Towns
- Roads
- Major Road, Collector
- Minor Road, Arterial

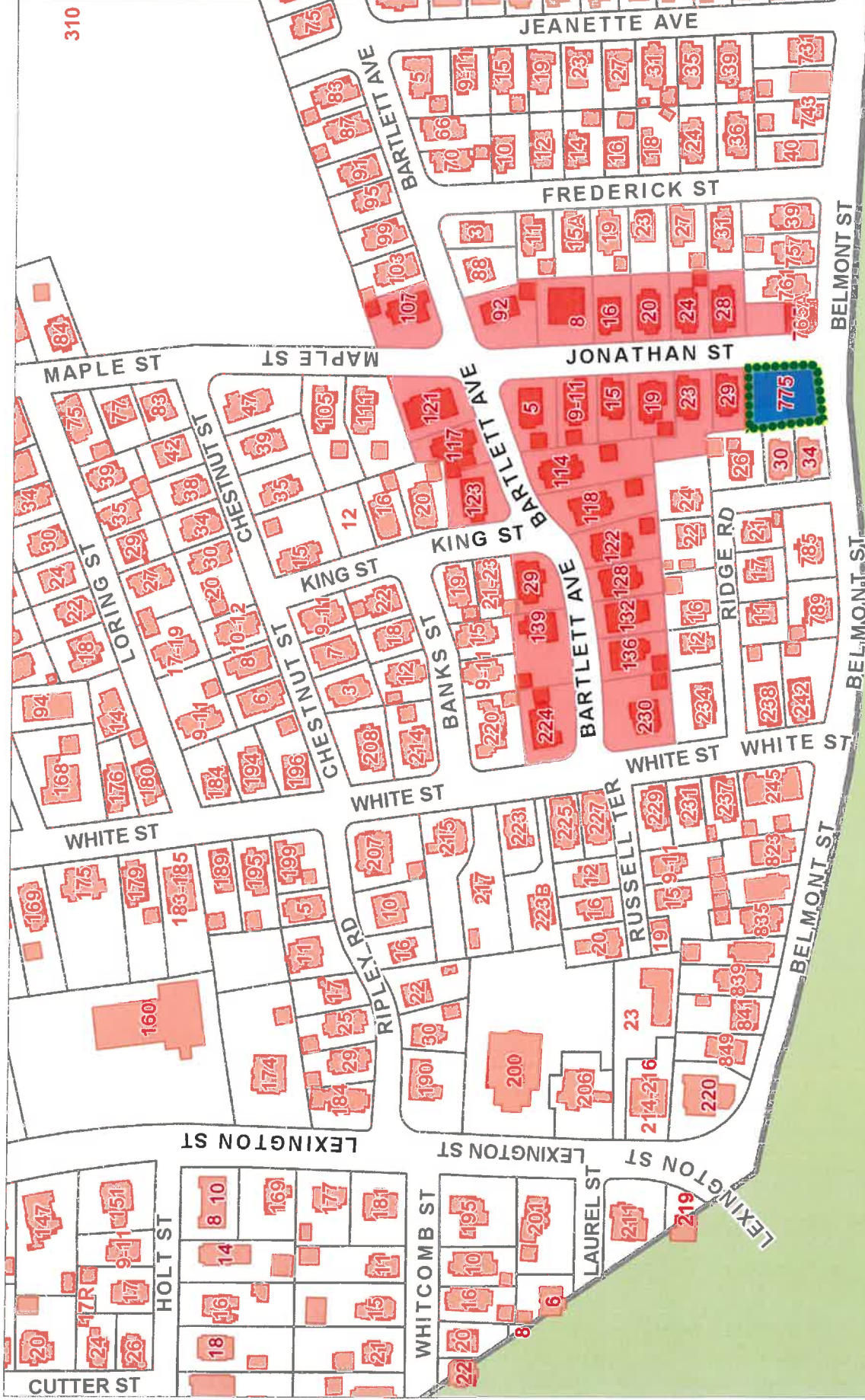

The data shown on this site are provided for informational and planning purposes only. The Town and its consultants are not responsible for the misuse or misrepresentation of the data.

Parcel ID: 15-136
BOYAJIAN TC GARY
MARGARET BOYAJIAN
660 OCEAN AVE APT 436
REVERE, MA 02151

Parcel ID: 13-152
DANDREA TE JOSEPH
ADRIANA DANDREA
92 BARTLETT AVE
BELMONT, MA 02478

Parcel ID: 13-154-1
CHAO TE TU
XIAOMEI ZHOU
8 JONATHAN ST
BELMONT, MA 02478

Parcel ID: 13-154-2
WIDEMUTH TE KATHY H
ANDREAS WINDEMUTH
10 JONATHAN ST
BELMONT, MA 02478

Parcel ID: 13-155
NORTZ TE MARIA
RICHARD J NORTZ
39 WINN ST
BELMONT, MA 02478

Parcel ID: 13-156
KOH RACHEL
RACHEL KOH REVOCABLE
18 JONATHAN ST
BELMONT, MA 02478

Parcel ID: 13-157
REA JONATHAN C
3 LAUREL AVE
NORTHBOROUGH, MA 01532

Parcel ID: 13-158-1
DULGARIAN TE GREGORY
RITA DULGARIAN
26 JONATHAN ST
BELMONT, MA 02478

Parcel ID: 13-158-2
ROHAN TE MICHAEL
PRASOPORN ROHAN
28 JONATHAN ST
BELMONT, MA 02478

Parcel ID: 13-159
MESSINA TRS STEPHEN J &
MESSINA FAMILY REALTY
765 BELMONT ST
BELMONT, MA 02478

Parcel ID: 14-200
FOWNES TRS LISA D
LISA D FOWNES INDENTURE
105 BARTLETT AVE
BELMONT, MA 02478

Parcel ID: 15-100
KAPETANAKIS TR MARILYN M
PALEOLOGOS NOMINEE TRUST
252 WINTHROP ST
MEDFORD, MA 02155

Parcel ID: 15-115
HAVERTY TE KATHLEEN M
DAVID C HAVERTY
222-224 WHITE ST
BELMONT, MA 02478

Parcel ID: 15-116-1
DONATI DIANE
139 BARTLETT AVE UNIT 1
BELMONT, MA 02478

Parcel ID: 15-116-2
FETTER TE SYBIL B
RONALD A FETTER
139 BARTLETT AVE 2
BELMONT, MA 02478

Parcel ID: 15-118
FENTON TRS BARRY W AND
27-29 KING STREET
13 FREEDOM TRAIL
NORFOLK, MA 02056

Parcel ID: 15-120
ROMNEOS TRS KOSTAS AND
5 JONATHAN STREET
3-5 JONATHAN ST
BELMONT, MA 02178

Parcel ID: 15-121
OCONNOR TE KRISTOF L &
AND ROSEMARY A JENSENTH
114 BARTLETT AVE
BELMONT, MA 02478

Parcel ID: 15-122
HUM TE KIN MO
MAY KAM HUM
116 BARTLETT AVE
BELMONT, MA 02478

Parcel ID: 15-123
KOSTANTINIDIS JAYNE
122 BARTLETT AVE
BELMONT, MA 02478

Parcel ID: 15-124
ODONOGHUE TR JOHN W JR
GIACOMO REALTY TRUST
44 CRESCENT AVE
SCITUATE, MA 02066

Parcel ID: 15-125
AMIRKHANI TRS HAMAYAK H
HAMYAK H AMIRKHANI
132 BARTLETT AVE
BELMONT, MA 02478

Parcel ID: 15-126
CONLEY TE WILLIAM H JR
ELLEN E CONLEY
134 BARTLETT AVE
BELMONT, MA 02478

Parcel ID: 15-127
BOHN JT KRISTEN B
BENJAMIN J MILLER
230 WHITE ST
BELMONT, MA 02478

Parcel ID: 15-137
LOSIER JT MICHAEL &
BRIAN LOSIER TC
11 FLINTLOCK RD
LEXINGTON, MA 02420

Parcel ID: 15-138
PAVLAN LINDA J
P O BOX 339
BELMONT, MA 02478

Parcel ID: 15-139
PERRY JOANNE
17 JONATHAN ST
BELMONT, MA 02178

Parcel ID: 15-140
BOYAJIAN TRS RONALD S &
13-15 JONATHAN STREET
15 JONATHAN ST
BELMONT, MA 02478

Parcel ID: 15-141
GIANOUKOS TR MARINA
THE GIANOUKOS REALTY
569 BELMONT ST
BELMONT, MA 02478

Parcel ID: 15-98
PAGLIOCCA TR ANTHONY C
ANTHONY C PAGLIOCCA
314 PAYSON RD
BELMONT, MA 02478

Parcel ID: 15-99
METTS LE SANDRA C
117 BARTLETT AVE
BELMONT, MA 02478



OFFICE OF COMMUNITY DEVELOPMENT

MEMO

MEMO TO: Traffic Advisory Committee

FROM: Glenn R. Clancy, P.E.

SUBJECT: Proposed Parking Restriction – Concord Avenue at Memorial Library

DATE: June 6, 2017

The Traffic Advisory Committee has received a request from the Belmont Memorial Library to have certain parking spaces near the library restricted so as to prevent all day parking and thereby allow more spaces to be available for the library, area businesses and Underwood Pool patrons. Please see the attached e-mail message from Mark Carthy, Library Trustee.

There is a delicate balance of commuter, employee and patron parking in and around Belmont Center. There are several businesses in the area and it is not known whether their employees are using some of the spaces along Concord Avenue for parking. I have invited the business owners to attend a discussion on the evening of June 15, 2017. It is possible some of the commuters are Belmont residents who live too far away to walk to the bus and train. I will have Community Development staff place flyers on the windshields of these cars with the information on the June 15 meeting.

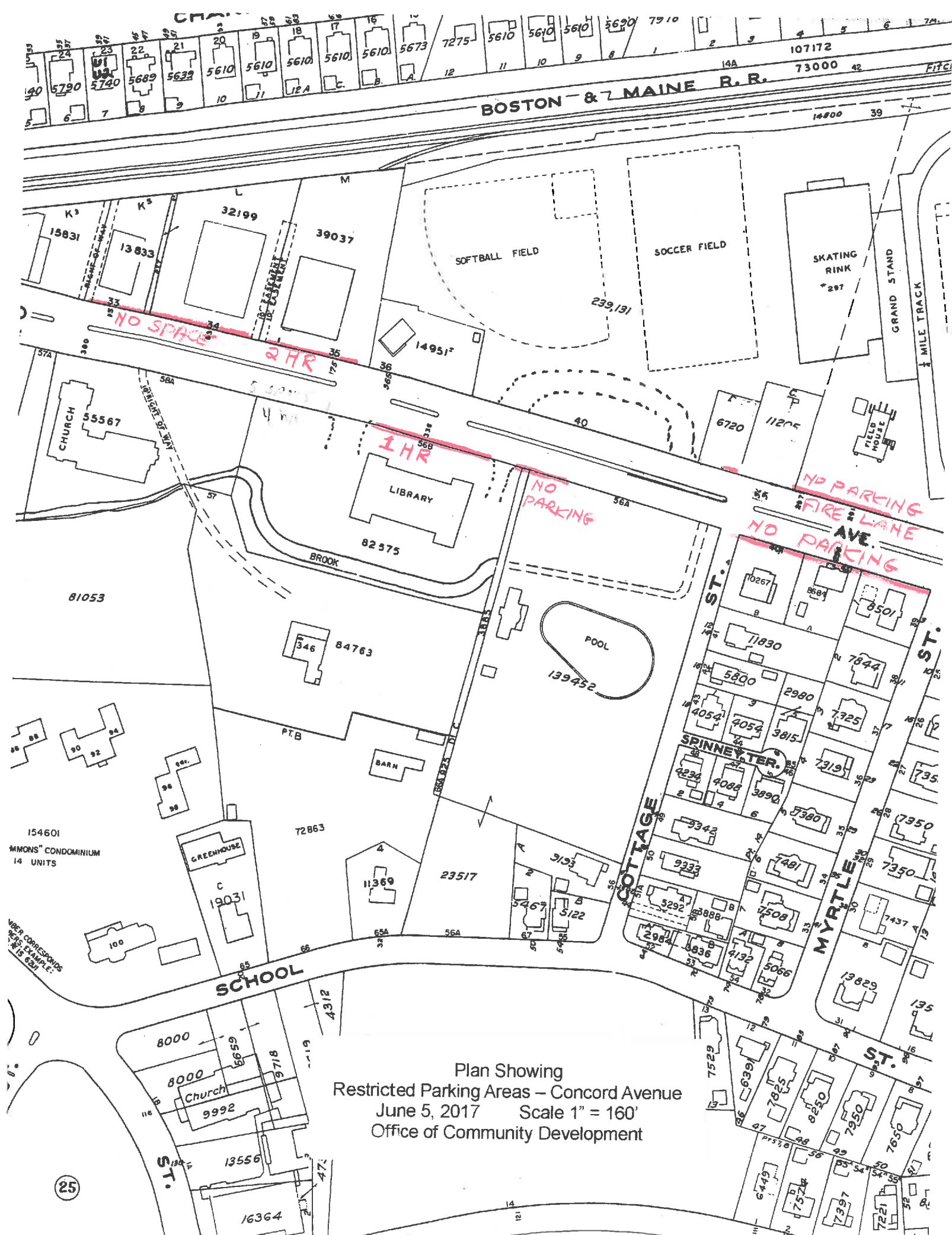

Clancy, Glenn

From: Mark Carthy <mpcarthy@outlook.com>
Sent: Thursday, May 04, 2017 9:23 AM
To: Selectmens Mailbox
Cc: Carman, Floyd; Fred Paulsen; Struzziero, Peter; Wheeler, Jeffrey; Clancy, Glenn
Subject: Commuter Parking along Concord Ave

I am writing to you to ask if you could help with a parking problem along Concord Ave.

In particular I am asking about the area along Concord Ave near the library and across the street from the library.

We have a problem with commuters using the spots all day for "free" commuter parking.

This is a problem for the library, pool and local businesses.

We already have 1hr parking signs immediately outside the library - and this seems to be working vs commuters. By 8am this morning I could see the 1hr area empty and the spots on either side without parking time limits already full.

I dont know if a 1hr limitation is the answer everywhere. You might consider a longer time limit (say 2 to 4hrs) - just so long as it prevents commuters taking these spots away from Belmont citizens regular activities.

Thanks,

Mark

Belmont TMM Precinct 1
Library Trustee

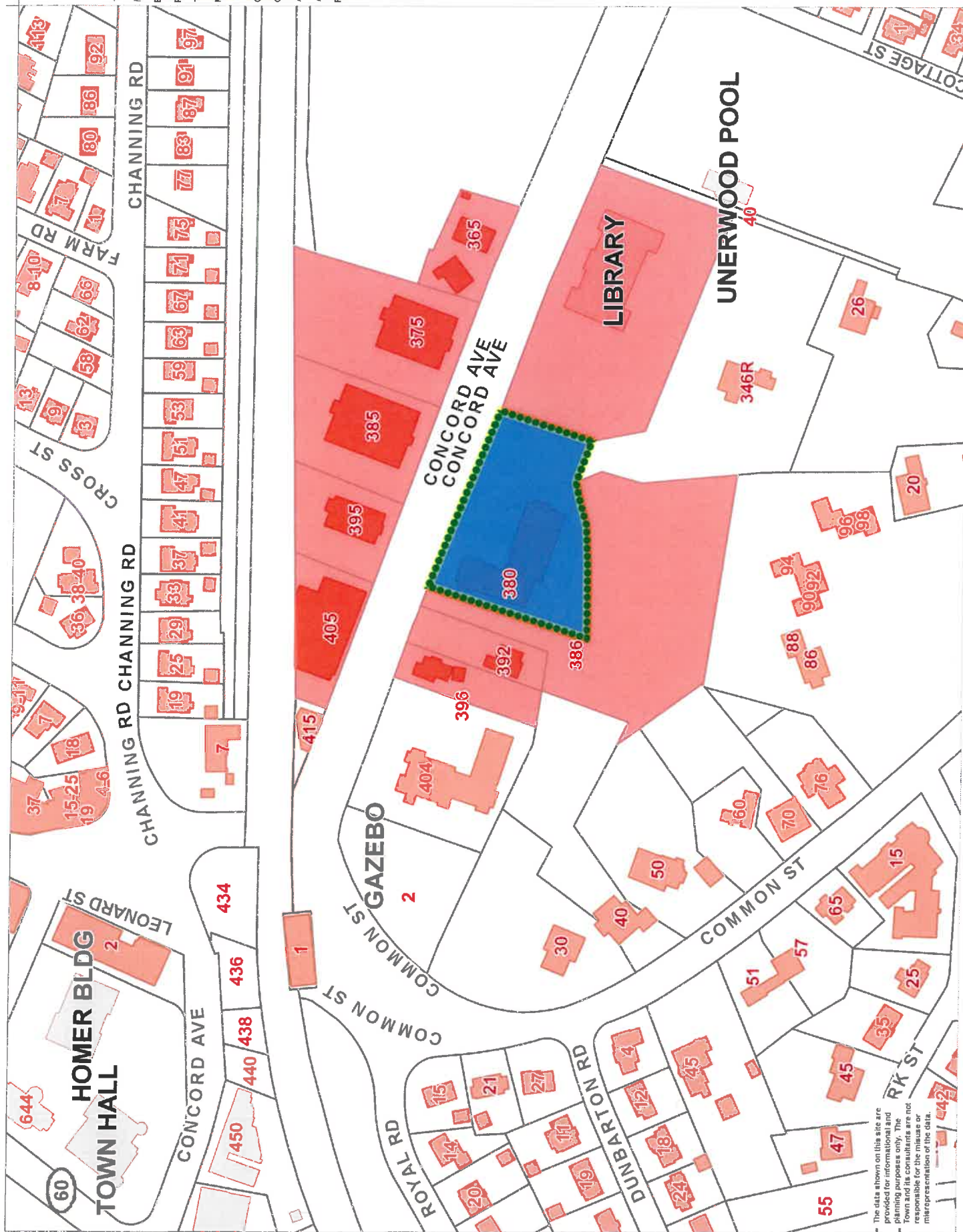
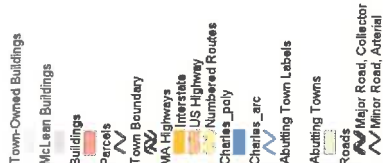

Parcel ID: 24-58-A
FIRST ARMENIAN CHURCH
380 CONCORD AVE
BELMONT, MA 02478

Parcel ID: 24-56-B
BELMONT INHABITANTS OF
BELMONT PUBLIC LIBRARY
455 CONCORD AVE
BELMONT, MA 02478

Parcel ID: 24-57-A
UNDERWOOD ESTATES LLC
38 LEXINGTON ST SUITE F
BELMONT, MA 02478

Parcel ID: 24-58
FIRST ARMENIAN CHURCH
392 CONCORD AVE
BELMONT, MA 02478

Parcel ID: 24-58-Z
FIRST ARMENIAN CHURCH
380 CONCORD AVE
BELMONT, MA 02478

Parcel ID: 24-59
FIRST CHURCH IN BELMONT
396 CONCORD AVE
BELMONT, MA 02478

Parcel ID: 35-31
BULL REALTY LLC TR 405
C/O BULFINCH CO FIRST
250 FIRST AVE STE 200
NEEDHAM, MA 02494

Parcel ID: 35-33
NATIONAL ASSOCIATION OF
395 CONCORD AVE
BELMONT, MA 02478

Parcel ID: 35-34
TELLIER TR JOSEPH G
385 CONCORD AVENUE
PO BOX 127
BELMONT, MA 02478

Parcel ID: 35-35
TELLIER TR JOSEPH G
375 CONCORD AVENUE
PO BOX 127
BELMONT, MA 02478

Parcel ID: 35-36
CARSTAIRS REALTY LLC
800 PLEASANT STREET
BELMONT, MA 02478



OFFICE OF COMMUNITY DEVELOPMENT

MEMO

MEMO TO: Board of Selectmen

FROM: Glenn R. Clancy, P.E.

SUBJECT: Proposed Parking Restriction – Concord Avenue at Memorial Library

DATE: July 25, 2017

The Traffic Advisory Committee received a request from the Belmont Memorial Library to have certain parking spaces near the library restricted so as to prevent all day parking and thereby allow more spaces to be available for the library, area businesses and Underwood Pool patrons.

The committee held a public meeting June 15, 2017. All abutters in the area of Concord Avenue near the library were invited to attend. Tenants in the office buildings on Concord Avenue were also invited to attend.

After hearing comments from those in attendance and weighing the impact of replacing all day parking spaces with time restricted spaces, the committee voted to approve 4 hour parking for the 5-6 spaces located along Concord Avenue just before the entrance driveway to the library. The spaces will be located between an existing utility pole and a fire hydrant.

The committee respectfully requests approval from the Board of Selectmen.



Plan Showing
 Restricted Parking Area – Concord Avenue
 July 24, 2017 Scale 1" = 160'
 Office of Community Development



OFFICE OF COMMUNITY DEVELOPMENT

MEMO

MEMO TO: Traffic Advisory Committee

FROM: Glenn R. Clancy, P.E.

SUBJECT: Burbank School – Proposed Parking Restrictions on Sharpe Road

DATE: June 7, 2017

I recently attended a meeting at the Burbank Elementary School with Principal Tricia Clifford and representatives from the Burbank PTA Safe Routes to School Committee. Given anticipated increases in student enrollment and busing across town, Principal Clifford would like to establish a better system for school buses. We discussed proposed parking restrictions on Sharpe Road to accommodate an adjusted school bus route that will relieve traffic and safety problems on School Street.

This coming summer several improvements will be made along School Street to improve pedestrian safety. Improvements include enhanced crosswalk signage, enhanced school zone warning signs, raised speed tables, and new granite curbing and concrete sidewalks. These improvements will prevent parents from parking and dropping off students on School Street, making it safer for students walking to the school and crossing on School Street. As an added measure of safety, school buses will discharge/pick up students at the turn-in located on Sharpe Road, instead of stopping on School Street across from the front of the school.

In order for this plan to work buses must access Sharpe Road from Washington Street. As you know, the road can become quite narrow when both sides are used for parking and there is a turn on Sharpe Road just before school property. Parking must be restricted to ensure unimpeded access for buses. Currently parking is partially restricted only along a portion of 39 Sharpe Road, the inside of the curve.

The committee is being asked to consider the following:

- Restrict parking on the odd side of Sharpe Road, Monday thru Friday, 8 am to 9am and 1 pm to 3 pm.
- Restrict parking on both sides of the curve along the entire frontage of 39 Sharpe Road and along 36, and 42 Sharpe Road Monday thru Friday, 8am and 3 pm.
- Change the signage currently posted at the curve and in the turn-in to "No Parking 8 am to 3 pm: School Bus Access Only".

Sharpe Road residents have been invited to attend the June 15th TAC meeting.

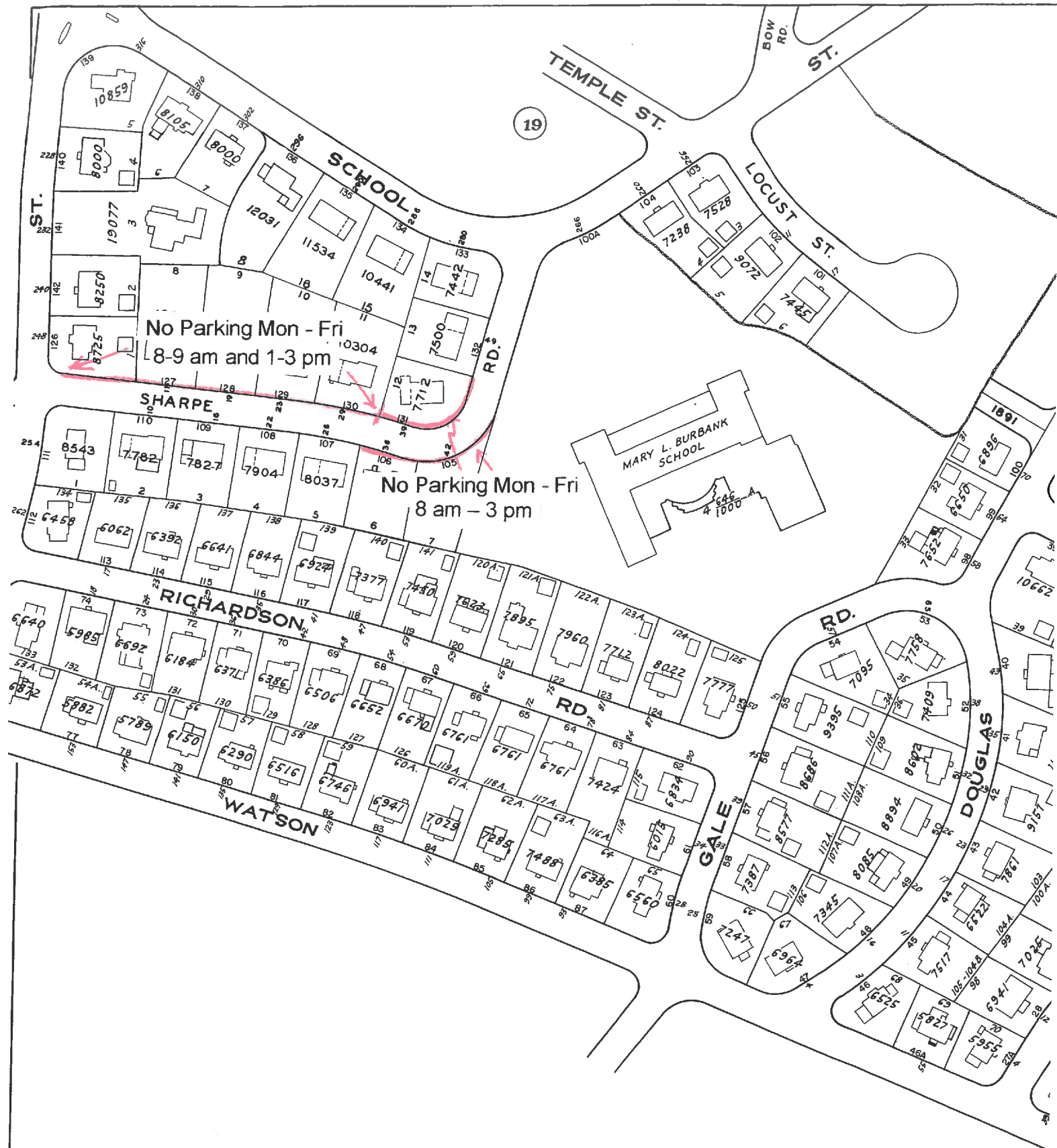

Plan Showing
Restricted Parking Area – Sharpe Road
June 5, 2017 Scale 1" = 160'
Office of Community Development

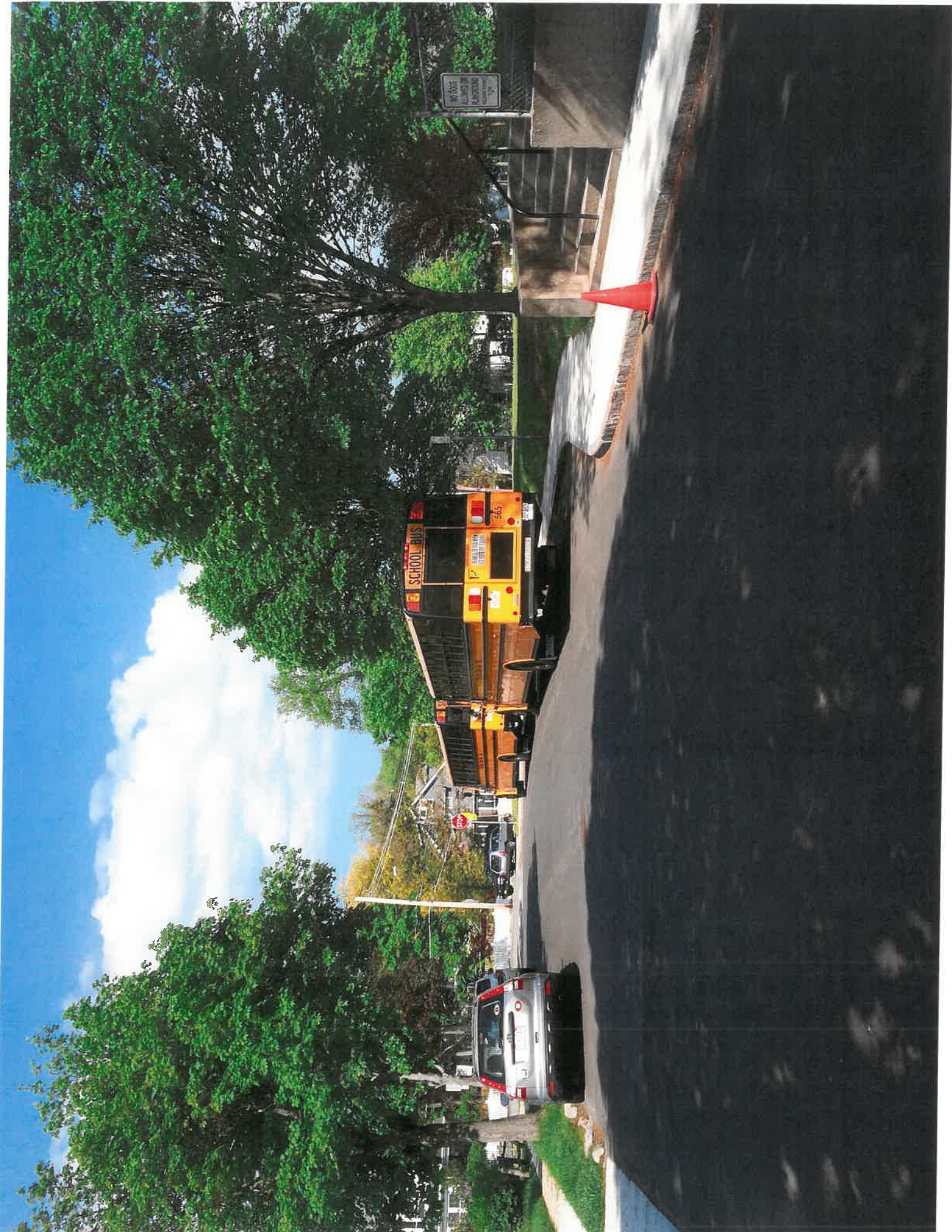



- Town-Owned Buildings
- McLean Buildings
- Buildings
- Parcels
- Town Boundary
- MA Highways
- Interstate
- US Highway
- Numbered Routes
- Charles_poly
- Charles_arc
- Abutting Town Labels
- Abutting Towns
- Roads
- Major Road, Collector
- Minor Road, Arterial

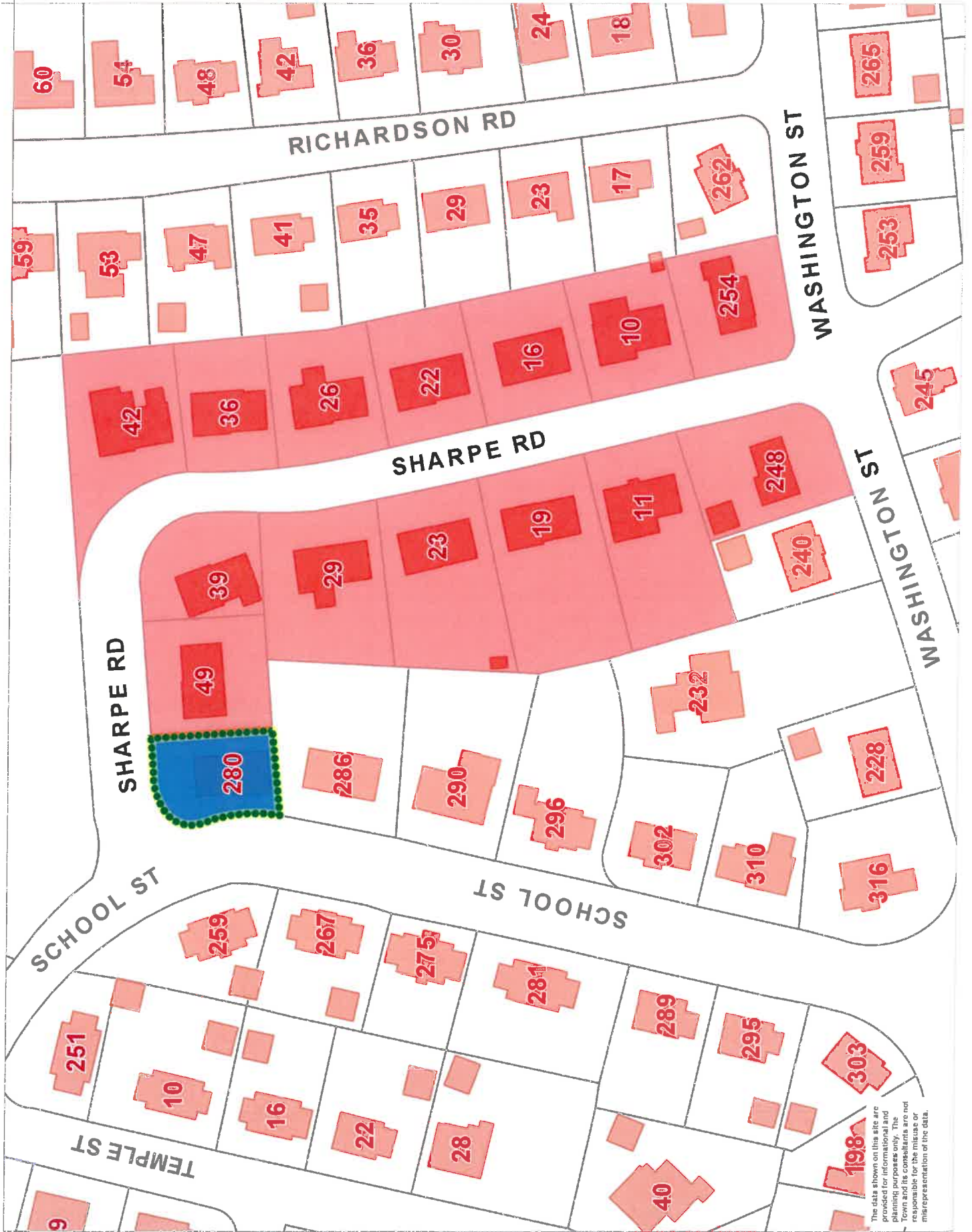

The data shown on this site are provided for informational and planning purposes only. The town and its constituents are not responsible for the misuse or misrepresentation of the data.

Parcel ID: 20-133
MOKRASCH JT SALLY C
LISA NEVILLE
280 SCHOOL ST
BELMONT, MA 02478

Parcel ID: 20-105
LOUKAS TE VICTOR
MAUEEN LOUKAS
42 SHARPE RD
BELMONT, MA 02478

Parcel ID: 20-106
BUTT TE CHARLES S
CAROLYN J MEHAFFEY
36 SHARPE RD
BELMONT, MA 02478

Parcel ID: 20-107
BOGHOSIAN JR TRS PAUL T
PAUL T BOGHOSIAN JR
26 SHARPE RD
BELMONT, MA 02178

Parcel ID: 20-108
ATTIAS TE CHRISTOPHE
FAUSTINE DELHAY
22 SHARPE RD
BELMONT, MA 02478

Parcel ID: 20-109
FAY TE ERNEST E
NANCY T FAY
16 SHARPE RD
BELMONT, MA 02478

Parcel ID: 20-110
FLETT TR CLAUDIA S
CLAUDIA S FLETT FAMILY
10 SHARPE RD
BELMONT, MA 02478

Parcel ID: 20-111
CAHALY TE RICHARD F JR
PAMELA SASS CAHALY
254 WASHINGTON ST
BELMONT, MA 02478

Parcel ID: 20-126
BERGOUDIAN TRS MARY A
MARY A BERGOUDIAN
248 WASHINGTON ST
BELMONT, MA 02478

Parcel ID: 20-127
HAUSMAN TE JESSICA
NICHOLAS B HAUSMAN
11 SHARPE RD
BELMONT, MA 02478

Parcel ID: 20-128
HUGHES JOHN R JR
19 SHARPE RD
BELMONT, MA 02478

Parcel ID: 20-129
SMITH TE PHILLIP J
ANNE M SMITH
23 SHARPE RD
BELMONT, MA 02478

Parcel ID: 20-130
KATOS TE DEMETRIOS
CHRISTINA KATOS
29 SHARPE ROAD
BELMONT, MA 02478

Parcel ID: 20-131
HONG TE YILI
JIE LI
39 SHARPE RD
BELMONT, MA 02478

Parcel ID: 20-132
ZENG TRS YAN & HUILI ZHAI
ZENG FAMILY 2015
49 SHARPE RD
BELMONT, MA 02478



OFFICE OF COMMUNITY DEVELOPMENT

MEMO

MEMO TO: Board of Selectmen

FROM: Glenn R. Clancy, P.E.

SUBJECT: Burbank School – Proposed Parking Restrictions on Sharpe Road

DATE: July 24, 2017

The Traffic Advisory Committee received a request from Burbank Elementary School Principal Tricia Clifford and representatives from the Burbank PTA Safe Routes to School Committee for additional parking restrictions on Sharpe Road to accommodate an adjusted school bus route that will relieve traffic and safety problems on School Street.

This summer several improvements are being made along School Street to improve pedestrian safety. These improvements will prevent parents from parking and dropping off students on School Street, making it safer for students walking to the school and crossing on School Street. As an added measure of safety, school buses will discharge/pick up students at the turn-in located on Sharpe Road, instead of stopping on School Street across from the front of the school.

In order for this plan to work buses must access Sharpe Road from Washington Street. Sharpe Road can become quite narrow when both sides are used for parking. Parking must be restricted to ensure unimpeded access for buses. Currently parking is partially restricted only along one side of the curved portion of Sharpe Road.

Sharpe Road residents were invited to attend the June 15th TAC meeting. After hearing comments the committee is requesting approval for the following:

- Restrict parking on the odd side of Sharpe Road, Monday thru Friday, 8 am to 9am and 1 pm to 3 pm.
- Restrict parking on the odd side of the curve along the entire frontage of 39 Sharpe Road Monday thru Friday, 8am and 3 pm.
- Restrict parking on the even side of the curve along the entire frontage of 42 Sharpe Road Monday thru Friday, 8 am to 9am and 1 pm to 3 pm.
- Change the signage currently posted at the bus in the turn-in to " School Bus Access Only No Parking 8 am to 3 pm"

The committee respectfully requests approval from the Board of Selectmen.

NO PARKING
8 AM - 3 PM
MON - FRI

TEMPLE ST.

BOW RD.
ST.

LOCUST ST.

NO PARKING
BUS ACCESS ONLY
MON - FRI 8 AM - 3 PM

No Parking Mon - Fri
8-9 am and 1-3 pm

No Parking Mon - Fri
8-9 AM AND
1-3 PM

MARY L. BURBANK
SCHOOL

RICHARDSON

WATSON

GALE

DOUGLAS



Plan Showing
Restricted Parking Area - Sharpe Road
June 5, 2017 Scale 1" = 160'
Office of Community Development