

PROPOSED LANDSCAPE LAYOUT - ELEVATION VIEW
SCALE: 1 inch = 20 feet

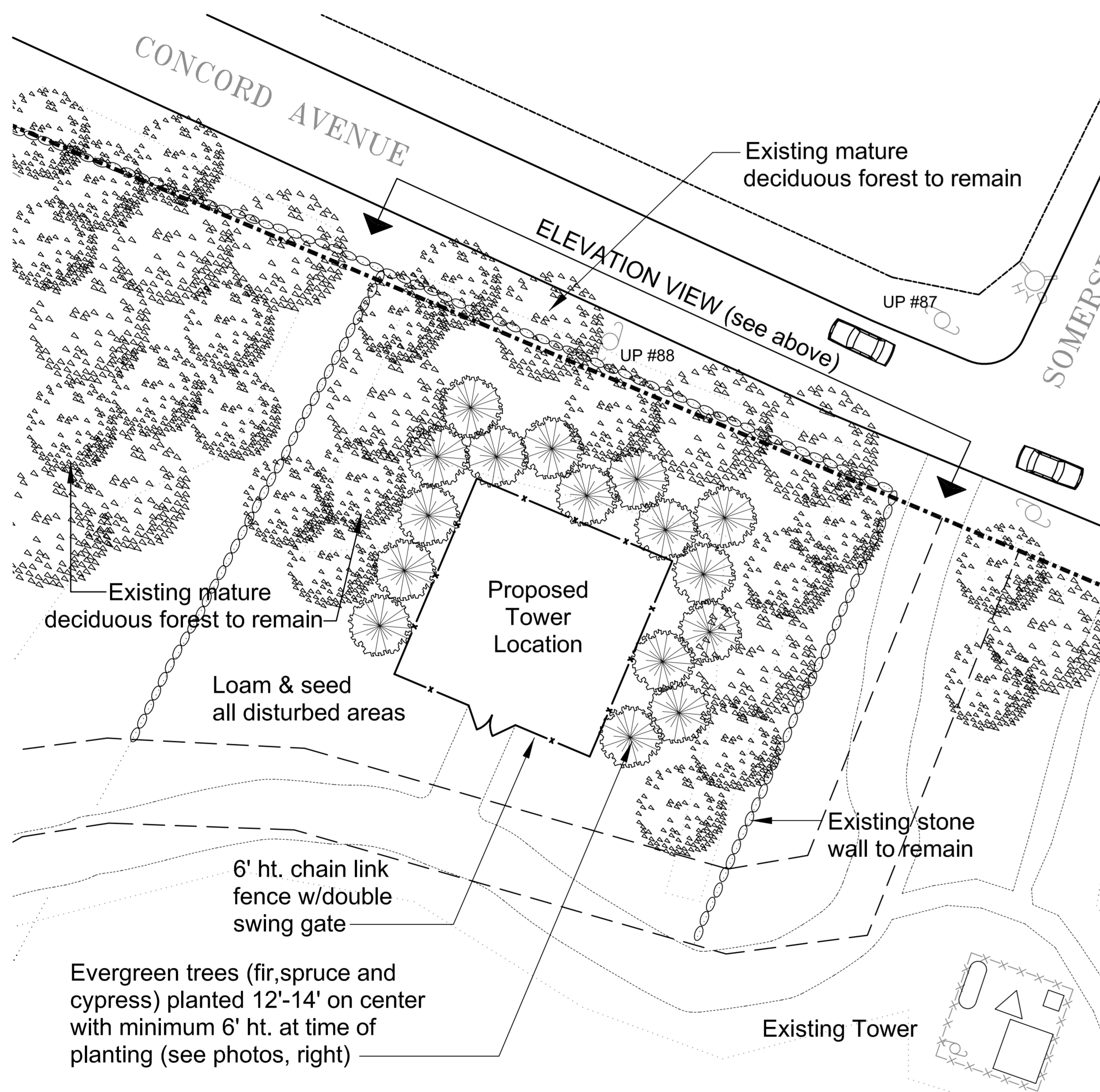

PROPOSED LANDSCAPE LAYOUT - PLAN VIEW
SCALE: 1 inch = 20 feet

PROJECT WIDE PLANT LIST (If discrepancy exists between Plan and Plant List, Plan shall govern)						
TREES	QUANTITY	KEY	SCIENTIFIC NAME	COMMON NAME	SIZE	COMMENTS
	x	AC	ABIES CONCOLOR	WHITE FIR	6-7 ht.	B&B
	x	CL	CUPRESSOCYPARIS LEYLANDI	LEYLAND CYPRESS	6-7 ht.	B&B
	x	PO	PICEA OMORIKA	SERBIAN SPRUCE	6-7 ht.	B&B



CONCOLOR FIR
30' to 50' tall and 15' to 20' wide



LEYLAND CYPRESS
Fast growing, conical tree to 60' tall



SERBIAN SPRUCE
50' to 60' tall and 20' to 25' wide

PLANTING NOTES

1. PLANT MATERIAL SHALL BE FURNISHED AND INSTALLED AS INDICATED; INCLUDING ALL LABOR, MATERIALS, PLANTS, EQUIPMENT, INCIDENTALS, AND CLEAN-UP.
2. THE CONTRACTOR SHALL BE RESPONSIBLE FOR PLANTING AT CORRECT GRADES AND ALIGNMENT. LAYOUT TO BE APPROVED BY OWNERS REPRESENTATIVE PRIOR TO INSTALLATION.
3. PLANTS SHALL BE TYPICAL OF THEIR SPECIES AND VARIETY; HAVE NORMAL GROWTH HABITS; WELL DEVELOPED BRANCHES, DENSELY FOLIATED, VIGOROUS ROOT SYSTEMS AND BE FREE FROM DEFECTS AND INJURIES.
4. CONTRACTOR SHALL REPORT ANY SOIL OR DRAINAGE CONDITIONS CONSIDERED DETRIMENTAL TO THE GROWTH OF PLANT MATERIAL.
5. ALL PLANT MATERIAL SHALL BE GUARANTEED BY THE CONTRACTOR TO BE IN VIGOROUS GROWING CONDITION. PROVISIONS SHALL BE MADE FOR A GROWTH GUARANTEE OF AT LEAST ONE YEAR FROM THE DATE OF ACCEPTANCE FOR TREES AND SHRUBS. REPLACEMENTS SHALL BE MADE AT THE BEGINNING OF THE FIRST SUCCEEDING PLANTING SEASON. ALL REPLACEMENTS SHALL HAVE A GUARANTEE EQUAL TO THAT STATED ABOVE.
6. IN SO FAR AS IT IS PRACTICABLE, PLANT MATERIAL SHALL BE PLANTED ON THE DAY OF DELIVERY. IN THE EVENT THIS IS NOT POSSIBLE, THE CONTRACTOR SHALL PROTECT STOCK NOT PLANTED. PLANTS SHALL NOT REMAIN UNPLANTED FOR LONGER THAN A THREE DAY PERIOD AFTER DELIVERY. ANY PLANTS NOT INSTALLED DURING THIS PERIOD WILL BE REJECTED.
7. QUALITY AND SIZE OF PLANTS, SPREAD OF ROOTS, AND SIZE OF BALLS SHALL BE IN ACCORDANCE WITH ANSI 260 (REV. 1980) "AMERICAN STANDARD FOR NURSERY STOCK" AS PUBLISHED BY THE AMERICAN ASSOCIATION OF NURSERYMEN, INC.
8. ALL PLANTS SHALL BE PLANTED IN AMENDED TOP SOIL THAT IS THOROUGHLY WATERED AND TAMPED AS BACK FILLING PROGRESSES. PLANTING MIX TO BE AS SHOWN ON PLANTING DETAILS. LARGE PLANTING AREAS TO INCORPORATE FERTILIZER AND SOIL CONDITIONERS AS STATED IN PLANTING SPECIFICATIONS.
9. PLANTS SHALL NOT BE BOUND WITH WIRE OR ROPE AT ANY TIME SO AS TO DAMAGE THE BARK OR BREAK BRANCHES. PLANTS SHALL BE HANDLED FROM THE BOTTOM OF THE BALL ONLY.
10. PLANTING OPERATIONS SHALL BE PERFORMED DURING PERIODS WITHIN THE PLANTING SEASON WHEN WEATHER AND SOIL CONDITIONS ARE SUITABLE AND IN ACCORDANCE WITH ACCEPTED LOCAL PRACTICE. PLANTS SHALL NOT BE INSTALLED IN TOPSOIL THAT IS IN A MUDDY OR FROZEN CONDITION.
11. SET ALL PLANTS PLUMB AND STRAIGHT. SET AT SUCH LEVEL THAT A NORMAL OR NATURAL RELATIONSHIP TO THE CROWN OF THE PLANT WITH THE GROUND SURFACE WILL BE ESTABLISHED. LOCATE PLANT IN THE CENTER OF THE PIT.
12. ALL INJURED ROOTS SHALL BE PRUNED UTILIZING CLEAN, SHARP TOOLS TO MAKE CLEAN ENDS BEFORE PLANTING. IT IS ADVISABLE TO PRUNE APPROXIMATELY 1/3 OF THE GROWTH OF LARGE TREES (2" CALIPER AND OVER) BY THE REMOVAL OF SUPERFLUOUS BRANCHES, THOSE WHICH CROSS, THOSE WHICH RUN PARALLEL, ETC. MAIN LEADER OF TREES WILL NOT BE CUT BACK. LONG SIDE BRANCHES, HOWEVER, MUST BE SHORTENED.
13. EACH TREE SHALL BE PRUNED IN ACCORDANCE WITH STANDARD HORTICULTURAL PRACTICE TO PRESERVE NATURAL CHARACTER OF PLANT. PRUNING SHALL BE DONE WITH CLEAN, SHARP TOOLS.
14. ALL PLANTING BEDS SHALL BE MULCHED WITH 3" LAYER OF DOUBLE SHREDDED HARDWOOD BARK MULCH.
15. NEW PLANTING AREAS AND SOD SHALL BE ADEQUATELY IRRIGATED OR WATERED TO ESTABLISH THE PROPOSED PLANTS AND LAWN.
16. PRIOR TO THE ISSUANCE OF ANY CERTIFICATE OF OCCUPANCY, THE PROPOSED LANDSCAPE AS SHOWN ON THE APPROVED LANDSCAPE PLAN MUST BE INSTALLED, INSPECTED AND APPROVED BY THE CITY LANDSCAPE ARCHITECT. THE CITY ENGINEER AND LANDSCAPE ARCHITECT SHALL TAKE INTO ACCOUNT SEASONAL CONSIDERATIONS IN THIS REGARD AS FOLLOWS. THE PLANTING OF TREES, SHRUBS, VINES OR GROUND COVER AS REQUIRED BY OR ASSOCIATED WITH A SUBDIVISION OR SITE PLAN APPROVAL BY THE PLANNING BOARD OR ZONING BOARD OF APPEALS SHALL BE INSTALLED DURING THE FOLLOWING PLANTING SEASONS:

TYPE	DATES
TREES	3/15 TO 12/15
LAWN	3/15 TO 6/15
	9/15 TO 12/1
17. ALL DISTURBED AREAS TO BE TREATED WITH 4" TOP SOIL & SEEDING IN ACCORDANCE WITH PERMANENT STABILIZATION METHODS INDICATED ON SOIL EROSION SEDIMENT CONTROL SHEET.

LANDSCAPE ARCHITECT:
Diane C.

SOULE & ASSOCIATES, ASLA
Landscape Architecture Graphics Design
401.231.0736 DCSA@COX.NET

APPLICANT:



170 WESTMINSTER STREET
SUITE 701
PROVIDENCE, RI 02903
Tel. (401) 854-1850
Fax (401) 454-3131

CO-APPLICANT:



AT&T

AT&T WIRELESS SERVICES
400 BLUE HILL DRIVE-SUITE
100 WESTWOOD, MA 02090
TEL. (781) 407-4500



341 North Avenue
Wakefield, MA 01880
tel. (781) 245 6388
fax (781) 245 4010

e-mail eamon@aerialspectrum.com

SITE NUMBER:

MA-XXXXX

SITE NAME:

BELMONT

PERMIT DRAWINGS

A	1/06/04	FOR ZONING

PROFESSIONAL STAMP

DRAWN BY: DCS

CHECKED BY: ETK

SITE ADDRESS:

CONCORD AVE.
BELMONT, MA 02478

SHEET TITLE:

**LANDSCAPE PLAN
&
ELEVATION**

SHEET NUMBER:

C-X